

## MP100V2 电子管话筒放大器 TUBE MIC PREAMPLIFIER

用户手册

Owner's Manual

## GENERAL INTRODUCTION

MP100V2 is a tube microphone amplifier. its creative electronic circuit combines tube and FET functional to add the tonal versatility and catches detail sound quality. Via TRANS  $\infty$  TUBE knob to adjust the ratio between trans and tube which makes MP100V2 suitable for various mics. The high quality 12AX7B tube amplifies sound in a premium way which makes the output sound more clear and natural. Various knobs, alum and steel material make MP100V2 fashionable and durable.

## INTRODUCTION OF EACH BUTTON

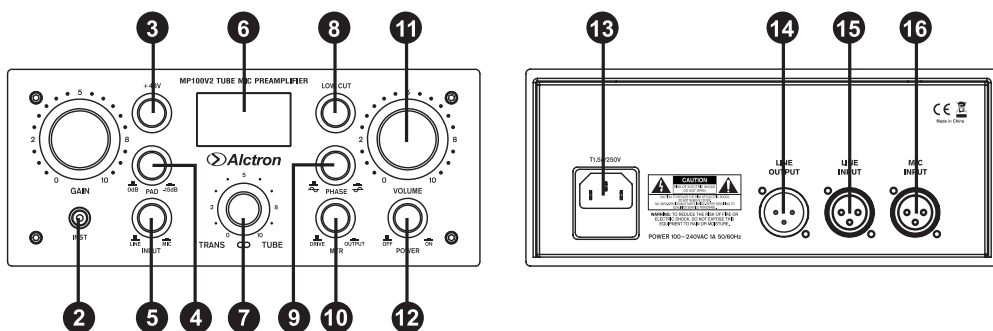

- 1.GAIN: adjust the gain of the input stage. Turn this knob clockwise raises the amount of gain applied to the input signal.
- 2.INST: high-Z input connect high impedance signal from an instrument such as electronic guitar or bass this unbalanced 1/4" jack connector. Do not press the INPUT knob.
- 3.+48V: most modern condenser mics requirement +48V phantom power to operate. When press the button, 48V phantom power delivered power to the rear panel MIC INPUT.
- 4.PAD: press the button MIC INPUT signal will be reduce by -15dB(This switch has no effect on LINE INPUT).
- 5.INPUT: press the button to choose MIC INPUT, no press to choose LINE INPUT.
- 6.METER: a standard UV meter that displays either the amount of output level or preamplifier overdrive depending upon the setting of the MTER function switch.
- 7.TRANS  $\infty$  TUBE: when fully switch the knob on the left position, you heard TRANS most; when fully switch the knob on the right position, you heard TUBE most. At the twelve o'clock position, only signal from both the solid state and tube with same ratio.
- 8.LOW CUT: when the input signal is 300hz, 160hz, 80hz and 50hz, this switch will cut 3dB signal. This normally used to eliminate rumble and other unwanted low frequencies from an incoming signal.
- 9.PHASE: with this switch the input signal is reversed in phase by 180°.
- 10.MTR: no press to display the input signal level, press the button to display output signal level.
- 11.VOLUME: this is the MP100V2's master volume control. It determines the amount of signal sent from the rear LINE OUTPUT.
- 12.POWER: turns the MP100V2 power on or off. When powered on, the front panel meter lights up.
- 13.T1.5A/250V: AC power connector, connect a standard, detachable IEC power cable (supplied) there.
- 14.LINE OUTPUT: a balanced output connector that carries the line-level output signal of the MP100V2.
- 15.LINE INPUT: input connector, connect a line-level input signal(coming from a device such as a mixer) into this balanced XLR connector.
- 16.MIC INPUT: input connector, connect to mic.

## CONNECTION

Take MIC INPUT as input connector.

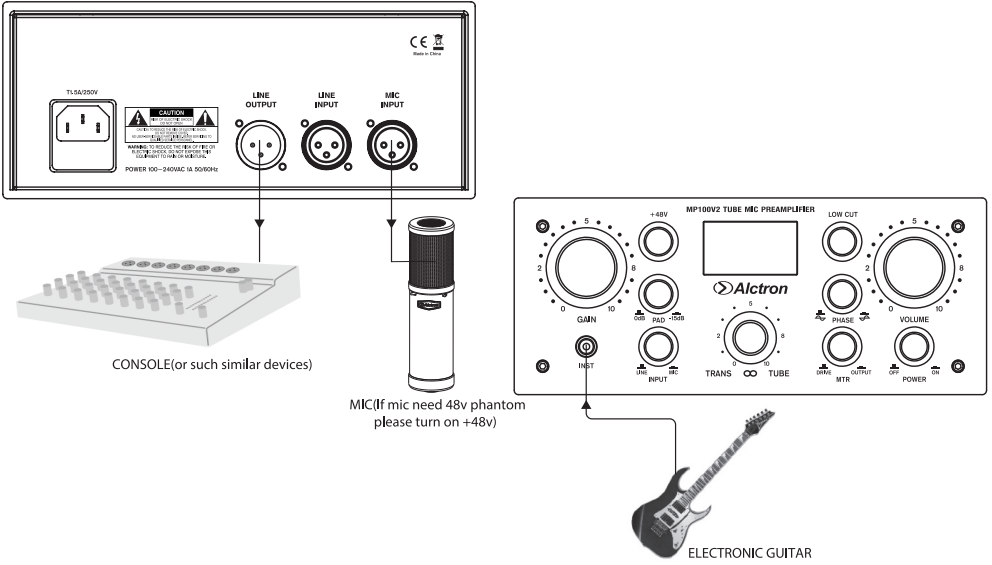

Take LINE INPUT as input connector.

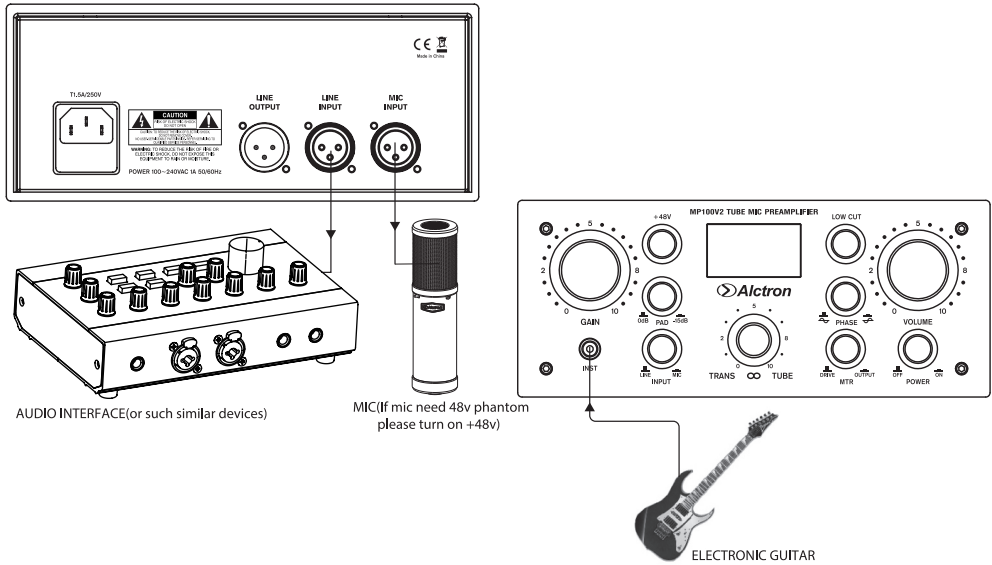

**NOTE: LINE INPUT and MIC INPUT you just can choose one input connector during performance.**

## SPECIFICATIONS

- \* Type: tube microphone preamp
- \* Input: XLR and 1/4" jack
- \* Output: XLR
- \* Tube complement: 12a x 7
- \* Pad: -15dB
- \* Max power consumption: 160mA @120V AC, 20W
- \* Power requirements: 100-240V AC
- \* Mic input impedance: 2K ohm
- \* Line input impedance: 10K ohm
- \* Hi-Z input impedance: 2.2M ohm
- \* Internal output impedance: 600 ohm
- \* Gain range: 70dBu
- \* Mic gain range: 10-60dBu
- \* Line gain range: -10-40dBu
- \* Hi-Z gain range: -10-40dBu
- \* Mic frequency response: 20hz-20khz
- \* Line frequency response: 20hz-20khz
- \* Hi-Z frequency response: 20hz-20khz
- \* Min THD + noise @+4dBu: 0.1% tube 0.005%

## SERVICE

### **If your Product needs servicing, follow these instructions.**

1. Ensure the problem is not related to operation error or external system devices.
2. Keep this owner's manual. We don't need it to repair the unit.
3. Pack the unit in its original packaging including end card and box. This is very important. If you have lost the packaging, please make sure you have packed the unit properly. ALCTRON is not responsible for any damage that occurs due to non-factory packing.
4. Ship to the ALCTRON tech support center or the local return authorization.

Copyright © Ningbo Alctron Electronics Technology CO.,LTD. All rights reserved. Specifications and appearance subject to change without notice.

Ningbo Alctron Electronics Technology CO.,LTD.  
No.76 SanCheng Road, XiuFeng Industrial Area,GaoQiao Town, NingBo, China.  
Tel:+0086 574 87150672  
Fax:+86 574 87157176  
E-mail:info@alctron-audio.com  
www.alctron-audio.com



## 产品简介

MP100V2是一款电子话筒放大器。创新型的电子线路设计同时结合了电子管和晶体管的特性，丰富了音色和声音的细节。通过TRANS ∞ TUBE旋钮调节电子管与晶体管之间的比率，从而能够适用于更多的话筒。高品质的12AX7B电子管对声音进行放大优化处理，让输出音质更加清晰自然。面板上多样的功能旋钮以及铁和铝的材质使得MP100V2看上去时尚耐用。

## 各个按钮的功能介绍

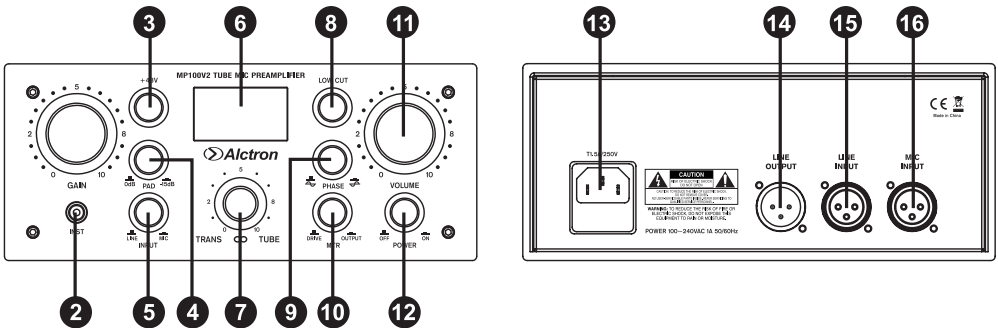

1. GAIN: 用于调节话筒输入的增益大小，建议在避免过载的情况下尽量调大，以获得良好的信噪比的声音细节。
2. INST: 高阻输入接口，连接高阻乐器，比如电吉他贝斯此类乐器。不要按下INPUT开关。
3. +48V: +48V幻象电源开关。按下此按钮，给后面板的MIC IN接口供电（当您使用电容话筒的时候请务必打开此开关）。
4. PAD: 按下此开关，MIC IN输入信号衰减15dB（此开关对LINE INPUT没有效果）。
5. INPUT: 按下选择MIC IN输入信号，不按则默认LINE INPUT输入信号。
6. METER: UV表，分别能显示输入电平和输出电平的大小。。
7. TRANS ∞ TUBE: 晶体管和电子管之间的混合比例。当开关位于左边的位置，更多听到的是晶体管的声音；当开关位于右边的位置，更多听到的是电子管的声音；当位于12点的位置时，听到的是两者混合比例一样的声音。
8. LOW CUT: 低切按钮能够在信号为300hz, 160hz, 80hz和50hz进行3dB的低频滚降，以避免不必要的低频噪音。
9. PHASE: 按下此开关，相位反转180°。
10. MTR: 按下次开关显示输出信号电平大小，不按显示输入信号电平大小。
11. VOLUME: MP100V2主音量控制旋钮。
12. POWER: 打开或者关闭MP100V2。
13. T1.5A/250V: 标准的IEC电源接口。
14. LINE OUTPUT: 线性平衡输出接口，连接调音台等带有线性输入的设备。
15. LINE INPUT: 线性平衡输入接口，连接声卡等带有线性输出接口的设备。
16. MIC INPUT: 话筒输入接口，连接话筒。

## 产品连接图

当MIC INPUT作为输入接口的时候

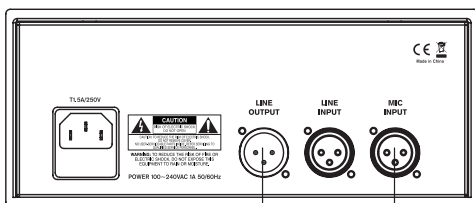

调音台(或相似产品)



话筒(如果话筒需要48V幻象电源请打开+48V开关)

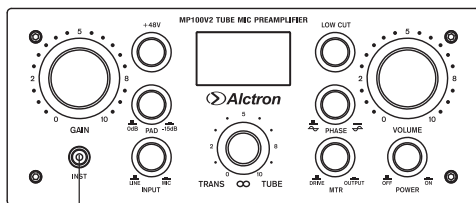

电吉他

当LINE INPUT作为输入接口的时候

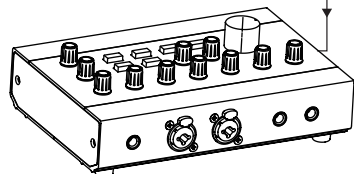
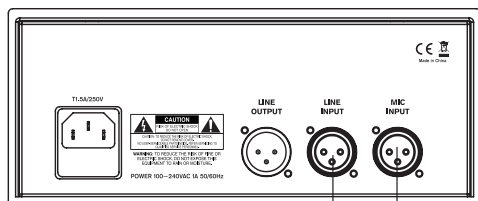

声卡(或相似产品)



话筒(如果话筒需要48V幻象电源请打开+48V开关)

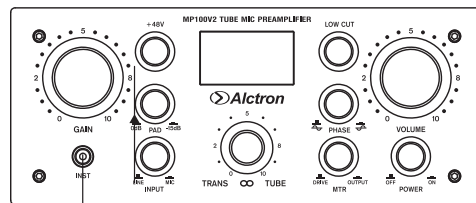

电吉他

**注意：LINE INPUT和MIC INPUT在使用过程中您只能选择其中之一作为输入接口。**

## 参 数

* 类型:	电子管麦克风放大器
* 输入:	XLR和1/4"夹克
* 输出:	XLR
* 电子管类型:	12a x 7
* 衰减:	-15dB
* 最大功率消耗:	160mA @120V AC, 20W
* 麦克输入阻抗:	2K ohm
* 线性输出阻抗:	10K ohm
* 高阻输入阻抗:	2. 2M ohm
* 输出阻抗:	600 ohm
* 增益:	70dBu
* 麦克增益范围:	10-60dBu
* 线性增益范围:	-10-40dBu
* 高阻增益范围:	-10-40dBu
* 最小失真度+噪音@+4dBu:	0. 1% 电子管 0. 005%

## 保 修

如果您的产品需要维修，请按照以下说明操作:

- 1.请确保不是因为操作不当或外部设备所造成。
2. 请保存好我们的说明书，返修的时候不必把说明书寄回给我们。
3. 返修的时候请用产品原来的包装箱来包装，这是非常重要的。如果你已丢失原包装，请确保您正确包装和保护好本产品。爱克创是不负责由于非原厂包装造成任何损害。
4. 运送到爱克创技术支持中心或当地的授权经销商。

版权所有©宁波奥创电子科技有限公司,所有权保留。必要的技术数据和外观更改恕不另行通知。

---

宁波奥创电子科技有限公司

地址：浙江省宁波市海曙区秀丰工业区三成路76号

电话：0574-88011699

传真：0574-87157176

邮箱：sales@alctron-audio.com

网址：<http://www.alctron-audio.com> 全国统一服务热线：4000-160-112