

102401M-VA-1 01/16

Blackstar[®]

AMPLIFICATION



FLY 3 BASS

Owner's Manual

Blackstar Amplification Ltd, Beckett House, 14 Billing Road, Northampton, NN1 5AW, UK
For the latest information go to: www.blackstaramps.com

Whilst the information contained herein is correct at the time of publication, due to our policy of constant improvement and development, Blackstar Amplification Ltd reserves the right to alter specifications without prior notice.

the sound in your head

IMPORTANT SAFETY INSTRUCTIONS

1. Read these instructions.
2. Keep these instructions.
3. Heed all warnings.
4. Follow all instructions.
5. Do not use this apparatus near water.
6. Clean only with dry cloth.
7. Install in accordance with the manufacturer's instructions.
8. Do not install near any heat sources such as radiators, heat registers, stoves, or other apparatus (including amplifiers) that produce heat.
9. Only use attachments/accessories specified by the manufacturer.
10. Unplug this apparatus during lightning storms or when unused for long periods of time.
11. Refer all servicing to qualified service personnel. Servicing is required when the apparatus has been damaged in any way, such as power-supply cord or plug is damaged, liquid has been spilled or objects have fallen into the apparatus, the apparatus has been exposed to rain or moisture, does not operate normally, or has been dropped.

“TO COMPLETELY DISCONNECT THIS APPARATUS FROM THE AC MAINS, DISCONNECT THE POWER SUPPLY CORD PLUG FROM THE AC RECEPTACLE”.

“WARNING: TO REDUCE THE RISK OF FIRE OR ELECTRIC SHOCK, DO NOT EXPOSE THIS APPARATUS TO RAIN OR MOISTURE. THE APPARATUS SHALL NOT BE EXPOSED TO DRIPPING OR SPLASHING AND THAT OBJECTS FILLED WITH LIQUIDS, SUCH AS VASES, SHALL NOT BE PLACED ON APPARATUS”.
This apparatus is for professional use only!

Warning!

Important safety information!

READ THE FOLLOWING INFORMATION CAREFULLY. SAVE ALL INSTRUCTIONS FOR FUTURE REFERENCE!

Follow all warnings and instructions marked on the product!

Do not open the equipment case. There are no user serviceable parts in this equipment. Refer all servicing to qualified service personnel.

Clean only with a dry cloth.

Condensation can form on the inside of an amplifier if it is moved from a cold environment to a warmer location. Before switching the unit on, it is recommended that the unit be allowed to reach room temperature.

Unauthorised modification of this equipment is expressly forbidden by Blackstar Amplification Ltd.

Never push objects of any kind into ventilation slots on the equipment casing.

Do not expose this apparatus to rain, liquids or moisture of any type.

Do not place this product on an unstable trolley, stand or table. The product may fall, causing serious damage to the product or to persons!

This product should not be placed near a source of heat such as a stove, radiator, or another heat producing amplifier.

Use only the supplied power cord which is compatible with the mains voltage supply in your area.

Power supply cords should always be handled carefully and should be replaced if damaged in any way.

Never break off the earth (ground) pin on the power supply cord.

The PSU-1 power supply cord should be unplugged when the unit is to be unused for long periods of time.

An apparatus with Class 1 construction should be connected to a mains socket outlet with a protective earthing connection.

The mains plug of the power supply cord should remain readily accessible.

A warning that batteries (battery pack or batteries installed) shall not be exposed to excessive heat such as sunshine, fire or the like.

Attention should be drawn to the environmental aspects of battery disposal.

Only use the approved Blackstar PSU-1 AC/DC power supply.

High headphone levels can cause permanent hearing damage. You should therefore avoid the direct vicinity of loudspeakers operating at high levels. Wear hearing protection if continuously exposed to high levels.

If the product does not operate normally when the operating instructions are followed, then refer the product to a qualified service engineer.

The U.S. Government's Occupational Safety and Health Administration (OSHA) has specified the following permissible noise level exposures:

Duration Per Day In Hours	Sound Level dBA, Slow Response
8	90
6	92
4	95
3	97
2	100
1½	102
1	105
½	110
¼ or less	115

According to OSHA, any exposure in excess of the above permissible limits could result in some hearing loss.



All electrical and electronic products should be disposed of separately from the municipal waste stream via designated collection facilities appointed by the government or the local authorities.



Introduction

Thank you for purchasing this Blackstar FLY Series amplifier.

The FLY 3 BASS is an innovative mini amp which packs all the great tones of Blackstar products into one compact, portable amplifier – perfect for practice when on the go. You can plug in your phone, MP3 player, laptop or tablet into the FLY 3 BASS and jam along to your favourite songs.

The FLY 103 BASS is a mini cabinet which, when connected to the FLY 3 BASS, creates a stereo sound for your guitar playing and music; a perfect combination for creating big sound and great tone whilst jamming, it also gives great output when used with other devices via the MP3 / LINE IN socket.

Like all Blackstar products, the FLY 3 BASS/FLY 103 BASS is the result of countless hours of painstaking research and development by our world-class design team; based in Northampton (UK), the Blackstar team are all experienced musicians themselves, and the sole aim of the development process when creating our products is to provide guitarists with ultimate tools for self-expression.

All Blackstar products are subjected to extensive laboratory and road testing to ensure that they are truly uncompromising in terms of quality, reliability and above all – TONE!

If you like what you hear and want to find out more about the Blackstar range of products, please visit our website at www.blackstaramps.com.

Thanks!

The Blackstar Team

Features

The FLY 3 BASS is a compact, innovative mini amp with big TONE. Combining two channels, a continuously variable mid-cut EQ and compressor, it's the perfect take-anywhere amp.

The MP3 / Line In jack allows you to connect your FLY 3 BASS to a music device and jam along to your favourite tunes; it's great as a speaker for your phone, tablet or PC / laptop.

A fully specified speaker emulated output allows you to get great tone to tape or disk, or through headphones.

Capable of being powered by batteries, you can take your FLY 3 BASS with you wherever you go and always get 'the sound in your head'!

Front Panel

1. Input

Plug your guitar in here. Always use a good quality screened guitar lead.

2. Gain

This control adjusts the amount of overdrive or distortion.

When the Clean Channel is selected, low settings counter clockwise (CCW), will deliver a clean sound. As the Gain control is increased clockwise (CW) the sound will move from clean into break-up, until at its maximum position, a full crunch tone is arrived at.

When the Overdrive Channel is selected, the Gain control adjusts the amount of overdrive or distortion. Low settings, counter clockwise, will deliver a clean sound on the edge of break-up. As the Gain control is increased CW the sound will become more overdriven moving through crunch tones until, at its maximum position, a full distorted lead tone is arrived at.

3. OD (Overdrive)

Press this switch to select the Overdrive Channel. When the switch is in the Overdrive Channel is selected. When the switch is out the Clean Channel is in operation.

4. Volume

This control allows you to adjust the depth of the EQ curve for the tonal response you prefer. Fully CCW is fairly flat with a slight mid range boost, whereas fully CW has a definite mid shape with a cut at around 400Hz. This depth of mid range cut is variable between the two extremes. This is a 'dual-gang' control meaning there are two sections: One controls the depth of the mid cut as described above and the other gradually adds in an overall gain boost. This means that as the control is adjusted from CCW to CW, the general nominal signal level remains about the same.

The user will find that the combination of the two channels and the EQ will result in many different tones being available.

5. COMP. (Compressor)

This control adjusts the compression ratio of the in-built compressor. With the control fully CCW the ratio will be 1:1, therefore effectively off. As the control is turned further to CW then the compression ratio is gradually increased. Compression is used to subtly smooth out the dynamic range of an audio signal, therefore softening the peaks and attack.

6. SUB

This is a small control that sets the level of a harmonic generator. This produces an additional low frequency tone that is mixed in with the normal signal. It gives the perception of increased low-end girth.

7. VOLUME

This controls the overall volume of all the bass sounds. Turning it clockwise increases the volume. Users may find that high settings of the COMP. control require a slightly higher setting of the VOLUME control to compensate for the effect of the compression circuit. This is the normal operation for a compressor and is otherwise known as 'make-up gain'.

8. MP3 / Line In

Connect the output of your MP3 or CD player here. Adjust the player's volume to match that of your guitar to enable you to play along.

Note: the connection is stereo.

9. Speaker Emulated Output & Headphones

This output emulates the tonal characteristics of a guitar speaker cabinet and provides a natural valve overdrive tone for connection to a recording device or mixing desk, and for use with headphones. To make full use of the stereo reverb, use a stereo jack to two mono jacks splitter lead to feed two channels of the recording device or mixer (see diagram below). The output will also function into a mono guitar type lead. Always use a good quality screened lead.

Note: when a lead is connected here the combo's internal speaker is disconnected.

10. Power

This switch is used to turn the FLY 3 BASS on and off; when using batteries, the FLY 3 BASS' power light will dim as the power in the batteries runs out.

11. Power Indicator Light

The power indicator will light when the amplifier is switched on.

Rear Panel

1. DC Input (PSU-1)

Connect external Power supply here

ONLY USE A BLACKSTAR APPROVED POWER SUPPLY (PSU-1)

6.5V 1.5A min.

2. Battery Compartment

Insert batteries here for portable use. We recommend using rechargeable (NiMH) or Alkaline batteries in your FLY 3 to get the most out of using it on the go.

6 x AA batteries (rechargeable).

3. FLY 103 BASS Extension Cabinet (Stereo Pack only)

Connect your FLY 3 BASS to the FLY 103 BASS using the FLY 103's built-in cable to create a 6W stereo set-up.

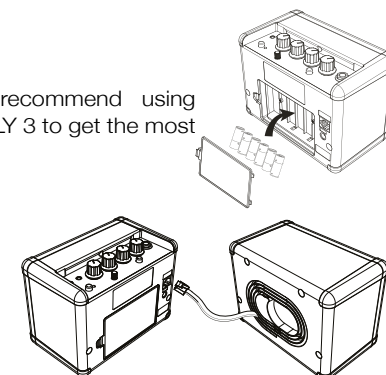

Technical Specification**FLY 3 BASS****Power (RMS):** 3 Watt**Weight (kg):****Dimensions (mm):****Batteries:** 6 x AA batteries**Speaker Size: 3"****FLY 103 BASS****Power (RMS):** 3 Watt**Weight (kg):****Dimensions (mm):****Speaker Size: 3"****Technische Daten****FLY 3 BASS****Leistung (RMS):** 3 Watt**Gewicht (kg):****Abmessungen (mm):****FLY 103 BASS****Leistung (RMS):** 3 Watt**Gewicht (kg):****Abmessungen (mm):****Caractéristiques Techniques****FLY 3 BASS****Puissance (RMS):** 3 Watt**Poids (kg):****Dimensions (mm):****FLY 103 BASS****Puissance (RMS):** 3 Watt**Poids (kg):****Dimensions (mm):****Especificaciones Técnicas****FLY 3 BASS****Potencia (RMS):** 3 Watio**Peso (kg):****Dimensiones (mm):****FLY 103 BASS****Potencia (RMS):** 3 Watio**Peso (kg):****Dimensiones (mm):**

Fly 3

出力:1ワット(RMS)

真空管:ECC83 x 1、ECC82 x 1

重量:約6kg

寸法:308(W) x 305(H) x 172(D)mm

真空管:ECC83 x 1、ECC82 x 1

重量:約6kg

寸法:308(W) x 305(H) x 172(D)mm

FLY 103 BASS

出力:1ワット(RMS)

技术指标**FLY 3 BASS**

电源 (RMS) : 3瓦

重量 (kg) :

体积 (mm) :

电池 : 6节5号电池

扬声器大小 : 3英寸

FLY 103 BASS

电源 (RMS) : 3瓦

重量 (kg) :

体积 (mm) :

扬声器大小:3英寸

