

ELECTRONIC KEYBOARD

Owner's Manual

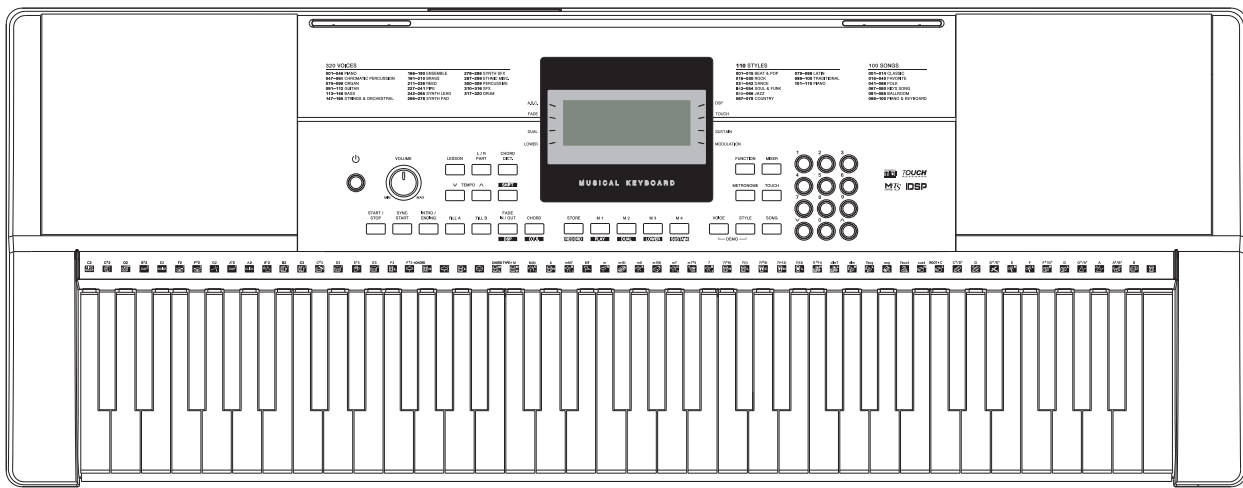

INFORMATION FOR YOUR SAFETY!

THE FCC REGULATION WARNING (for USA)

This equipment has been tested and found to comply with the limits for a Class B digital device, pursuant to Part 15 of the FCC Rules.

These limits are designed to provide reasonable protection against harmful interference in a residential installation. This equipment generates, uses, and can radiate radio frequency energy and, if not installed and used in accordance with the instructions, may cause harmful interference to radio communications. However, there is no guarantee that interference will not occur in a particular installation. If this equipment does cause harmful interference to radio or television reception, which can be determined by turning the equipment off and on, the user is encouraged to try to correct the interference by one or more of the following measures:

- Reorient or relocate the receiving antenna.
- Increase the separation between the equipment and receiver.
- Connect the equipment into an outlet on a circuit different from that to which the receiver is connected.
- Consult the dealer or an experienced radio/TV technician for help.

Unauthorized changes or modification to this system can void the user's authority to operate this equipment.

CAUTION

The normal function of the product may be disturbed by Strong Electro Magnetic Interference. If so, simply reset the product to resume normal operation by following the owner's manual. In case the function could not resume, please use the product in other location.

PRECAUTIONS

PLEASE READ CAREFULLY BEFORE PROCEEDING

Please keep this manual in a safe place for future reference.

Power Supply

Please connect the designated AC adaptor to an AC outlet of the correct voltage.

Do not connect it to an AC outlet of voltage other than that for which your instrument is intended.

Unplug the AC power adaptor when not using the instrument, or during electrical storms.

Connections

Before connecting the instrument to other devices, turn off the power to all units. This will help prevent malfunction and / or damage to other devices.

Location

Do not expose the instrument to the following conditions to avoid deformation, discoloration, or more serious damage:

- Direct sunlight
- Extreme temperature or humidity
- Excessive dusty or dirty location
- Strong vibrations or shocks
- Close to magnetic fields

Interference with other electrical devices

Radios and televisions placed nearby may experience reception interference. Operate this unit at a suitable distance from radios and televisions.

Cleaning

Clean only with a soft, dry cloth. Do not use paint thinners, solvents, cleaning fluids, or chemical-impregnated wiping cloths.

Handling

Do not apply excessive force to the switches or controls.

Do not let paper, metallic, or other objects into the instrument. If this happens, unplug the AC adaptor from the wall outlet. Then have the instrument inspected by qualified service personnel.

Disconnect all cables before moving the instrument.

Contents

Panel & Display Description

| | |
|------------------|---|
| Front Panel..... | 4 |
| Rear Panel..... | 4 |
| Display..... | 5 |

Setup

| | |
|-------------------|---|
| Power Supply..... | 6 |
|-------------------|---|

Connections

| | |
|--------------------------------------|---|
| Connecting a Footswitch..... | 7 |
| Connecting a pair of Headphones..... | 7 |
| Connecting an Audio Equipment..... | 7 |
| Connecting a Computer..... | 7 |

| | |
|-------------------------------|----------|
| Playing the Demos..... | 8 |
|-------------------------------|----------|

Playing the Voices

| | |
|--|---|
| Playing Voices..... | 8 |
| Playing Two Voice Simultaneously-DUAL..... | 8 |
| Lower..... | 9 |
| Touch..... | 9 |
| Sustain..... | 9 |
| DSP Effect..... | 9 |

Auto Accompaniment

| | |
|------------------------------|----|
| Play Auto Accompaniment..... | 10 |
| Playing a Fill..... | 10 |
| Intro/Ending..... | 10 |
| Sync Start..... | 11 |
| Fade In/Out..... | 11 |
| Tempo..... | 11 |
| One Touch Setting..... | 11 |
| Auto Bass Chord..... | 12 |

Other Function

| | |
|--------------------|----|
| Function Menu..... | 13 |
| Mixer..... | 14 |

Memory

| | |
|-------------|----|
| Memory..... | 15 |
|-------------|----|

| | |
|------------------------------|-----------|
| Chord Dictionary..... | 15 |
|------------------------------|-----------|

Songs

| | |
|-----------------------------|----|
| Listening to the Songs..... | 16 |
| Lesson Mode..... | 16 |

| | |
|----------------------------|-----------|
| Song Recording..... | 17 |
|----------------------------|-----------|

MIDI Functions

| | |
|---------------------|----|
| What's MIDI?..... | 18 |
| MIDI Terminals..... | 18 |

| | |
|------------------------------|-----------|
| Trouble Shooting..... | 19 |
|------------------------------|-----------|

| | |
|----------------------------|-----------|
| Specifications..... | 19 |
|----------------------------|-----------|

Appendices

| | |
|--------------------------------|----|
| Voice List..... | 20 |
| Style List..... | 22 |
| Song List..... | 23 |
| MIDI Implementation Chart..... | 24 |

Panel & Display Description

Front Panel

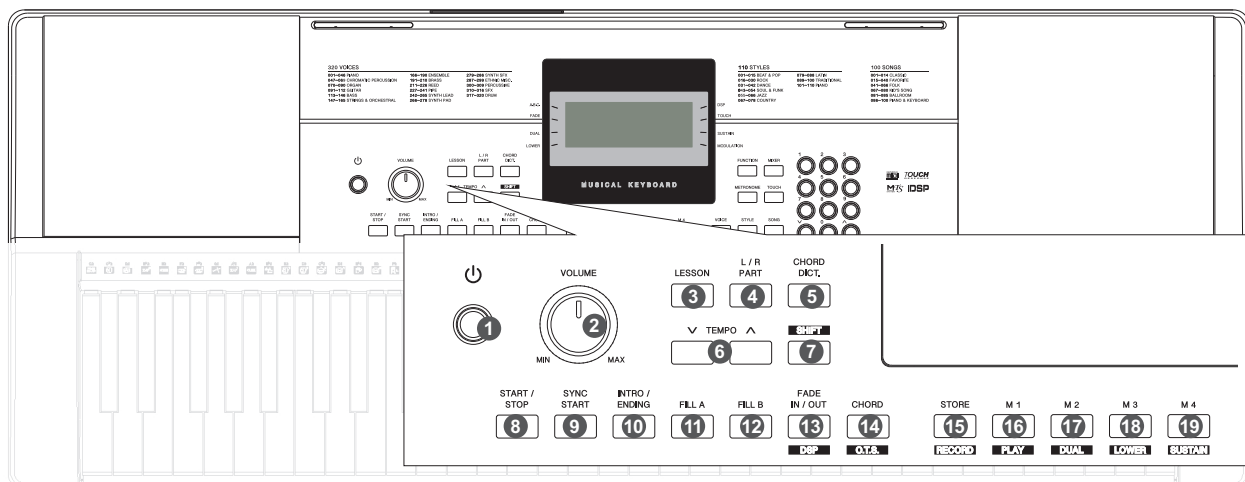

1. POWER ON/OFF

Turn the power on or off.

2. MASTER VOLUME

Adjust the master volume.

3. LESSON

Enter the Lesson Mode.

4. L/R PART

Select the left / right-hand part in Lesson Mode.

5. CHORD DICT.

Enter the Chord Dictionary.

6. TEMPO + / -

Change the current tempo.

7. SHIFT

Press and hold it to access secondary functions of other buttons.

8. START/STOP

Start or stop playing the song in Song Mode.
Start or stop playing the style in Style Mode.

When the [SHIFT] button is released

13. FADE IN/OUT

Turn the Fade In or Fade Out on.

14. CHORD

Enter the chord mode.

15. STORE

Register the current panel settings.

16~19. M1-M4

Recall the memory settings.

9. SYNC START

Turn the SYNC START on or off.

10. INTRO / ENDING

Play the Intro or Ending.

11. FILL A

Play the fill-in pattern A.

12. FILL B

Play the fill-in pattern B.

When the [SHIFT] button is pressed

13. DSP

Turn the DSP effect on and off.

14. O.T.S.

Enter the One Touch Setting Mode.

15. RECORD

Start or stop real-time recording.

16. PLAY

Play back the recorded user song.

17. DUAL

Turn the DUAL voice on or off.

18. LOWER

Turn the LOWER voice on or off.

19. SUSTAIN

Turn the Sustain effect on or off.

Rear Panel

28. USB

Connect to a computer.

29. SUSTAIN

Connect a sustain pedal.

30. PHONE

Connect a pair of headphones.

31. DC IN

Connect DC IN power adaptor (optional).

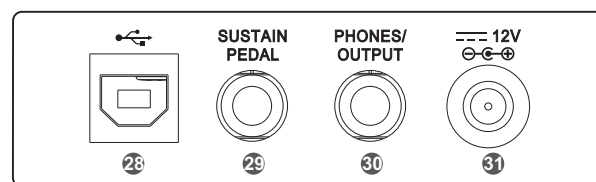

Panel & Display Description

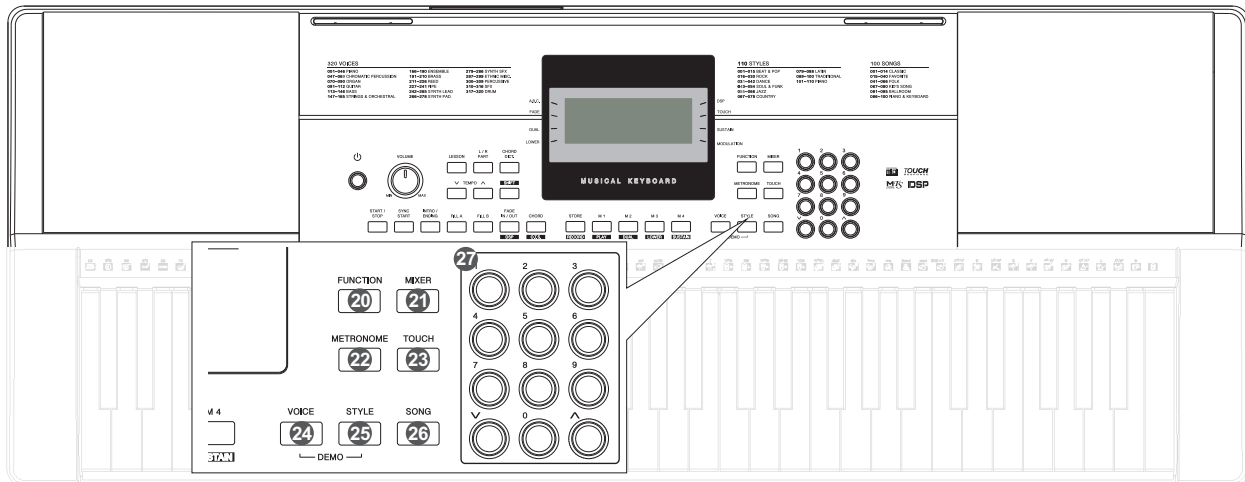

20. FUNCTION

Enter the Function Menu.

21. MIXER

Enter the Mixer Menu.

22. METRONOME

Turn the metronome on and off.

23. TOUCH

Turn the Touch response on and off.

24. VOICE

Enter the Voice Mode.

25. STYLE

Enter the Style Mode.

DEMO

Press VOICE and STYLE buttons simultaneously will start the DEMO playback.

26. SONG

Enter the Song Mode.

27. +, -, NUMBER KEYS

Select the number or set parameters value.

Display

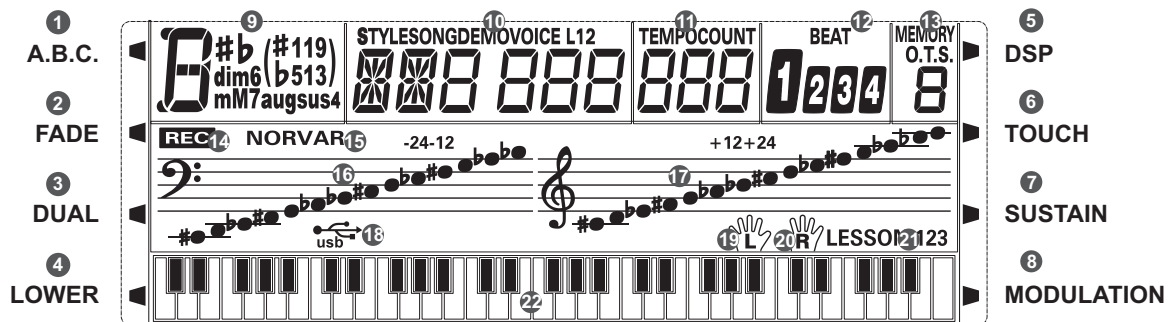

1. A.B.C.

2. FADE

3. DUAL

4. LOWER

5. DSP

6. TOUCH

7. SUSTAIN

8. MODULATION

9. CHORD

10. VOICE/STYLE/DEMO/SONG

11. TEMPO/COUNT

12. BEAT

13. STROE M1-M4/

ONE TOUCH SETTING

14. RECORD

15. NOR/VAR

16. BASS CLEF

17. TREBLE CLEF

18. USB CABLE

19. LEFT

20. RIGHT

21. LESSON 1/2/3

22. 61-KEY KEYBOARD

Setup

This section contains information about setting up your instrument and preparing to play. Please go through this section carefully before turning the power on.

Power Supply

You can power the unit either by batteries or by power adaptor. Follow the instructions described below.

Using Batteries

6 pieces of AA size (SUM-3 or Lr6) or equivalent alkaline batteries must first be installed into the battery compartment.

1. Open the battery compartment cover located on the bottom of the instrument.
2. Insert the batteries, carefully follow the polarity markings on the cabinet.
3. Replace the compartment cover, make sure it locks firmly in place.

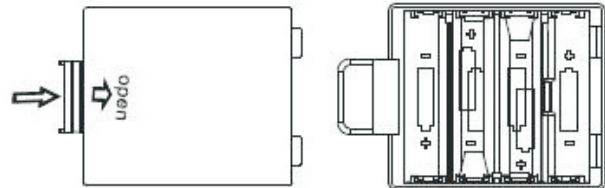

SUM-3, LR6, "AA" SIZE OR EQUIV.

Caution:

Do not mix used and new batteries.
Always use same types of batteries.
Always remove the batteries from the unit when it is not used for an extended period of time.

Using Power Adapter

1. First, please make sure that POWER ON/OFF switch of the instrument is set to OFF.
2. Connect the AC adaptor to the power supply jack.
3. Plug the AC adaptor into an AC outlet. This will automatically cut off the battery power supply.
4. Turn on the instrument.

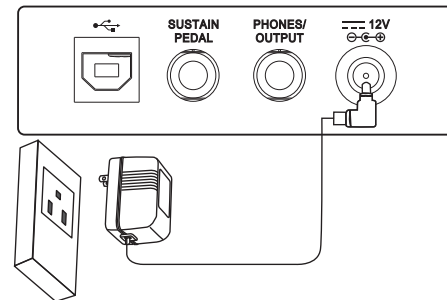

Note:

When the keyboard is not in use or in the time of thunderstorm, please disconnect the power for safety purpose.

The instrument will automatically shut down in about 30 minutes if it is not used.

Connections

Connecting a Footswitch

An optional footswitch can be plugged into the sustain jack and be used to switch sustain on or off. Simply by pressing a sustain footswitch, you will have a natural sustain as you play.

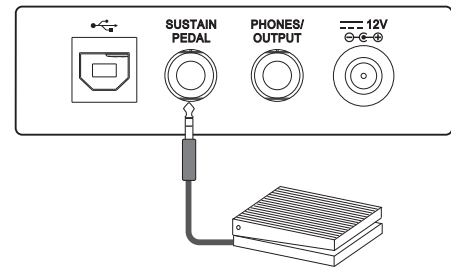

Connecting a pair of Headphones

A standard pair of stereo headphones can be connected to the PHONES jack for private practice or late-night playing. The internal stereo speaker system is automatically shut off when a pair of headphones is plugged into this jack.

Note:

Do not listen with the headphones at high volume for long periods of time. Doing so may cause hearing loss.

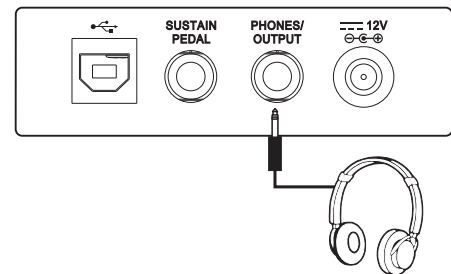

Connecting an Audio Equipment

The PHONES jack can be also connected with an audio equipment, such as an amplifier, mixer, recorder, etc.

Note:

To avoid damaging the speakers, make sure the volume has been set to the minimum level before connecting the power and other devices.

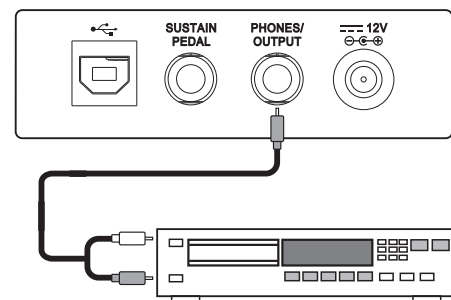

Connecting a Computer

Use a USB cable to connect the instrument to a computer. The instrument receives and transmits MIDI messages via the USB connector.

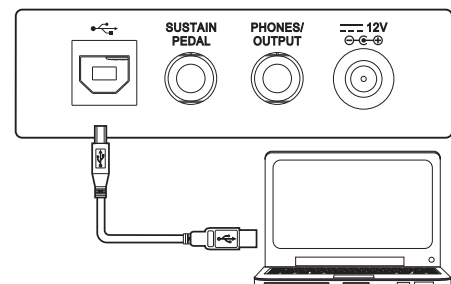

| |
|-----|
| 100 |
| 95 |
| 75 |
| 25 |
| 5 |
| 0 |

Playing the Demos

The instrument features 100 demo songs.

1. Press the [STYLE] and [VOICE] buttons simultaneously to start playing the demo.
2. Select a demo song.
Use the data dial, the number keys, the [+] button or the [-] button to select the desired demo song.
3. Adjust the volume with the [VOLUME] knob.
4. Press the [STYLE] and [VOICE] buttons simultaneously again or press the [START/STOP] button to stop playing and exit the demo mode.

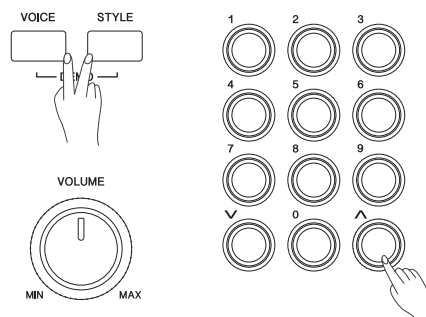

Note:

In the DEMO mode, all buttons except START/STOP, TEMPO+, TEMPO-, +, -, DSP, VOLUME, POWER ON/OFF will not be available.

Playing Voices

The keyboard has 320 remarkably realistic built-in voices, including Piano, Woodwind, Saxophone, Drum Kits and many more. Please refer to **Voice List**.

Playing Voices

1. Press the [VOICE] button.
Enter the VOICE mode. LCD shows "VOICE 1", the voice number.
2. Select a voice.
Use the number keys, the [+] button or the [-] button to select the voice you want to play.
3. Play the voice.
Play the keyboard and enjoy the wonderful voice.

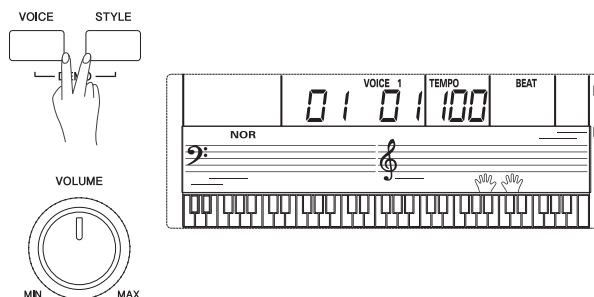

Note:

When both Voice 1 and Voice 2 are on, you can press the [VOICE] button to shift between the two voices.

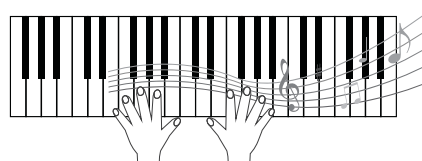

Playing Two Voice Simultaneously-DUAL

1. Holding down the [SHIFT] button and press the [DUAL] button to turn the function on. LCD shows "VOICE 2" and the dual voice number.



Playing the Voices

2. Selecting a voice for VOICE 2.
Use the data dial, the number keys, the [+] button or the [-] button to select the desired dual voice.
3. Play the voices.
You will hear two different voices layered together, just like two instruments playing at the same time.

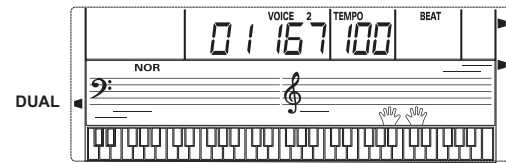

Lower

The lower function splits the keyboard into the left and the right hand areas, each with a different voice. The left hand voice is the lower voice "VOICE L".

The default split point is #F3.

1. Holding down the [SHIFT] button and press the [LOWER] button to turn on the LOWER VOICE, LCD lights the LOWER VOICE icon and displays "VOICE L" and its number.
When you play in real time, you can activate Split Mode simply by pressing this button.
2. Press [+] / [-] button, or numeric button to select the voice you want.

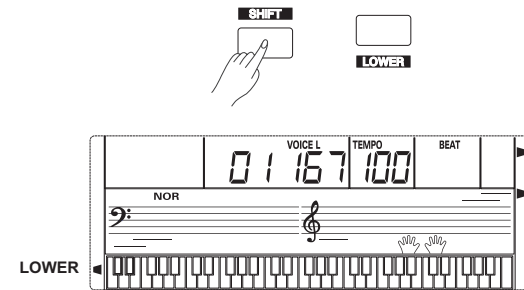

Touch

The keyboard is equipped with a touch response feature that lets you dynamically and expressively controls the level of the voice with your playing strength - just as on an acoustic instrument. Press the [TOUCH] button to adjust touch parameter: OFF, 1, 2, 3. Press [+] and [-] buttons simultaneously to restore its default value.

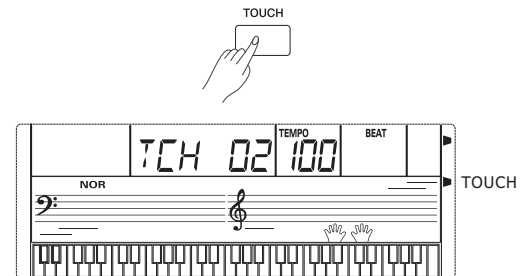

Sustain

When the Sustain feature is ON, all notes played on the keyboard would have a longer sustain. Holding down the [SHIFT] button and then press the [SUSTAIN] button to turn the SUSTAIN effect ON or OFF.

Note:

When you step on the "sustain pedal", the sustain effect is stronger than the effect by pressing the [SUSTAIN] button.

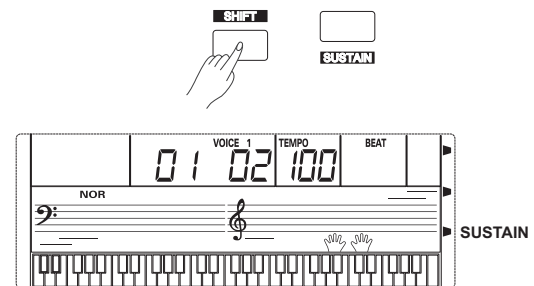

DSP Effect

The DSP simulates sounds in the real environment. With the DSP effect, you can add ambiance and depth to your performance. The DSP effect is set to ON when you turn on the instrument. Holding down the [SHIFT] button and then press the [DSP] button to turn on or off the DSP effect.

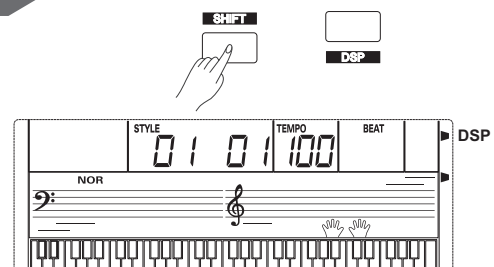

100
95
75
25
5
0

Auto Accompaniment

The instrument features 110 styles of different musical genres. Try selecting some of the different styles (Refer to **Style List**) and play with the auto accompaniment.

Play Auto Accompaniment

1. Press the [STYLE] button.

Enter the STYLE mode. LCD shows "STYLE", the style number.

2. Use the number keys, the [+] button, the [-] button to select the style you want to play.

3. Press the [START/STOP] button to start the rhythm tracks of the auto accompaniment.

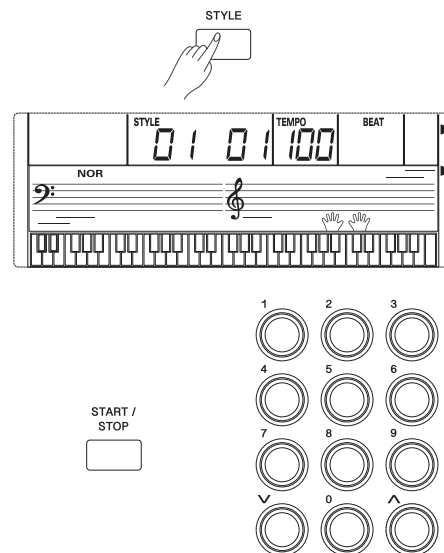

Playing a Fill

Auto fill in function automatically adds a fill to your performance. When the fill-in is finished, accompaniment shifts to the Main section (A,B).

Note:

Hold down the FILL-IN A/B button when the style is playing, the selected FILL pattern repeats continuously until button is released. Press FILL-IN A/B when style stop, it will change to the normal section.



Intro/Ending

The intro is an opening section of the song. Each preset style features two different patterns. When the intro pattern finished, the system will automatically shift to the main section. Ending is used for the ending of the song. When the ending is finished, accompaniment automatically stops. The length of the ending differs depending on the selected style.

1. Press the [STYLE] button.
2. Select a style
3. Turn the Chord Mode on.
4. Turn SYNCHRONIZED START on.
5. Press the [INTRO/ENDING], the "VAR" flashes on LCD, the style is ready to play.
6. It will start the accompaniment as soon as you start playing in Chord section. When the playback of the intro is finished, it automatically leads into main A or B section.
7. Press the [INTRO/ENDING] again will lead it into the ending section. When the ending is finished, the auto accompaniment automatically stops.

Note:

Press [FILL A] or [FILL B] before the ending finished will lead it into main A or main B section.

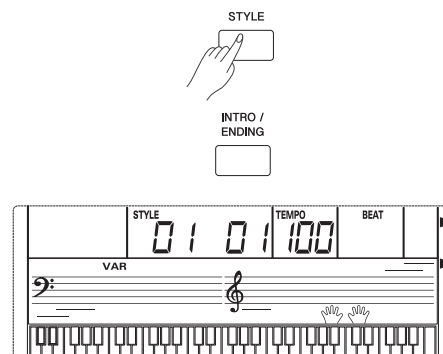

Auto Accompaniment

Sync Start

While the style stops, press the [SYNC] button. The black dots below the tempo and the metronome flash, indicating the style is ready to play.

1. If the Chord Mode is OFF, pressing any key will automatically begins to play the style (rhythm track).
2. If the Chord Mode is ON, pressing any key in the left-hand range of the keyboard will automatically begins to play the style (all tracks).

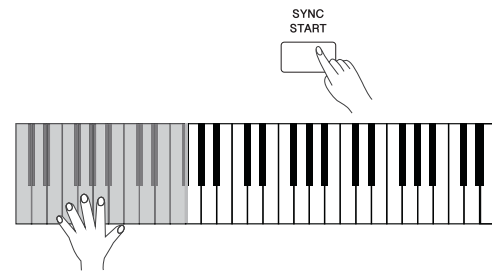

Fade In/Out

Fade In

Starting the style with fade in produces a smooth beginning, the volume increases from low to high. Press the [FADE] button when Style is stopped, the fade indicator will light up on LCD. Now press [START/STOP] button to start the style playback, the fade indicator will flash. The Accompaniment Volume will change from 0 to the set value in about 8 seconds. The keyboard volume will change from 0 to default value at the same time.

Fade Out

Stopping the style with fade out produces a smooth ending, the volume decreases from high to low. Press the [FADE IN/OUT] button during Style playing. The fade indicator will flash. The Accompaniment Volume will decrease to 0 in about 8 seconds, and the style stops. The keyboard volume will change from default value to 0 at the same time.

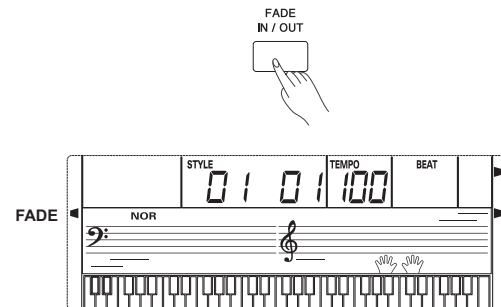

Tempo

Each style of the instrument has been programmed with a default tempo; however, this can be changed by using the [TEMPO+] or [TEMPO-] buttons.

1. Use the [TEMPO+] or [TEMPO-] button to change the tempo. The value ranges from 30 to 280.
2. Hold down the [TEMPO] buttons can change the tempo quickly. While the tempo is flashing on LCD, you can also use the data dial to change the tempo quickly.
3. Press the [TEMPO+] or [TEMPO-] buttons simultaneously to restore the default tempo setting.

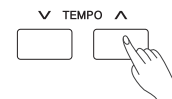

One Touch Setting

When One Touch Setting is switched on, you can instantly recall all auto accompaniment related settings including voices selection and digital effects simply with a single touch of a button.

1. Holding down the [SHIFT] button and then press the [O.T.S.] button to turn on the One Touch Setting for current style. LCD show O.T.S. 1.
2. Press one of the [ONE TOUCH SETTING] buttons [M1]-[M4]. Voice match the selected style can be instantly recalled.
3. Chord Mode is automatically turned on during O.T.S. mode.
4. Holding down the [SHIFT] button and then press the [O.T.S.] button again to quit One Touch Setting mode, "O.T.S." disappears.

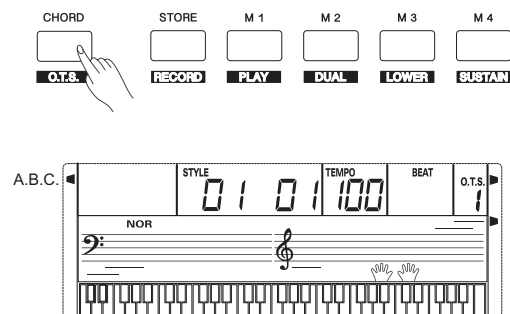

Auto Accompaniment

Auto Bass Chord

1. When the [CHORD] is switched on, the chords you played in the specified Chord section of the keyboard will be automatically detected and will be used to control the playback of the selected style.
2. Press the accompaniment keys, the corresponding chord will display on LCD.
3. Split Point Set
The default split key is F#3(19), Turn to "Function Menu" page for more detail. The split point key and the other keys on the left of it are accompaniment keys.

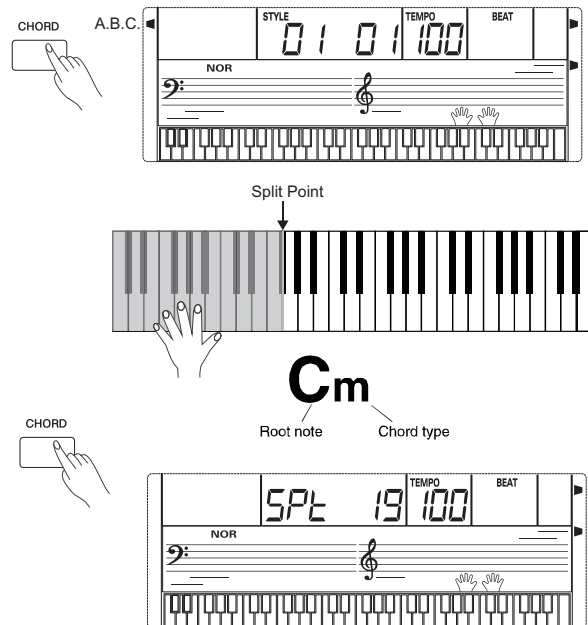

SINGLE FINGER

Single finger type not only can detect single finger but also can detect multi finger. And the single finger makes it easily to play chords through only one, two or three keys. Including major, minor, seventh, and minor seventh chord. Refer to relevant picture on the right for details.

MULTI FINGER

Multi finger type only can recognize those chords have listed in the chord list, and also can be found in the dictionary function.

| | | |
|------------|--|---|
| C | | ★ Major Triad Only press the root note on the keyboard. |
| Cm | | ★ Minor Triad Press the root note and the nearest left black key simultaneously. |
| C7 | | ★ Seventh chord Press the root note and the nearest left white key simultaneously. |
| Cm7 | | ★ Minor seventh chord Press the root note and the nearest left white and black keys simultaneously. |

| | | | | | |
|---|---|--|---|--|--|
| 0 C | 1 C ₆ | 2 CM ₇ | 3 CM ₇ (#11) | 4 CM(9) | 5 CM ₇ (⁹) |
| 6 C ₆ (⁹) | 7 Caug | 8 Cm | 9 Cm ₆ | 10 Cm ₇ | 11 Cm ₇ (^{b5}) |
| 12 Cm(⁹) | 13 Cm ₇ (⁹) | 14 Cm ₇ (¹¹) | 15 CmM ₇ | 16 CmM ₇ (⁹) | 17 Cdim |
| 18 Cdim ₇ | 19 C ₇ | 20 C ₇ sus ₄ | 21 C ₇ (^{b5}) | 22 C ₇ (⁹) | 23 C ₇ (#11) |
| 24 C ₇ (¹³) | 25 C ₇ (^{b9}) | 26 C ₇ (^{b13}) | 27 C ₇ (# ⁹) | 28 CM ₇ aug | 29 C ₇ aug |
| 30 Csus ₄ | 31 C1+2+5 | Notes enclosed in parentheses@are optional; the chords could be recognized without them. | | | |

Other Function

Function Menu

Press [FUNCTION] button to enter the function menu. The default option of the menu is "Transpose". When you enter the menu next time, it will display the same option of you last operation. Press [FUNCTION] button repeatedly to select an option. Use [+] / [-] button to set the parameter.

The option and the parameters are as the follows:

| Content | LCD Display | Range |
|--------------------|-------------|-----------|
| Transpose | xPS 00 | -12~0~12 |
| Octave | OCt 00 | -1~0~1 |
| Modulation | Mod off | ON/OFF |
| Beat | bEt 04 | 0,2...9 |
| Split Point | SPt 19 | 1~61 |
| Tune | TUE 00 | -50~50 |
| MIDI Receive | CHI ALL | 01~16,ALL |
| MIDI Transmit | CHo 01 | 01~16 |
| Automatic Shutdown | PWF 30 | 30,60,OFF |

Note:

It will automatically quit the function menu if there is no operation in 3 seconds.

TRANPOSE

Press the [FUNCTION] button to set the transpose. The LCD displays the current transpose value. Use [+] / [-] button to set the transpose value over the range from -12 to +12.

Press [+] and [-] buttons simultaneously to set its default value "0".

OCTAVE

Press the [FUNCTION] button to set the octave. The LCD displays the current octave value. Use [+] / [-] button to set the octave value over the range from -1 to +1 octaves.

Press [+] and [-] buttons simultaneously to set its default value.

MODULATION

Press the [FUNCTION] button to set the modulation. The LCD currently display "MOD". Use [+] / [-] button to set modulation ON/ OFF.

Note: This modulation effect is unavailable to percussion.

BEAT

Press the [FUNCTION] button to set the beat function, LCD displays the current beat value. Press the [+] or [-] button to change the beat value: 0, 2, 3, 4, 5, 6, 7, 8, 9. The default value is 4.

SPLIT POINT

Press the [FUNCTION] button to enter SPLIT POINT sub-menu. The LCD displays the current split point value.

Use [+ / YES] / [- / NO] button to adjust the split point value from 1 to 61. The keyboard can be also used to set the split point.

The key of the split point is the part of the left area.

The default setting is 019.

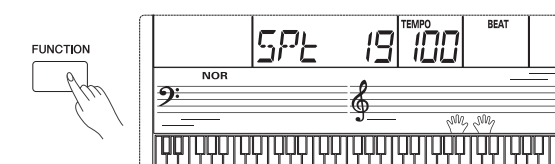
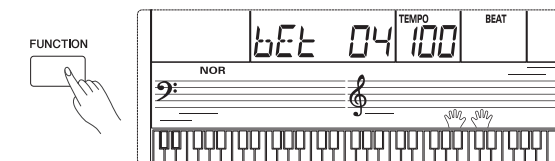
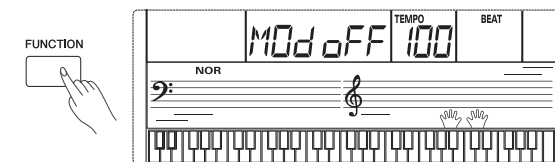
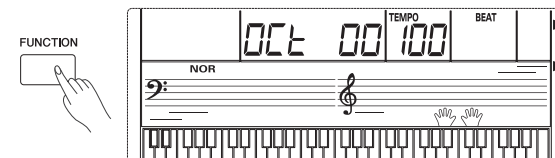
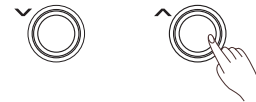
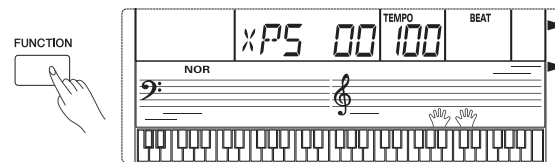
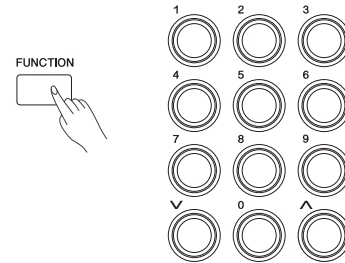

Other Function

TUNE

Press the [FUNCTION] button to select the Tune menu. The LCD displays the tune value. Use [+] / [-] to change the tune value. Its range is from -50 to +50 cents. Press [+] and [-] buttons together will set the TUNE to its default value.

Note:

The tune setting will apply to both keyboard and style.

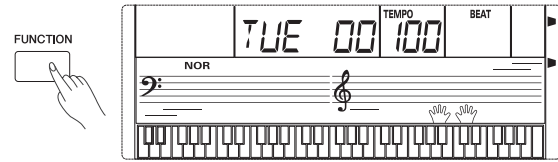

MIDI SETTING

1. Press the [FUNCTION] button to select the MIDI IN/OUT menu. LCD displays "CHI ALL" or "CHo 01" respectively.
2. Use the [+] / [-] button to select a desired channel. Channels for MIDI IN: 1~16, ALL, the default setting is All. Channels for MIDI OUT: 1~16, the default setting is 01.

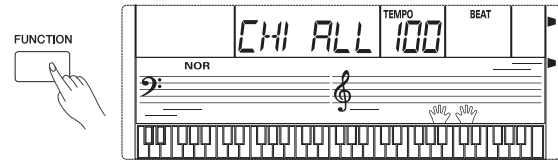

Automatic Power Off

1. Press the [FUNCTION] button repeatedly until the LCD displays "PWF 30".
2. The LCD displays the time value. The options are OFF, 30 and 60, the default value is 30.
3. Use [+] or [-] button to change the Power Off time value. Press [+] and [-] simultaneously to restore the default value: 30.

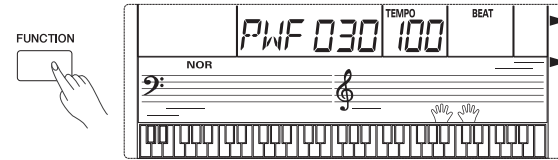
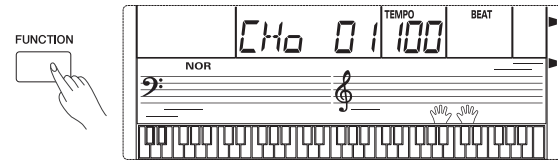

Mixer

Press [MIXER] button to enter the Mixer menu. The default option of the menu is "Accomp", When you enter this menu next time, it will display the same option of your last operation. Press [MIXER] button, select the option you want to set. Use [+] / [-] to set the parameter.

The option and the parameters are as the follows:

| Content | LCD Display | Range |
|----------------------|-------------|-------|
| Accompaniment VOLUME | AVL 25 | 0-32 |
| Rhythm Main VOLUME | RTh 31 | 0-32 |
| Bass VOLUME | bAS 31 | 0-32 |
| Chord 1 VOLUME | CH1 31 | 0-32 |
| Chord 2 VOLUME | CH2 31 | 0-32 |
| Chord 3 VOLUME | CH3 31 | 0-32 |
| Voice R1 VOLUME | UP1 28 | 0-32 |
| Voice R2 VOLUME | UP2 20 | 0-32 |
| Voice L VOLUME | LOE 20 | 0-32 |

Note:

It will quit the Mixer menu if there is no operation in 3 seconds. Press [+] and [-] buttons simultaneously, the LCD displays "OFF", it means this parameter volume is turned off. Press [+] and [-] buttons simultaneously again, the LCD will display the last volume level.

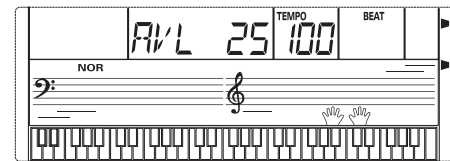
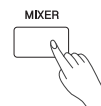

Memory

There are 4 memories (M1-M4).

1. While holding the [STORE] button, press one of the MEMORY buttons: [M1] - [M4] to register the panel settings. The new settings will replace the previous memory data. LCD show "Mem Stor". The settings include voice number, style number, tempo, beat value, sustain effect, etc.

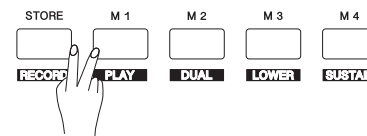

2. Press one of the MEMORY buttons: [M1] - [M4] to recall the panel settings.

Note:

The stored settings can not be recalled when the One Touch Setting function is on.

The stored settings will be returned to the default settings after you turned off the power.

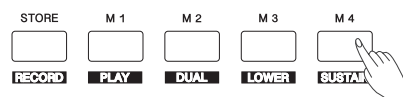
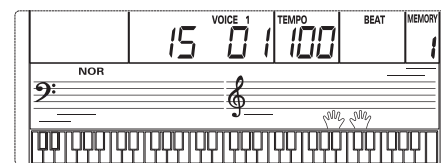

Chord Dictionary

If you know the name of a chord but don't know how to play it, you can use the Chord Dictionary function.

1. Press the [CHORD DICT.] button to enter this mode. The LCD displays the Chord Type and Chord Notes.
2. The keys on and above the C4 are used to assign the Chord Type, the keys on and above C5 are used to assign the Chord Root. When the chord Type and Chord Root are confirmed, the LCD will display the Chord and its staff position.
3. Play the chords on the keyboard according to the display. If you press the correct notes, you will hear a prompt applause sound.
4. Press the [CHORD DICT.] button again to exit this mode.

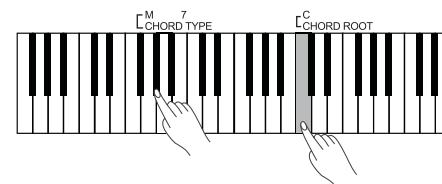

24 Chords will be displayed in the dictionary mode as follows:

| Note | Chord root | Note | Chord root | Note | Chord root |
|------|------------|------|------------|------|------------|
| C6 | C | C4 | M | C5 | 7(b9) |
| C#6 | C#/Db | C#4 | M(9) | C#5 | 7(9) |
| D6 | D | D4 | 6 | D5 | 7(#9) |
| Eb6 | Eb/D# | Eb4 | mM7 | Eb5 | 7(b13) |
| E6 | E | E4 | M7 | E5 | 7(13) |
| F6 | F | F4 | m | F5 | 7(#11) |
| F#6 | F#/Gb | F#4 | m(9) | F#5 | dim7 |
| G6 | G | G4 | m6 | G5 | dim |
| Ab6 | Ab/G# | Ab4 | m7(9) | Ab5 | 7aug |
| A6 | A | A4 | m7 | A5 | aug |
| Bb6 | Bb/A# | Bb4 | m7b5 | Bb5 | 7sus4 |
| B6 | B | B4 | 7 | B5 | sus4 |

Song

The instrument features 100 songs (Refer to **Song List**). Each song can be practiced in LESSON mode.

Listening to the Songs

1. Press the [SONG] button to enter the song mode. It will play all songs circularly. Press the [SONG] button again, it will stop the song and exit the song mode.
2. In song mode, use the number keys and [+] or [-] button to select a song.
3. Once you start playing a song by pressing [START/STOP] button, it will play current song repeatedly. Press the [START/STOP] button again, it will stop the current song but not exit the song mode.
4. Use the [TEMPO+] or [TEMPO-] button to change the tempo of the current song.
5. When the song is stopped, press [STYLE], [VOICE], [SHIFT]+[DUAL], [SHIFT]+[LOWER], [M1] - [M4] to exit the song mode.

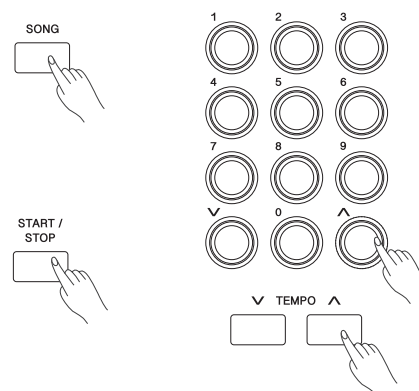

Lesson Mode

In the instrument, there are 3 different ways to practice the songs: time value training, note correction training, melody off. The grading system will help you keep track of your progress.

1. In Song mode, press the [LESSON] button to enter the lesson mode or switch the lesson mode.
 2. Press the [START/STOP] button to start learning. The LCD will display the note to play.
 3. Press the [START/STOP] button again to stop learning.
 4. There are 3 lesson modes and a grading system.
 - Lesson 1:** you need to play at the correct time value. As long as you play any key at the right time, the correct note will sound.
 - Lesson 2:** you need to play the correct notes. The lesson will continue only when you have played the note displayed on LCD, otherwise the song will stop and wait.
 - Lesson 3:** the keyboard will score your practice by the correction of the time value and note.
- Grade:** In lesson mode, each time when you finish a lesson, the keyboard will play the prompt sound to tell you the level you get.
- Level 1:** Ok
 - Level 2:** Good
 - Level 3:** Very Good
 - Level 4:** Excellent

After grading, the song will be playing again, you can learn it again.

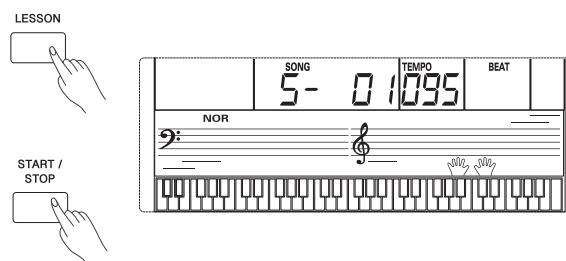

100

95

75

25

5

0

Song Recording

You can record your performance (up to 350 notes), and the accompaniment.

1. Holding down the [SHIFT] button and press the [RECORD] button, the record flag appears on the LCD, the beat flashes.

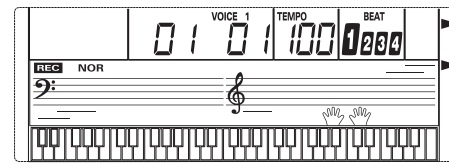

2. Play the notes you want to record or press the [START/STOP] button to start recording. To record accompaniment, turn on the chord mode, and play the chords on the left of the keyboard.



3. Holding down the [SHIFT] button and press the [RECORD] button again to stop recording. The record flag disappears.

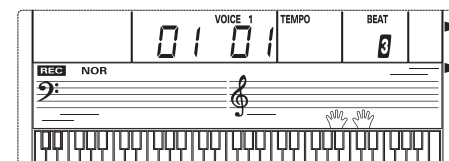

4. Holding down the [SHIFT] button and press the [PLAY] button to play the notes you recorded.



5. Holding down the [SHIFT] button and press the [PLAY] button again to stop it.

6. During recording, holding down the [SHIFT] button and press the [PLAY] button can stop recording and play the notes you recorded.

Note:

If you turned off the keyboard, the data you have recorded will be lost.

MIDI Functions

By using the MIDI functions you can expand your musical possibilities. This section explains what MIDI is, and what it can do, as well as how you can use MIDI on your instrument.

What's MIDI?

MIDI (short for Musical Instrument Digital Interface) allows a wide variety of electronic musical instruments, computers and other related devices to connect and communicate with one another. MIDI carries event messages that specify notation, pitch and velocity, control signals for parameters such as volume, vibrato, audio panning, and program change information to change the voice selections.

The instrument can output the real-time playback information via MIDI messages and control external MIDI devices. The instrument can also accept incoming MIDI messages and generate sound accordingly.

MIDI Terminals

MIDI Connection

The electronic keyboard is equipped with a standard USB interface instead of conventional MIDI IN and MIDI out connectors. The USB interface allows the keyboard to be connected to a computer without the need to separately purchase a MIDI interface for the computer. Most computers will automatically recognize the keyboard as a MIDI interface, allowing MIDI messages to be received from, or sent to, music programs running on the computer. To connect the keyboard to a computer you will need a standard USB A-B cable and suitable software such as a music sequencing program.

Note:

Activate the computer from a sleep/suspended/standby mode before connecting the USB cable.
Connect the USB cable to the instrument and a computer before turning the power of the instrument on.

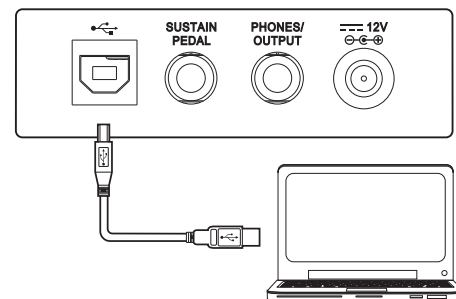

Trouble Shooting

| Problem | Possible Cause and Solution |
|---|--|
| The speakers produce a “pop” sound whenever the power is turned ON or OFF. | This is normal and is no cause for alarm. |
| No sound results when the keyboard is played. | Make sure the master volume is set at appropriate levels. |
| When using a mobile phone, noise is produced. | Using a mobile phone in close proximity to the instrument may produce interference. To prevent this, turn off the mobile phone or use it further away from the instrument. |
| The auto accompaniment does not play back even Sync is in standby condition and a key is pressed. | You may be trying to start accompaniment by playing a key in the right-hand range of the keyboard. To start the accompaniment with Sync Start, make sure to play a key in the left-hand range of the keyboard. |

Specifications

Keyboard

61

Display

Multi-functional LCD

Polyphony

32

Voice

320, including 4 drum kits

Style

110

Song

100

Demo

100

Tempo

30-280

Registration Memory

4

Control button

Power on/off switch, Function, Mixer, Tempo +/-, ChordDict, Lesson, L/R Part, DSP, Style, Voice, Song, Memory, M1-M4, O.T.S., Dual, Sustain, Touch, Metro, Lower

Accompaniment Control

Start/Stop, Sync Start, Intro/Ending, Fill A, Fill B, Fade In/Out, Chord

Record Function

Record, Play

Connectors

DC IN, Phones, USB, Sustain

Power Supply

DC IN 12V

Speaker

4Ω 3W + 3W

Dimensions

940(W) x 360(D) x 145(H)mm

Weight

4.5kg(without batteries)

* All specifications and appearances are subject to change without notice.

Voice List

| No | Name | LCD Name |
|-----------------------------|------------------------------|-----------|
| PIANO | | |
| 1 | Acoustic Grand Piano 1 | GrandPn1 |
| 2 | Acoustic Grand Piano 2 | GrandPn2 |
| 3 | Acoustic Grand Piano (dark) | GrandPnD |
| 4 | Octave Grand Piano 1 | OctPno1 |
| 5 | Octave Grand Piano 2 | OctPno2 |
| 6 | Octave Grand Piano 3 | OctPno3 |
| 7 | Piano & Choir | Pno&Cho |
| 8 | Acoustic Grand Piano (wide) | GrandPnW |
| 9 | Bright Acoustic Piano 1 | BritPno1 |
| 10 | Bright Acoustic Piano 2 | BritPno2 |
| 11 | Bright Acoustic Piano 3 | BritPno3 |
| 12 | Bright Acoustic Piano 4 | BritPno4 |
| 13 | Bright Acoustic Piano 5 | BritPno5 |
| 14 | Bright Piano (stereo) 1 | BritPnS1 |
| 15 | Bright Piano (stereo) 2 | BritPnS2 |
| 16 | Detuned Electric Piano 1 | DetunEP1 |
| 17 | Detuned Electric Piano 2 | DetunEP2 |
| 18 | Chorus Piano | ChoruPno |
| 19 | Bright Acoustic Piano (wide) | 1BritPnW1 |
| 20 | Bright Acoustic Piano (wide) | 2BritPnW2 |
| 21 | Piano & Vibraphone | Pno&Vib |
| 22 | Electric Grand Piano | E.Grand |
| 23 | Electric Grand Piano (wide) | E.GrandW |
| 24 | Honky-tonk Piano | HnkyTonk |
| 25 | Honky Tonk Piano (dark) | HnkTonkD |
| 26 | Honky Tonk Piano (wide) 1 | HnkyTkW1 |
| 27 | Honky Tonk Piano (wide) 2 | HnkyTkW2 |
| 28 | Electric Piano 1 | E.Piano1 |
| 29 | Electric Piano (stereo) | E.PianoS |
| 30 | 50's Electric Piano | 50'sEP |
| 31 | Electric Piano (wide) 1 | EPianoW1 |
| 32 | Electric Piano (wide) 2 | EPianoW2 |
| 33 | Electric Piano (wide) 3 | EPianoW3 |
| 34 | Electric Piano (wide) 4 | EPianoW4 |
| 35 | Electric Piano 2 | E.Piano2 |
| 36 | Detuned Electric Piano 1 | DetunEP1 |
| 37 | Detuned Electric Piano 2 | DetunEP2 |
| 38 | Harpsichord | Harpsi |
| 39 | Harpsichord (wide) | HarpsiW |
| 40 | Harpsichord (octave mix) 1 | HarpsiO1 |
| 41 | Harpsichord (octave mix) 2 | HarpsiO2 |
| 42 | Harpsichord (with key off) | HarpsiOf |
| 43 | Clavi | Clavi |
| 44 | Clavi (stereo) | ClaviS |
| 45 | Clavi (wide) | ClaviW |
| 46 | Wah Clavi | WahClavi |
| CHROMATIC PERCUSSION | | |
| 47 | Celesta | Celesta |
| 48 | Celesta (dark) | CelestaD |
| 49 | Celesta & Sine | Cele&Sin |
| 50 | Reecho Bell | ReBell |
| 51 | Celesta & Music Box | Cel&Mbox |
| 52 | Glockenspiel | Glocken |
| 53 | Glockenspiel & Sine | Glkn&Sin |
| 54 | Music Box | MusicBox |
| 55 | Vibraphone | Vibra |
| 56 | Vibraphone (wide) | VibraW |
| 57 | Vibraphone & Bell | Vibr&Bel |

| | | |
|---------------|-----------------------------|----------|
| 58 | Vibraphone & Harpsichord | Vibr&Hrp |
| 59 | Marimba | Marimba |
| 60 | Marimba (wide) | MarimbaW |
| 61 | Sine Marimba | SinMarmb |
| 62 | Marimba (stereo) | MarimbaS |
| 63 | Marimba & Vibraphone | Marm&Vib |
| 64 | Wood Drum | WoodDrum |
| 65 | Xylophone | Xylophon |
| 66 | Tubular Bells 1 | TubuBel1 |
| 67 | Tubular Bells 2 | TubuBel2 |
| 68 | Tubular Bells 3 | TubuBel3 |
| 69 | Dulcimer | Dulcimer |
| ORGAN | | |
| 70 | Drawbar Organ | DrawOrgn |
| 71 | Drawbar Organ (stereo) | DrawOrgS |
| 72 | Soft Stereo Drawbar Organ | DrawOgSf |
| 73 | Mellow Drawbar Organ | MellDOrg |
| 74 | Bright Drawbar Organ | DrawOrgB |
| 75 | Percussive Organ | PercOrgn |
| 76 | Detuned Percussive Organ | DePerOrg |
| 77 | Rock Organ | RockOrgn |
| 78 | Church Organ | ChurOrgn |
| 79 | Detuned Church Organ | DeChuOrg |
| 80 | Church Organ (octave mix) 1 | ChrOrgO1 |
| 81 | Church Organ (octave mix) 2 | ChrOrgO2 |
| 82 | Reed Organ | ReedOrgn |
| 83 | Reed Organ (stereo) | ReedOrgS |
| 84 | Accordion 1 | Acordin1 |
| 85 | Accordion 2 | Acordin2 |
| 86 | Accordion (stereo) | AcordinS |
| 87 | Harmonica | Harmnica |
| 88 | Harmonica (dark) | HarmnicD |
| 89 | Tango Accordion | TangoAcD |
| 90 | Tango Accordion (dark) | TangAcD |
| GUITAR | | |
| 91 | Acoustic Guitar (nylon) 1 | NylnGtr1 |
| 92 | Acoustic Guitar (nylon) 2 | NylnGtr2 |
| 93 | Chorus Nylon Guitar 1 | NylnGtC1 |
| 94 | Chorus Nylon Guitar 2 | NylnGtC2 |
| 95 | Nylon Guitar (stereo) 1 | NylnGtS1 |
| 96 | Nylon Guitar (stereo) 2 | NylnGtS2 |
| 97 | Acoustic Guitar (steel) 1 | SteelGt1 |
| 98 | Acoustic Guitar (steel) 2 | SteelGt2 |
| 99 | 12-Strings Guitar | 12StrGtr |
| 100 | Detuned Steel Guitar | DetStlGt |
| 101 | Electric Guitar (jazz) 1 | JazzGtr1 |
| 102 | Electric Guitar (jazz) 2 | JazzGtr2 |
| 103 | Electric Guitar (clean) | CleanGtr |
| 104 | Clean Guitar (stereo) | CleanGtS |
| 105 | Soft Clean Guitar | ClnGtSof |
| 106 | Chord Clean Guitar | ClnGtCho |
| 107 | Electric Guitar (muted) | MutedGtr |
| 108 | Stereo Muted Guitar | MutedGtS |
| 109 | Chord Muted Guitar | MutGtCho |
| 110 | Overdriven Guitar | Ovrdrive |
| 111 | Distortion Guitar | DistGtr |
| 112 | Guitar Harmonics | GtrHarmo |
| BASS | | |
| 113 | Acoustic Bass 1 | AcoBass1 |
| 114 | Acoustic Bass 2 | AcoBass2 |

| | | |
|---|-----------------------------|----------|
| 115 | Acoustic Bass 3 | AcoBass3 |
| 116 | Acoustic Bass 4 | AcoBass4 |
| 117 | Acoustic Bass Detuned | DetAcoBs |
| 118 | Velocity Crossfade Bass | VelCroBs |
| 119 | Jazz Style | JazzSty |
| 120 | Acoustic Bass & Mute Guitar | ABs&MtGT |
| 121 | Electric Bass (finger) 1 | FngrBs1 |
| 122 | Electric Bass (finger) 2 | FngrBs2 |
| 123 | Electric Bass (finger) 3 | FngrBs3 |
| 124 | Electric Bass (finger) 4 | FngrBs4 |
| 125 | Finger Bass (dark) 1 | FngrBsD1 |
| 126 | Finger Bass (dark) 2 | FngrBsD2 |
| 127 | Detuned Finger Bass 1 | DeFngBs1 |
| 128 | Detuned Finger Bass 2 | DeFngBs2 |
| 129 | Velocity Bass | VelBass |
| 130 | Bass & Distortion Guitar | Bs&DisGt |
| 131 | Electric Bass (pick) 1 | PickBs1 |
| 132 | Electric Bass (pick) 2 | PickBs2 |
| 133 | Mute Pick Bass | PickBsM |
| 134 | Pick & Finger Bass | Pk&FgBs |
| 135 | Pick Bass & Clean Guitar | PBs&ClGt |
| 136 | Detuned Pick Bass | DetPkBs |
| 137 | Fretless Bass 1 | Fretles1 |
| 138 | Fretless Bass 2 | Fretles2 |
| 139 | Slap Bass 1 | SlapBas1 |
| 140 | Slap Bass 2 | SlapBas2 |
| 141 | Slap Bass 3 | SlapBas3 |
| 142 | Slap Bass 4 | SlapBas4 |
| 143 | Synth Bass 1 | SynBass1 |
| 144 | Synth Bass 2 | SynBass2 |
| 145 | Synth Bass 3 | SynBass3 |
| 146 | Synth Bass 4 | SynBass4 |
| STRINGS & ORCHESTRAL INSTRUMENTS | | |
| 147 | Violin 1 | Violin1 |
| 148 | Violin 2 | Violin2 |
| 149 | Two Violin | TwoVioln |
| 150 | Viola 1 | Viola1 |
| 151 | Viola 2 | Viola2 |
| 152 | Two Viola | TwoViola |
| 153 | Cello 1 | Cello1 |
| 154 | Cello 2 | Cello2 |
| 155 | Contrabass 1 | Contrbs1 |
| 156 | Contrabass 2 | Contrbs2 |
| 157 | Tremolo Strings 1 | TremStr1 |
| 158 | Tremolo Strings 2 | TremStr2 |
| 159 | Pizzicato Strings 1 | PizzStr1 |
| 160 | Pizzicato Strings 2 | PizzStr2 |
| 161 | Orchestral Harp 1 | Harp1 |
| 162 | Orchestral Harp 2 | Harp2 |
| 163 | Orchestral Harp (stereo) | HarpS |
| 164 | Timpani 1 | Timpani1 |
| 165 | Timpani 2 | Timpani2 |
| ENSEMBLE | | |
| 166 | Strings Ensemble 1 | Strings1 |
| 167 | Strings Ensemble 2 | Strings2 |
| 168 | Strings Ensemble 3 | Strings3 |
| 169 | Strings Ensemble 4 | Strings4 |
| 170 | Stereo Strings 1 | StringS1 |
| 171 | Stereo Strings 2 | StringS2 |
| 172 | Synth Strings 1 | SynStrs1 |

Voice List

| | | |
|--------------|--------------------------|----------|
| 173 | Synth Strings 2 | SynStrs2 |
| 174 | Synth Strings 3 | SynStrs3 |
| 175 | Synth Strings (stereo) 1 | SynStrS1 |
| 176 | Synth Strings (stereo) 2 | SynStrS2 |
| 177 | Choir Aahs | ChoirAah |
| 178 | Choir Aahs (dark) | ChoAahD |
| 179 | Stereo Aahs 1 | ChoAhS1 |
| 180 | Stereo Aahs 2 | ChoAhS2 |
| 181 | Mellow Choir Aahs | ChoAhMel |
| 182 | Aahs & Synth Strings | Ah&SyStr |
| 183 | Big Aahs | BigAahs |
| 184 | Voice Oohs | VoiceOoh |
| 185 | Synth Voice 1 | SynVoic1 |
| 186 | Synth Voice 2 | SynVoic2 |
| 187 | Synth Voice (stereo) | SynVoicS |
| 188 | Orchestra Hit | OrchHit |
| 189 | Orchestra Hit (stereo) | OrchHitS |
| 190 | Octave Orchestra Hit | HitOctO |
| BRASS | | |
| 191 | Trumpet 1 | Trumpet1 |
| 192 | Trumpet 2 | Trumpet2 |
| 193 | Trumpet (dark) | TrumpetD |
| 194 | Wah Trumpet | TrumpetW |
| 195 | Trombone 1 | Trmbone1 |
| 196 | Trombone 2 | Trmbone2 |
| 197 | Tuba 1 | Tuba1 |
| 198 | Tuba 2 | Tuba2 |
| 199 | Muted Trumpet 1 | MuteTrp1 |
| 200 | Muted Trumpet 2 | MuteTrp2 |
| 201 | French Horn 1 | FrHorn1 |
| 202 | French Horn 2 | FrHorn2 |
| 203 | Fifth Horn Orchestra | 5thHorn |
| 204 | Brass Section | Brass |
| 205 | Synth Brass 1 | SynBras1 |
| 206 | Synth Brass 2 | SynBras2 |
| 207 | Synth Brass 3 | SynBras3 |
| 208 | Synth Brass 4 | SynBras4 |
| 209 | Synth Brass 5 | SynBras5 |
| 210 | Octave Synth Brass | SynBrasO |
| REED | | |
| 211 | Soprano Sax 1 | SprnSax1 |
| 212 | Soprano Sax 2 | SprnSax2 |
| 213 | Alto Sax 1 | AltoSax1 |
| 214 | Alto Sax 2 | AltoSax2 |
| 215 | Tenor sax 1 | TenoSax1 |
| 216 | Tenor sax 2 | TenoSax2 |
| 217 | Baritone Sax 1 | BariSax1 |
| 218 | Baritone Sax 2 | BariSax2 |
| 219 | Oboe | Oboe |
| 220 | Sweet Oboe | SwetOboe |
| 221 | English Horn 1 | EngHorn1 |
| 222 | English Horn 2 | EngHorn2 |

| | | |
|-------------------|------------------------|-----------|
| 223 | Bassoon 1 | Bassoon1 |
| 224 | Bassoon 2 | Bassoon2 |
| 225 | Clarinet 1 | Clarinet1 |
| 226 | Clarinet 2 | Clarinet2 |
| PIPE | | |
| 227 | Piccolo | Piccolo |
| 228 | Flute 1 | Flute1 |
| 229 | Flute 2 | Flute2 |
| 230 | Recorder 1 | Recordr1 |
| 231 | Recorder 2 | Recordr2 |
| 232 | Pan Flute 1 | PanFlut1 |
| 233 | Pan Flute 2 | PanFlut2 |
| 234 | Blown Bottle 1 | Bottle1 |
| 235 | Blown Bottle 2 | Bottle2 |
| 236 | Shakuhachi 1 | Shakchi1 |
| 237 | Shakuhachi 2 | Shakchi2 |
| 238 | Whistle 1 | Whistle1 |
| 239 | Whistle 2 | Whistle2 |
| 240 | Ocarina 1 | Ocarina1 |
| 241 | Ocarina 2 | Ocarina2 |
| SYNTH LEAD | | |
| 242 | Lead 1 (square) 1 | SquarLd1 |
| 243 | Lead 1 (square) 2 | SquarLd2 |
| 244 | Lead 1 (square) 3 | SquarLd3 |
| 245 | Lead 1b (sine) | SineLead |
| 246 | Slow Square Lead | SawLead |
| 247 | Thick Square | ThickSq |
| 248 | Quint | Quint |
| 249 | Sine Solo | SineSolo |
| 250 | Lead 2 (sawtooth) 1 | SawLead1 |
| 251 | Lead 2 (sawtooth) 2 | SawLead2 |
| 252 | Stereo Sawtooth 1 | SawLdS1 |
| 253 | Stereo Sawtooth 2 | SawLdS2 |
| 254 | Fifth Sawtooth | 5thSaw |
| 255 | Lead 3 (calliope) 1 | CalipLd1 |
| 256 | Lead 3 (calliope) 2 | CalipLd2 |
| 257 | Lead 4 (chiff) 1 | ChiffLd1 |
| 258 | Lead 4 (chiff) 2 | ChiffLd2 |
| 259 | Lead 5 (charang) 1 | CharnLd1 |
| 260 | Lead 5 (charang) 2 | CharnLd2 |
| 261 | Lead 6 (voice) 1 | VoiceLd1 |
| 262 | Lead 6 (voice) 2 | VoiceLd2 |
| 263 | Lead 7 (fifths) | FifthsLd |
| 264 | Lead 8 (bass + lead) 1 | Bs&Lead1 |
| 265 | Lead 8 (bass + lead) 2 | Bs&Lead2 |
| SYNTH PAD | | |
| 266 | Pad 1 (new age) 1 | NewAgPd1 |
| 267 | Pad 1 (new age) 2 | NewAgPd2 |
| 268 | Pad 2 (warm) 1 | WarmPad1 |
| 269 | Pad 2 (warm) 2 | WarmPad2 |
| 270 | Pad 3 (polysynth) 1 | PlySyPd1 |
| 271 | Pad 3 (polysynth) 2 | PlySyPd2 |

| | | |
|---------------------|-------------------|-----------|
| 272 | Pad 4 (choir) 1 | ChorPad1 |
| 273 | Pad 4 (choir) 2 | ChorPad2 |
| 274 | Pad 5 (bowed) 1 | BowdPad1 |
| 275 | Pad 5 (bowed) 2 | BowdPad2 |
| 276 | Pad 6 (metallic) | MetalPad |
| 277 | Pad 7 (halo) | HaloPad |
| 278 | Pad 8 (sweep) | SweepPad |
| SYNTH SFX | | |
| 279 | FX 1 (rain) | FXRain |
| 280 | FX 2 (soundtrack) | Soundtrk |
| 281 | FX 3 (crystal) | Crystal |
| 282 | FX 4 (atmosphere) | Atmosphr |
| 283 | FX 5 (brightness) | Bright |
| 284 | FX 6 (goblins) | Goblins |
| 285 | FX 7 (echoes) | Echoes |
| 286 | FX 8 (sci-fi) | Sci-Fi |
| ETHNIC MISC. | | |
| 287 | Sitar | Sitar |
| 288 | Detuned Sitar | DetSitar |
| 289 | Banjo 1 | Banjo1 |
| 290 | Banjo 2 | Banjo2 |
| 291 | Shamisen 1 | Shamisen1 |
| 292 | Shamisen 2 | Shamisen2 |
| 293 | Koto 1 | Koto1 |
| 294 | Koto 2 | Koto2 |
| 295 | Kalimba 1 | Kalimba1 |
| 296 | Kalimba 2 | Kalimba2 |
| 297 | Bagpipe | Bagpipe |
| 298 | Fiddle | Fiddle |
| 299 | Shanai | Shanai |
| PERCUSSIVE | | |
| 300 | Tinkle Bell | TnklBell |
| 301 | Agogo | Agogo |
| 302 | Steel Drums | StelDrum |
| 303 | Bass Drum | BassDrum |
| 304 | Wood Block | WoodBlok |
| 305 | Snare | Snare |
| 306 | Taiko Drum | TaikoDum |
| 307 | Melodic Tom | MelodTom |
| 308 | Synth Drum | SynDrum |
| 309 | Reverse Cymbal | RevCymb1 |
| SFX | | |
| 310 | Synth 1 | Synth1 |
| 311 | Synth 2 | Synth2 |
| 312 | Synth 3 | Synth3 |
| 313 | Synth 4 | Synth4 |
| 314 | Synth 5 | Synth5 |
| 315 | Synth 6 | Synth6 |
| 316 | Synth 7 | Synth7 |
| DRUM | | |
| 317 | Standard Set | StandSet |
| 318 | Rock Set | RockSet |
| 319 | Electronic Set 1 | ElecSet1 |
| 320 | Electronic Set 2 | ElecSet2 |

Style List

| No | Name | LCD Name |
|-----------------------|----------------|-----------|
| BEAT & POP | | |
| 1 | 8Beat 1 | 8Beat1 |
| 2 | 8Beat 2 | 8Beat2 |
| 3 | 8Beat 3 | 8Beat3 |
| 4 | 8Beat 4 | 8Beat4 |
| 5 | 60's 8Beat | 60's8Bt |
| 6 | 8Beat Ballad | 8BtBalld |
| 7 | 8Beat Rock | 8BtRock |
| 8 | 16Beat 1 | 16Beat1 |
| 9 | 16Beat 2 | 16Beat2 |
| 10 | Pop 16Beat | Pop16Bt |
| 11 | 16Beat Shuffle | 16BtShfl |
| 12 | Ballad | Ballad |
| 13 | Slow Ballad | SlowBald |
| 14 | 16Beat Ballad | 16BtBald |
| 15 | Unplugged | Unplugged |
| ROCK | | |
| 16 | Rock | Rock |
| 17 | Pop Rock | PopRock |
| 18 | Fast Rock | FastRock |
| 19 | Slow Rock 1 | SlwRock1 |
| 20 | Slow Rock 2 | SlwRock2 |
| 21 | Rock & Roll | RockRoll |
| 22 | Heavy Metal | HavyMetl |
| 23 | Blues Boogie | BluBogie |
| 24 | Blues | Blues |
| 25 | Shuffle | Shuffle |
| 26 | Blues Shuffle | BlusShfl |
| 27 | Rock Shuffle | RockShfl |
| 28 | Charlston | Charston |
| 29 | Old Rock | OldRock |
| 30 | Easy Rock | EasyRock |
| DANCE | | |
| 31 | Disco 1 | Disco1 |
| 32 | Disco 2 | Disco2 |
| 33 | Disco Funk | DiscFunk |
| 34 | Dance | Dance |
| 35 | House 1 | House1 |
| 36 | House 2 | House2 |
| 37 | Rap | Rap |
| 38 | Euro Dance | EuroDanc |

| | | |
|------------------------|--------------------|----------|
| 39 | Hip Hop | HipHop |
| 40 | Techno | Techno |
| 41 | Euro Dance | EuroDanc |
| 42 | Garage | Garage |
| SOUL & FUNK | | |
| 43 | Pop Funk | PopFunk |
| 44 | Jazz Funk | JazzFunk |
| 45 | Cool Funky | CoolFunk |
| 46 | Soul 1 | Soul1 |
| 47 | Soul 2 | Soul2 |
| 48 | Soul Shuffle | SoulShfl |
| 49 | Soul Blues | SoulBlus |
| 50 | R&B | R&B |
| 51 | 6/8 Gospel | 6/8Gospl |
| 52 | Pop Groove | PopGrove |
| 53 | Gospel Swing | GopSwing |
| 54 | Gospel | Gospel |
| JAZZ | | |
| 55 | Swing | Swing |
| 56 | Cool Jazz | CoolJazz |
| 57 | Pop Swing | PopSwing |
| 58 | Swing Fox | SwingFox |
| 59 | Big Band | BigBand |
| 60 | Big Band Meduim | BBandMed |
| 61 | Jazz Waltz | JazzWltz |
| 62 | Ragtime | Ragtime |
| 63 | Dixeland | Dixeland |
| 64 | Quick Step | QuickStp |
| 65 | Guitar Swing 1 | GtSwing1 |
| 66 | Swing Shuffle | SwingSfl |
| COUNTRY | | |
| 67 | Country 1 | Country1 |
| 68 | Country 2 | Country2 |
| 69 | Country Pop | CntryPop |
| 70 | Country Rock | CtryRock |
| 71 | Country Folk | CtryFolk |
| 72 | 3/4 Country | 3/4Ctry |
| 73 | Country Waltz | CtryWltz |
| 74 | Country Shuffle | CtryShfl |
| 75 | Country Boogie | CtyBogie |
| 76 | Country Blues | CtyBlues |
| 77 | Country Quick Step | CtryStep |

| | | |
|--------------------|--------------|----------|
| 78 | Bluegrass | Bluegras |
| LATIN | | |
| 79 | Bossa Nova 1 | Bossa1 |
| 80 | Bossa Nova 2 | Bossa2 |
| 81 | Rumba | Rumba |
| 82 | Pop Rumba | PopRumba |
| 83 | Cha Cha | ChaCha |
| 84 | Pop Cha Cha | PChaCha |
| 85 | Tango | Tango |
| 86 | Jazz Samba | JazSamba |
| 87 | Reggae | Reggae |
| 88 | Pop Reggae | PReggae |
| TRADITIONAL | | |
| 89 | March 1 | March1 |
| 90 | March 2 | March2 |
| 91 | German March | GerMarch |
| 92 | 6/8 March 1 | 6/8March |
| 93 | Polka | Polka |
| 94 | Pop Polka | PopPolka |
| 95 | Waltz | Waltz |
| 96 | Slow Waltz | SloWaltz |
| 97 | Vienna Waltz | VieWaltz |
| 98 | Musette | Musette |
| 99 | Party Polka | PtyPolka |
| 100 | Mazurka | Mazurka |
| PIANO | | |
| 101 | 8Beat | Pno8Beat |
| 102 | Ballad | PnoBald |
| 103 | Boogie | PnoBogie |
| 104 | Jazz | PnoJazz |
| 105 | Piano Swing | PnoSwing |
| 106 | Waltz Jazz | WltzJazz |
| 107 | Twist | PnoTwist |
| 108 | March | PnoMarch |
| 109 | 6/8 March 2 | Pno6/8Mr |
| 110 | Piano Waltz | PnoWaltz |

Song List

| No. | Name | LCD Name |
|-----------------|--|----------|
| CLASSIC | | |
| 1 | Cannon | Cannon |
| 2 | Meditation | Meditati |
| 3 | Old French Song | France |
| 4 | Minuet In G | Minuet |
| 5 | Ode To Joy | OdeToJoy |
| 6 | Wiegenlied | WieGenli |
| 7 | The Surprise Symphony | Surprise |
| 8 | Swan Lake | SwanLake |
| 9 | The Four Seasons | F.Season |
| 10 | Carmen | Carmen |
| 11 | Joy To The World | JoyWorld |
| 12 | Toy Symphony | Toy |
| 13 | Humoreske | Humoresk |
| 14 | Kuckucks Walzer | Kuckucks |
| FAVORITE | | |
| 15 | It's Been A Long, Long Time | LongAgo |
| 16 | Old Folks At Home | OldFolks |
| 17 | Oh! Susanna | Susanna |
| 18 | Jeanie With The Light Brown Hair | Jeannie |
| 19 | Bill Bailey, Won't You Please Come Home? | Billhome |
| 20 | Annie Laurie | Annielau |
| 21 | From The New World | NewWorld |
| 22 | The Yellow Rose Of Texas | RoseTexa |
| 23 | Ave Maria | AveMaria |
| 24 | My Old Kentucky Home | Kentucky |
| 25 | Turkey In The Straw | Turkey |
| 26 | Deck The Halls | DeckHall |
| 27 | Grandfather's Clock | G'sClock |
| 28 | America The Beautiful | America |
| 29 | The Sideway | Sideway |
| 30 | The Entertainer | Entertai |
| 31 | The Old Gray Mare | GrayMare |
| 32 | Aloha Oe | AlohaOe |
| 33 | Solvejg's Cradle Song | Solveig |
| 34 | Campdown Races | C.Races |
| 35 | Carry Me Back To Old Virginny | Viginia |
| 36 | The Blue Bells Of Scotland | BlueBell |
| 37 | O Sole Mio | OsoloMio |
| 38 | Jingle Bells | JingBell |
| 39 | Battle Hymn Of The Republic | Battle |
| 40 | Silent Night | SltNight |
| FOLK | | |
| 41 | Огонек | Ogoniok |
| 42 | Aura Lea | AulaLee |
| 43 | House Of The Rising Sun | HouseSun |
| 44 | Danny Boy | DannyBoy |
| 45 | I've Been Working On The Railroad | WorkRail |
| 46 | With Games | WithGame |
| 47 | Way Home | WayHome |
| 48 | Parting | Parting |
| 49 | Yankee Doodle | YankeeD |
| 50 | Red River Valley | RedRiver |

| No. | Name | LCD Name |
|-----------------------------|---------------------------------|-----------|
| 51 | Auld Lang Syne | AuldLang |
| 52 | When The Saints Go Marching In | Marching |
| 53 | Twinkle Twinkle Little Star | Twinkle |
| 54 | Happy Birthday To You | Birthday |
| 55 | Little Brown Jug | BrownJug |
| 56 | Michael Row The Boat Ashore | RowBoat |
| 57 | Old King Cole | KingCole |
| 58 | Jamaica Farewell | Jamaica |
| 59 | Тройка | Troika |
| 60 | Cielito Lindo | Cielito |
| 61 | If You're Happy And You Know It | ClapHand |
| 62 | American Patrol | A.Patrol |
| 63 | When Johnny Comes Marching Home | ComeHome |
| 64 | Green Sleeves | Sleeves |
| 65 | Santa Lucia | SantaLu |
| 66 | Sweet Waltz | SweetWal |
| KID'S SONG | | |
| 67 | Angels We Have Heard On High | Angels |
| 68 | Skip To My Lou | SkipMyLo |
| 69 | London Bridge Is Falling Down | Bridge |
| 70 | Humpty Dumpty | HumptyD |
| 71 | Home On The Range | HomeRang |
| 72 | This Old Man | OldMan |
| 73 | Star Bright | StarBri |
| 74 | Ten Little Indians | TenIndia |
| 75 | Polly Wolly Doodle | PlyWlyDo |
| 76 | Santa Claus Is Coming To Town | SantaCla |
| 77 | Sippin' Cider Through A Straw | SipinCid |
| 78 | La Cucaracha | Cucaraca |
| 79 | Home Sweet Home | SwetHome |
| 80 | Up On The House Top | HouseTop |
| BALLROOM | | |
| 81 | Kuerchake Dance | Kulzak |
| 82 | Samba | Samba |
| 83 | Tango | Tango |
| 84 | Kazakhstan Dance | Kazakhst |
| 85 | Naughty Polka | Polka |
| PIANO & KEYBOARD | | |
| 86 | Four Little Swans | FourSwan |
| 87 | Did You Ever See A Lassie | Lassie |
| 88 | Spring | Spring |
| 89 | Impromptu | Imprompt |
| 90 | Gavotte | Gavotte |
| 91 | Nocturne | Nocturne |
| 92 | Pizzicato Polka | Pizicato |
| 93 | Moment Musical | M.Moment |
| 94 | The Rag-Time Dance | Rag-Time |
| 95 | Love | Love |
| 96 | Valse No.6 "Petit Chien" | ValseNo6 |
| 97 | Rondeau | Rondeau |
| 98 | The Chrysanthemum | Chrysanf |
| 99 | Invention A 2 Voix | Invetion |
| 100 | Afternoon | Afternoon |

MIDI Implementation Chart

| Function | | Transmitted | Recognized | Remarks |
|------------------|----------------|---------------|--------------------------|-------------------|
| Basic Channel | Default | 1ch | ALL | |
| | Changed | x | x | |
| Mode | Default | x | 1 | |
| | Messages | x | x | |
| | Altered | ***** | x | |
| Note Number | Note | 18—114 | 0—127 | |
| | :True voice | ***** | 0—127 | |
| Velocity | Note on | ○ 9nH,V=1-127 | ○ 9nH,V=1-127 | |
| | Note off | × (9nH,V=0) | × (9nH,V=0; 8nH,V=0-127) | |
| After Touch | key's | x | x | |
| | Ch's | x | x | |
| Pitch Bend | | ○ | ○ | |
| Control Change | 0 | ○ | ○ | Bank Select |
| | 1 | x | ○ | Modulation |
| | 5 | x | x | Portamento Time |
| | 6 | x | ○ | Data Entry |
| | 7 | x | ○ | Volume |
| | 10 | x | ○ | Pan |
| | 11 | x | ○ | Expression |
| | 64 | ○ | ○ | Sustain Pedal |
| | 65 | x | x | Portamento ON/OFF |
| | 66 | x | ○ | Sostenuto Pedal |
| | 67 | x | ○ | Soft Pedal |
| | 80 | x | ○ | Reverb Program |
| | 81 | x | ○ | Chorus Program |
| | 91 | x | ○ | Reverb Level |
| | 93 | x | ○ | Chorus Level |
| | 120 | x | ○ | All Sound Off |
| 121 | x | ○ | Reset All Controllers | |
| 123 | ○ | ○ | All Notes Off | |
| Program Change | :true | ○ ***** | ○ 0—127 | |
| System Exclusive | | x | x | |
| System Common | :SongPosition | x | x | |
| | :Song Select | x | x | |
| | :Tune | x | x | |
| System Real Time | :Clock | x | x | |
| | :Commands | x | x | |
| Aux Messages | :LOCAL ON/OFF | x | x | |
| | :All Notes Off | ○ | ○ | |
| | :Active sense | x | ○ | |
| | :Reset | x | ○ | |
| Notes: | | | | |

- Mode 1: OMNI ON, POLY
- Mode 2: OMNI ON, MONO

- Mode 3: OMNI OFF, POLY
- Mode 4: OMNI OFF, MONO
- : YES
- ×: NO