



使用说明书

JT-305
舞台校音器(金属外壳)

一. 注意事项

地点

本产品在下列地点使用, 可能会引起机器故障:
阳光直射、高温、潮湿环境; 多灰尘、极端地点; 强烈震动处; 靠近磁场处。

电源供给

将指定的交流电源插入合适电压的交流插座, 不要使用电压不适合的插座。

电器干扰

附近的无线设备和电视机可能受到干扰, 使用本机时请远离这些设备。

操作

操作开关和按键时请不要用力过当, 以免损坏本机。

护理

如果是面脏了, 用干净、干燥的布擦拭。不要用苯、天拿水、洗涤剂、可燃性抛光剂等液体清洁剂。

妥善保管本说明书

阅读本说明书后, 请妥善保管以备查阅。

远离杂物

本机附近不要放置液体容器。如果液体进入本机, 可能引起本机故障, 起火或触电。请注意不要让金属物件进入本机, 如确实有东西进入本机, 请快速从插座上拔下交流电源适配器并从机面上拔下单声道输入插头, 并联系最近的经销商或卖家进行处理。

废物处理

不要把本机和生活垃圾一同丢弃。正确的处理可以减少环境污染和健康危害。正确的处理方法各地不同, 所以详情请联系当地官方机构。

重要通知

本产品按照严格的产品规格和电压条件生产, 在特定的区域本产品可用。如果需要通过网购、邮件订单、或电话销售, 请验证您所在的区域本产品能够使用。在任何未被验证的区域使用本产品都是危险的, 并且不再享受厂家或经销商的保修权利。同时也请保留好发票作为购买证据, 否则不享受厂家或经销商的保修权利。

二. 各部件名称及功能

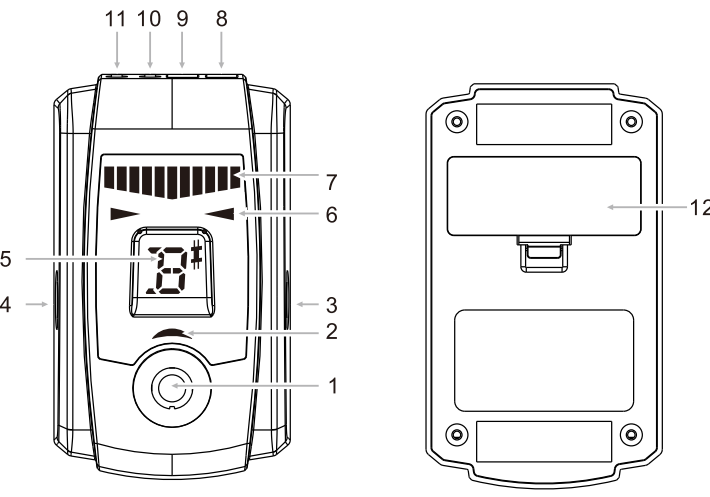

1. 校音器开关
2. 校音器指示灯/电量指示灯
3. 单声道信号输入
4. 单声道信号直通输出
5. 音名指示灯及按参数显示
6. 音高指示灯

7. 音分指示灯
8. 9V直流输入插口
9. OUT电源输出
10. DISPLAY按钮
11. CALIB按钮
12. 电池仓

三. 连接方法

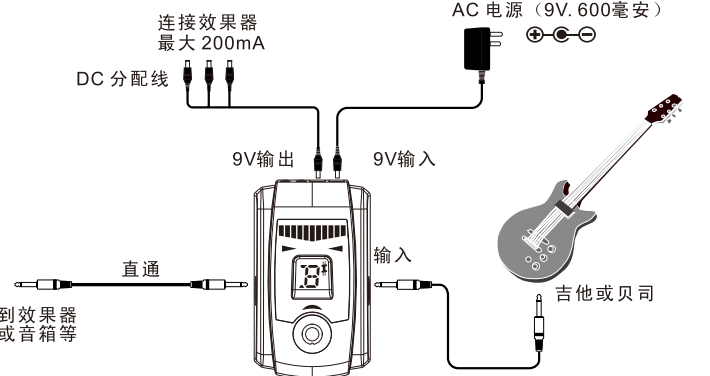

连接前关掉所有设备的电源以免损害设备

■INPUT(输入)接口和BYPASS(直通)接口使用标准插头, 立体声插头不可用。

INPUT(输入)接口

将乐器用单声道连接接到本机输入接口, 音名指示灯和音高指示灯会显示当前A4标准频率。左侧音高灯亮, 和显示模式, 右侧音高灯亮, 之后进入信号直通状态。

注意: 将连接线插入输入接口即为打开电源, 但此时为直通模式。按下校音器开关开启校音模式。

■如果不用时, 请拔掉输入接口连接线, 以节约电池电量。

BYPASS(直通)接口

从BYPASS接口用单声道连接接到你的效果器或者音箱等设备。

注意: 打开校音器后输出是静音状态; 关闭校音器后才有声音输出。

本机是真正的直通电路, 当校音器关闭后, 你的音色将不会受到任何影响。

DC 9V输入接口

确定你的电压输出是直流9V并且至少600mA。

使用不正确的电源适配器可能会导致损坏机器。

DC 9V输出接口

如果使用电源适配器, 可以用直流连接线输出电量到其他的多单元效果器。

■输出总电流不要超过200mA。注意所连接器的正极是否正确。

■不要将电源适配器插入本接口。

■如果使用电源供电, 请不要从这个接口给其他设备供电。

四. 电池的安装方法

■校音器指示灯闪烁时请更换电池。

- 打开电池盒盖。
- 将电池连接扣线与电池相接。
- 注意正负极。
- 放入电池、关上盒盖。

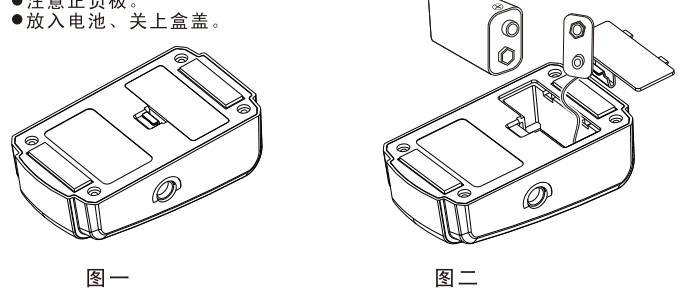

图一

图二

五. 如何使用校音功能

- 1.用单声道连接线连接乐器和本机输入端, 按下校音器开关, 打开校音功能。校音器指示灯会亮起, 因为本机采用真正的直通电路, 只能静默校音, 也就是校音时不会从音箱发出声音。
- 2.注意: 校音器开关只在单声道连接线插入接口后才会工作。
- 2.根据需求, 可以调整A4校音标准和或显示模式。出厂的设置为: A4=440Hz。显示模式为仪表式, 您可以通过CALIB按钮和DISPLAY按钮调整。
- (参照七. 如何调节A4标准频率和八. 如何设置显示模式)
- 3.用乐器演奏一个音符, 并调节乐器的音高, 直到屏幕显示预期的音名。
- 4.根据音高指示灯和音分指示灯显示的状态, 细微调节乐器的音高。音偏高、音偏低、音准的显示方式, 取决于选用哪种显示模式。
- (参照八. 如何设置显示模式)
- 5.校音完成后, 关掉校音器校音开关, 此时声音会从音箱发出。

注意: 如果校音器使用过程中, 校音器指示灯闪烁, 表明电池电量低, 请更换电池。(参照四. 电池的安裝方法)

六. 如何使用直通功能

用单声道连接线连接乐器和本机输入接口, 默认为直通功能; 校音状态按下校音器开关, 即可回到直通模式。

七. 如何调节A4标准频率

本机出厂标准为: A4=440Hz, 可调整范围是: 436-445Hz。

- 1.按下CALIB按钮, 当前的A4标准音高会显示2秒钟后灭掉, 调整A4标准频率时, 左侧的音高指示灯会亮起。
- 2.当前A4标准频率显示时, 再次按下CALIB按钮来调节A4标准频率。每当按一次CALIB按钮, A4标准频率就会以下顺序的参数改变:
0.440 Hz, 1. 441 Hz, 2. 442 Hz, 3. 443 Hz, 4. 444 Hz, 5. 445 Hz, 6. 436 Hz, 7. 437 Hz, 8. 438 Hz, 9. 439 Hz
- 3.选择好你要的标准后, 第2秒钟, 不要任何操作, 灯灭后新的标准生效。选完之后, 会自动回到校音模式或信号直通模式。

注意: 每次调整A4标准频率之后, 设置会被记忆, 即使重启或断电。

(参照九. 恢复出厂设置)

八. 如何设置显示模式

本机可以选择4种显示模式, 出厂为仪表模式。

- 1.按下DISPLAY按钮, 当前的显示模式会显示2秒钟后灭掉, 调整显示模式时, 右侧的音高指示灯会亮起。
- 2.当显示当前显示模式的时候, 再次按下Display按钮来调整显示模式, 每按下一次就会有以下的顺序变化:
1. 仪表式
音准时: 音分指示灯亮绿灯, 左右音高指示灯都亮;
音偏低时: 左侧音分指示灯亮, 左侧音高指示灯亮;
音偏高时: 右侧音分指示灯亮, 右侧音高指示灯亮;
(离中心绿灯位置越远说明音偏的越多)
2. 半屏滚动式
音准时: 音分指示灯全亮, 左右音高指示灯都亮;
音偏低时: 音分指示灯向左滚动, 左侧音高指示灯亮;
音偏高时: 音分指示灯向右滚动, 右侧音高指示灯亮;
(滚动越快说明音偏的越多)
3. 半屏展开式
音准时: 音分指示灯亮绿灯, 左右音高指示灯都亮;
音偏低时: 音分指示灯亮左半屏, 左侧音高指示灯亮;
音偏高时: 音分指示灯亮右半屏, 右侧音高指示灯亮;
(亮的灯越多说明音偏的越多)
按键后约2秒钟灯会灭掉, 并返回校音器或信号直通模式。

注意: 每次调整显示模式之后, 设置会被记忆, 即使重启或断电。

(参照九. 恢复出厂设置)

九. 恢复出厂设置

本机会记忆A4标准音频率和显示模式的设置, 即使重启或断电。如果需要恢复出厂设置, 请装好电池或插上电源适配器, 按下CALIB按钮或DISPLAY按钮, 再将单声道插头插入输入孔, 即会清除之前存储的数据, 并恢复出厂设置: A4 = 440 Hz, DISPLAY MODE = 1。

十. 参数

校音范围: 0A(27.5 Hz)-8C(4186.01 Hz)

标准音范围: A4 = 436-445 Hz(1 Hz / 步)

校音误差: ±1 音分

电源: 9V电池或交流适配器 (输出DC 9V, 600 ma或更大)

输入阻抗: 1 M-ohm (音乐阻抗)

电流消耗量: 最大50mA

电池寿命: 约5小时 (连续A4音输入, 仪表式显示模式)

重量: 430g(含电池)

尺寸: 76(宽)×120(高)×46(厚) 毫米

十一. 附件

- A. 说明书
- B. 1节9V电池

深圳市卓乐科技有限公司

公司地址: 广东省深圳市宝安28区新安三路陆氏工业大厦2楼 邮编: 518133

www.joyochna.cn 传真: 0755-29765389 国内销售热线: 0755-29765116

售后服务邮箱: ele@joyochna.cn 售后服务热线: 0755-29765393



Manual

JT-305
Pedal Tuner(Metal Casing)

I . WARNING

Location

Using the unit in the following locations can result in a malfunction.

● In direct sunlight

Locations of extreme temperature or humidity

Excessively dusty or dirty locations

Locations of excessive vibration

Close to magnetic fields

Power supply

Please connect the designated AC adaptor to an AC outlet of the correct voltage. Do not connect it to an AC outlet of voltage other than that for which your unit is intended.

Interference with other electrical devices

Radios and televisions placed nearby may experience reception interference. Operate this unit at a suitable distance from radios and televisions.

Care

To avoid breakage, do not apply excessive force to the switches or controls.

● If the exterior becomes dirty, wipe it with a clean, dry cloth. Do not use liquid cleaners such as benzene or thinner, or cleaning compounds or flammable polishes.

Keep this manual

After reading this manual, please keep it for later reference.

Keeping foreign matter out of your equipment

Never set any container with liquid in it near this equipment. If liquid gets into the equipment, it could cause a breakdown, fire, or electrical shock.

Be careful not to let metal objects get into the equipment. If something does slip into the equipment, unplug the AC adapter from the wall outlet. Then contact your nearest dealer or the store where the equipment was purchased.

Regarding disposal

Do not dispose of this product along with your household trash. By disposing of this product correctly, you can avoid environmental harm or health risk. The correct method of disposal will depend on your locality, so please contact the appropriate local authorities for details.

Important notice to customers

This product has been manufactured according to strict specifications and voltage requirements that are applicable in the country in which it is intended that this product should be used. If you have purchased this product via the internet, through mail order, and/or via a telephone sale, you must verify that this product is intended to be used in the country in which you reside.

WARNING: Use of this product in any country other than that for which it is intended could be dangerous and could invalidate the manufacturer's or distributor's warranty.

Please also retain your receipt as proof of purchase otherwise your product may be disaffiliated from the manufacturer's or distributor's warranty.

II . PART NAMES AND FUNCTIONS

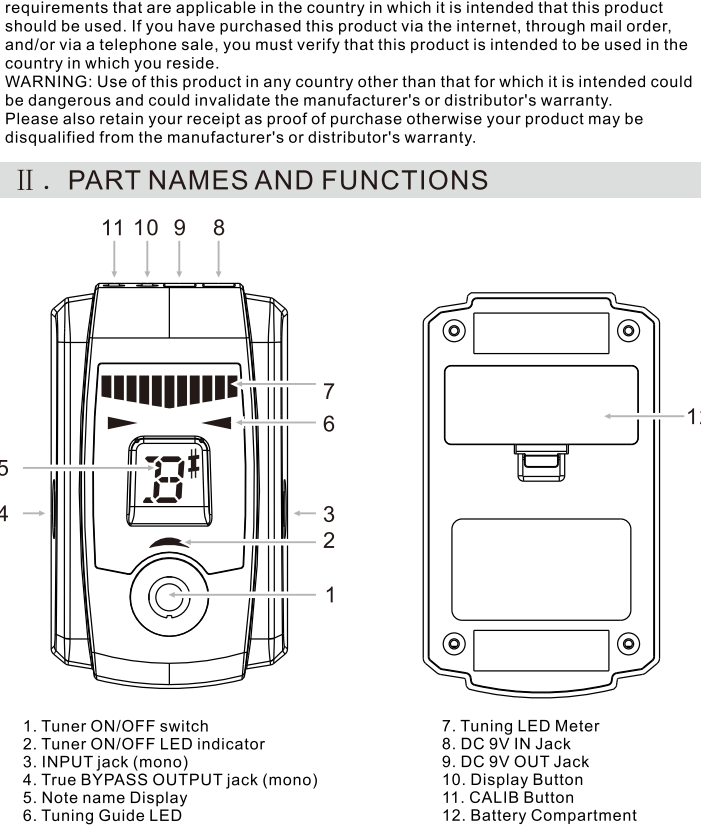

III . CONNECTIONS

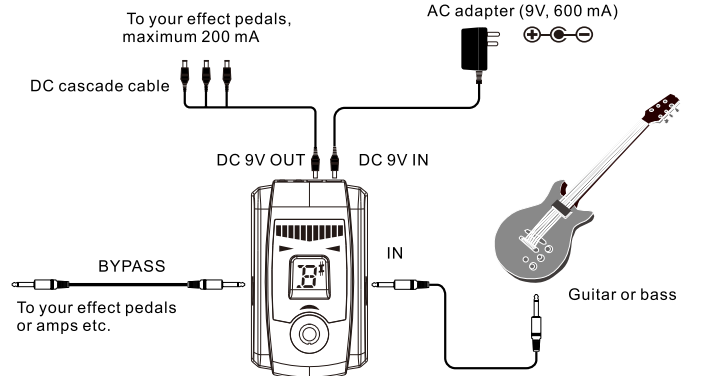

Turn off the power of all devices before you make any connections to avoid damaging your equipments.

■ The INPUT and BYPASS jacks are mono. Stereo (TRS) cables will not work.

INPUT jack

Connect a cable from your instrument to the INPUT jack of the tuner. When connecting, A4 frequency and the display mode will be shown separately for 2 seconds in the note name display and then the BYPASS will be on. The Tuning Guide LED will also light to indicate the display. The left LED is for A4 frequency and the right LED is for display mode.

Note: Connecting a cable to the INPUT jack will turn the power on, but the tuner will not in tuner mode. Press the Tuner ON/OFF switch to engage tuner mode.

■ To conserve battery life, disconnect the cable from the INPUT jack when not in use.

BYPASS jack

Connect a cable from the BYPASS jack to you effect pedals or amp etc.

Note: When the tuner is switched on, the signal from INPUT jack will be muted for silent tuning. The tuner is designed with a True Bypass circuit. When the tuner is off your tone will not be affected by any circuitry.

DC 9V IN jack

If you use an AC adaptor for power, be sure it is 9 volt (9V) and at least 600 mA.

Using other AC adaptor may cause a malfunction or damage.

DC 9V OUT jack

If using an AC adaptor, you can supply power to more than one effect pedal with the DC cascade cable.

■ When using an DC cascade cable, make sure that the total amount of current consumption does not exceed 200 mA, and please check the polarities (±) of all connected effect pedals.

■ Do not connect the AC adaptor to DC 9V OUT jack, which will cause a malfunction or damage.

■ If the tuner is using a battery, you cannot supply power from the DC 9V OUT jack.

IV . BATTERY INSTALLATION

Please replace the battery when the TUNER ON/OFF LED blinks.

- Open the battery cover.
- Connect the battery to the battery cable.
- Make sure the polarity is correct.
- Install the battery and close the cover.

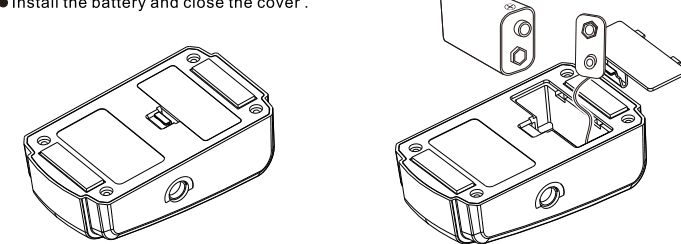

V . TUNER OPERATION

1. Press the TUNER ON/OFF switch to activate the tuner; the TUNER ON/OFF LED will light. Because the tuner has a True Bypass circuit, you can only tune "silently", meaning you will not hear your audio signal through an amp etc.
2. Note: The TUNER ON/OFF switch only functions if an instrument is connected to the INPUT jack.
2. If needed, adjust the calibration and/or select the display mode. The tuner comes from the factory with the calibration set to A4=440 and the tuning mode set to meter mode and it can be adjusted by CALIB Button and Display Button (please check "Frequency Adjustment" "Choosing Display Modes" for a reference).
3. Play a single note on your instrument and tune it so that the desired note appears in the note name display.
4. Tune your instrument using the tuning LED meter. The method for indicating whether your instrument is in tune, sharp or flat depends on which display mode you choose. (please see "Choosing Display Modes" for a reference).
5. After you finish tuning your instrument, press the TUNER ON/OFF switch to turn the tuner off. Now your signal will be heard through your amp etc.

Note: In tuning, when the battery nears the end of its life, the TUNER ON/OFF LED will blink and then please replace the battery. (please see "Battery Installation" for a reference)

VI . BYPASS FUNCTION

Connect a cable from your instrument to the INPUT jack of the tuner, the BYPASS function will be automatically activated. Press the Tuner ON/OFF switch in tuner mode, the BYPASS function will be restored.

VII . FREQUENCY ADJUSTMENT

The tuner comes from the factory with the calibration set to A4=440Hz and it can be adjusted with the range of 436-445Hz

1. Press the CALIB button, the current calibration setting will be shown for 2 seconds in the note name display and in calibration setting, the left side of Tuning Guide LED will light.

2. While the current calibration setting is shown in the note name display, press the CALIB button again to adjust the setting. Each time you press the CALIB button you will cycle through the following settings.

0. 440 Hz, 1. 441 Hz, 2. 442 Hz, 3. 443 Hz, 4. 444 Hz, 5. 445 Hz, 6. 436 Hz, 7. 437 Hz, 8. 438 Hz, 9. 439 Hz

3. When you have made the desired calibration setting, wait approximately two seconds without pressing any buttons. After Tuning Guide LED is off, the new calibration has been set. The tuner will automatically return to tuner mode or Bypass status.

Note: The calibration setting will be remembered even if the power is turned off or restarted. (Please see "Restore to Factory Defaults" for a reference)

VIII . CHOOSING DISPLAY MODES

The tuner allows you to choose one of four display mode settings. The factory setting is Meter mode

1. Press the DISPLAY button. The current setting will be shown for 2 seconds in the note display and in display mode setting, the right side of Tuning Guide LED will light.

2. While the setting is shown in the note name display, press the Display button again to set the display mode. Each time you press the Display button you will cycle through the following four settings.

1. METER
When the note is in tune, the tuning LED meter will turn green and the tuning guide LEDs will light.

If the note is sharp, the LED will be on the right side of the center indicator and if the note is flat, the LED will be on the left side of the Tuning LED meter. The tuning guide LEDs will also indicate if the note is sharp or flat, according to their position in relation to the center. Distance from the center indicates the level of sharpness or flatness.

2. Strobe 1
When the note is in tune, the tuning LED meter will be on and tuning guide LEDs will light. If the note is sharp, the LED meter will move from left to right and if the note is flat, the LED meter will move from right to left. The tuning guide LEDs will also indicate if the note is sharp or flat.

The meter flashing speed indicates the level of sharpness or flatness.

3. Strobe 2
When the note is in tune, the tuning LED meter will turn green and tuning guide LEDs will light.

If the note is sharp, the LED meter will stream from the center out to the right side; if the note is flat, the LED meter will stream from the center out to the left side. The tuning guide LEDs will also indicate if the note is sharp or flat.

The meter flashing speed indicates the level of sharpness or flatness.

4. Strobe 3
When the note is in tune, the tuning LED meter will turn green and tuning guide LEDs will light. If the note is sharp, the right side LEDs will spread from left to right and if the note is flat, the left side LEDs will spread from right to left. The tuning guide LEDs will also indicate if the note is sharp or flat.

The number of lit LEDs will indicate the level of sharpness or flatness.

Note: The display mode setting will be remembered even if the power is turned off or restarted. (Please see "Restore to Factory Defaults" for a reference)

IX . RESTORE TO FACTORY DEFAULTS

The calibration setting and display mode will be remembered even if the power is turned off or restarted. To restore to factory defaults, please connect the tuner to 9V battery or an AC adaptor, press the CALIB or DISPLAY button and plug in the INPUT jack (mono); all stored data will be removed and the tuner will return to the factory defaults: A4 = 440 Hz, DISPLAY MODE = 1

X . SPECIFICATIONS

Tuning range: 0A(27.5Hz)-8C(4186.01Hz)

A4 Frequency: 436Hz-445Hz (1Hz/steps)

Detection accuracy: ±1 cent

Power supply: one 9 V type battery or AC adaptor (9V 600 mA or greater)

Input impedance: 1 M-ohm (tuner on)

Current consumption: maximum 55 mA

Battery life: approximately 5 hours continuous use with tuner on (A4 input continuously, Meter mode)

Weight: 430g(including battery)

Dimensions: 76(W)×120(L)×46(H)mm

XI . ACCESSORIES

- A. Manual
- B. 9V Battery *1

JOYO TECHNOLOGY CO., LTD

Address: 2/F, Lushi Industry Building, 28th District, Bao'an, Shenzhen, 518133 China,

www.joyoaudio.com Email: info@joyoaudio.com Tel: 0086-755-29765381