

# PRODUCT RESOURCE GUIDE 2017-2018

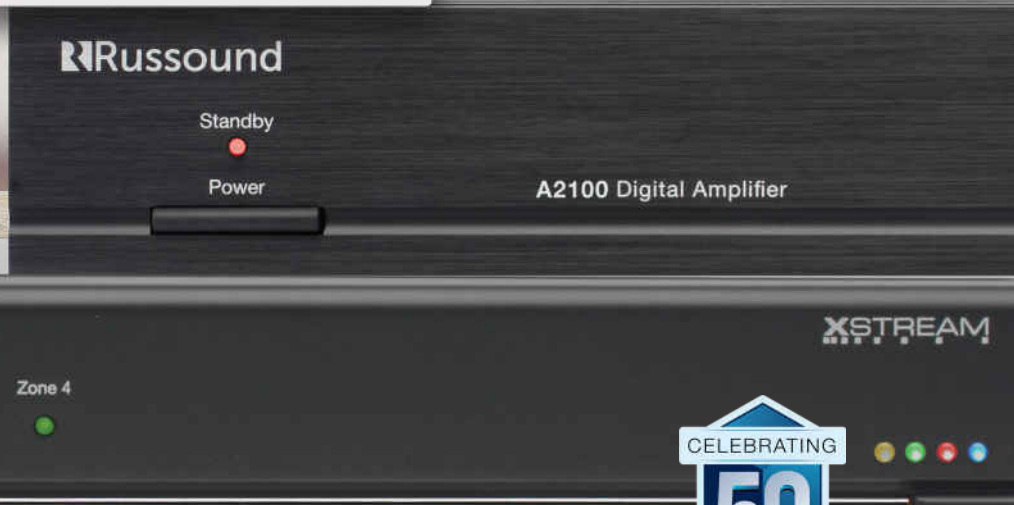

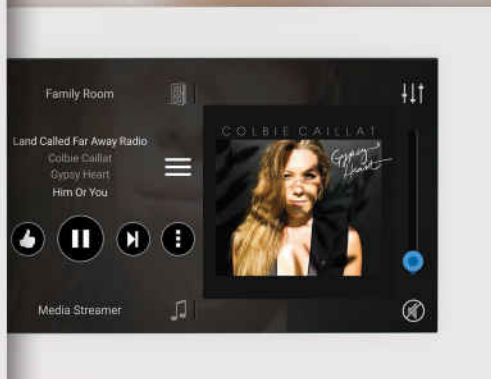
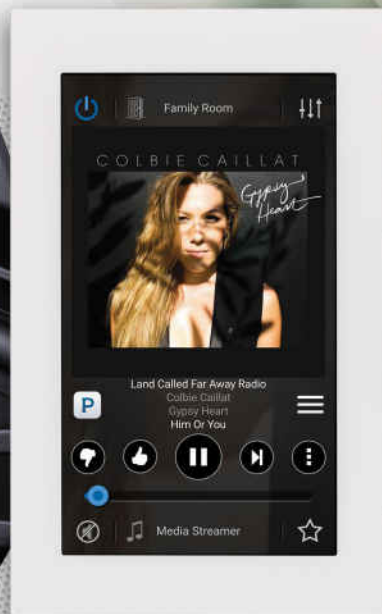

Wow! It's hard to believe that it's been 50 years since Russound introduced the industry's first speaker selection system. A lot has happened since then, but what hasn't changed is our commitment to our customers. By listening to our customers we continue to develop products that both you and your customers value, which has helped make Russound the number one brand in multi-room audio.

Over the years, our product offering has grown and evolved to feature the industry's most complete line of whole-house audio solutions for the residential and light commercial markets. Grouped into three key categories: Sound Integration Electronics; Speakers; and Connectivity & Control Products; you'll find virtually everything you need to distribute and control audio for every one of your installations—from entry level controls to sophisticated streaming media devices. Our products are engineered to deliver years of trouble-free use and are designed to be easy to specify and easy to install, with many of our systems prepackaged for added convenience. Of course, the products are only as good as the company that stands behind them. We provide our dealers with outstanding technical support, training, customer service, and the industry's most extensive warranties.

Building on our tradition of sound innovation, we're excited about the many new product introductions featured here. We think you'll agree and welcome your feedback. As always, we appreciate your business and look forward to serving your needs in the coming years and decades.



Maureen Baldwin, Owner  
maureen@russound.com

Charlie Porritt, CEO  
charliep@russound.com





## COMMERCIAL PRODUCTS

Russound designs and engineers solutions that let our dealers expand their markets to more potential customers



## PREMIUM BUILD QUALITY

Russound products are engineered and built for lasting, trouble-free enjoyment

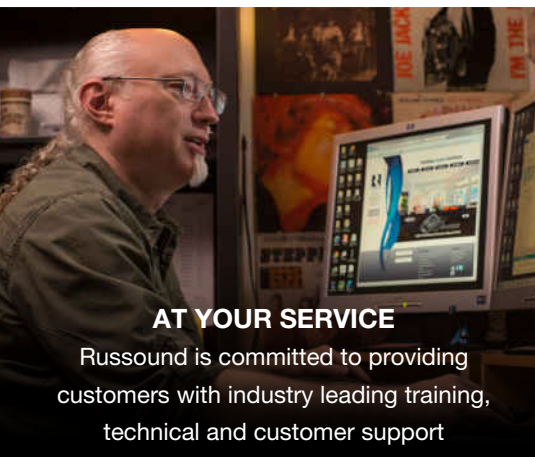

## AT YOUR SERVICE

Russound is committed to providing customers with industry leading training, technical and customer support

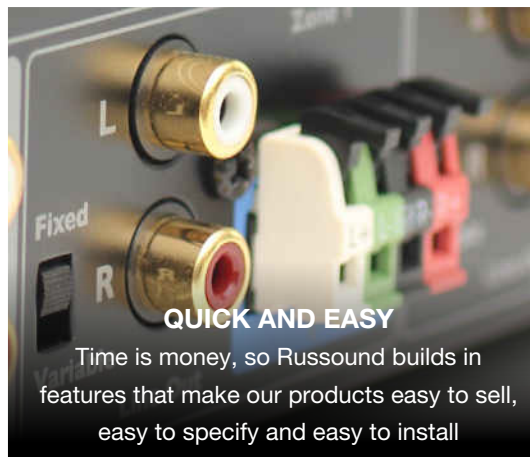

## QUICK AND EASY

Time is money, so Russound builds in features that make our products easy to sell, easy to specify and easy to install



## AT YOUR FINGERTIPS

Russound products are conveniently available through leading distributors throughout the US and globally



## A TRADITION OF SOUND INNOVATION

Russound has been redefining innovation in multi-room audio for nearly five decades

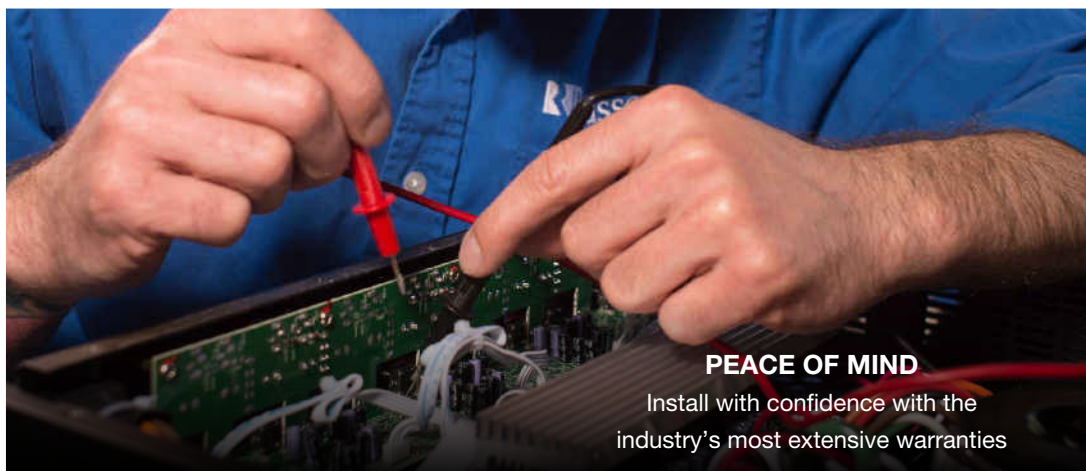

## PEACE OF MIND

Install with confidence with the industry's most extensive warranties

<b>Streamin Audio Systems</b> .....	4
XStream™ Components.....	5
<b>70V/100V Commercial Audio Systems</b> .....	6-7
<b>Advanced Multi-zone</b> .....	8
MCA-Series.....	9-10
RCI Program.....	11-12
Sources.....	13
Control.....	14-15
Accessories.....	16
Wiring Diagrams.....	17-18
<b>Intermediate Multi-zone</b> .....	19-24
CAA66.....	19-20
A-C68.....	21
CA4.....	22
Wiring Diagrams.....	23-24
<b>Simple Multi-zone</b> .....	25

A-BUS Systems.....	26
Wiring Diagrams.....	27
<b>Amplifiers</b> .....	28-30
Wiring Diagrams.....	31
<b>Speakers</b> .....	32-35
<b>Connectivity &amp; Control</b> .....	36
Volume Controls.....	37
Speaker Selectors.....	38
VC & Speaker Selector Wiring Diagrams.....	39-40
IR.....	41
ComPoint Intercom.....	42-43
Plates, Wire & Accessories.....	44
International Convenience Items.....	45
<b>Parts</b> .....	46-47
<b>Commitment &amp; Contact Info</b> .....	48
<b>Warranty</b> .....	49

# Streaming Audio Systems



**XSTREAM™**

## Why Russound for your streaming audio?

As one of the pioneers in multi-room streaming audio solutions, Russound has designed an innovative line of streaming audio products that build on the hallmarks that has made the Russound name famous for 50 years now: reliability, simplicity, and superb sound quality. Whether it's simply incorporating a streaming solution as an audio source, or using standalone audio streaming devices where needed in a home or business, Russound gives you the flexibility to mix and match products to craft the perfect system for your clients.

As the only custom installation company that builds native support for Apple AirPlay into every one of our streaming products, with a passion for supporting Hi Res Audio (24-bit/192kHz) at the same time, Russound offers a unique solution that is not only designed for a custom installation professional, but the Russound Certified Installer program also means that the products can ONLY be installed by a professional guaranteeing that an end user of a Russound RCI product will receive the valuable guidance of a dedicated professional throughout the sales and installation process.

With all of the most popular sources, including Spotify, Pandora, and SiriusXM, as well as the ability to integrate any homeowner's personal music library using DLNA, Russound has your needs covered. For customers who want instant access to control their audio system, Russound offers multiple keypad options including the elegant XTS in-wall touchscreen. To add to the flexibility of the system, Russound has partnered with all of the leaders in home automation and control to integrate our products seamlessly with theirs. Are you with Control4, URC, RTI? We've got you covered with drivers readily available for you so that you can sell the control system you want, with the impressive audio backbone that will delight your customers.



# XStream™ Series Streaming Audio Systems

**XSTREAM™**

## XZone4 Streaming Audio System



### XZone4 Four-Stream, Four-Zone Audio System

The XZone4 incorporates four separate streamers and advanced digital amplification @30 watts per channel, 60 watts per zone to deliver four independent zones of streaming music. It easily connects to an Ethernet network for control and music streaming with support for Hi-Res audio playback. Combine with XTS in-wall touchscreens or use the MyRussound App for iOS/Android to control the system from anywhere in the home.

- Single-box package that is easy to install with simple browser-based configuration, using any smartphone, tablet, or laptop.
- 1U rack-mountable with included rack-mount ears
- Supports up to four zones of audio @60 watts per zone in a home or business, with four independent audio streams, each with built-in Apple AirPlay.
- Easily scale up to 16 total audio zones by linking up one or more of the other XStream series products

**RUSSOUND  
CERTIFIED  
INSTALLER  
REQUIRED**
**Hi-Res  
AUDIO**  
24 bit/192kHz

Dimensions:  
17" W x 9"D x 1.7"H  
(43 x 22.8 x 4.3cm)

Shipping Weight:  
10.6 lbs (4.8 kg)

**4500-536823 XZone4**  
**4500-536908 XZone4i**

## XSource Streaming Audio Player



### XSource Streaming Audio Player

The XSource is a multi-use streaming media solution with a tiny form factor for easy integration with external amplifiers or whole-house receivers. Designed for scalability, the XSource includes native support for high resolution audio, and the full complement of sources available in all of Russound's XStream series of products.

- Integrate a streaming source into any MCA Controller
- Connect to any amplifier or receiver as a streaming audio source with MyRussound App
- Mix and match with other Russound XStream Series products for up to 16 streaming zones
- Great content solution for light commercial jobs with access to SiriusXM for Business
- Built-in Slide Lock System allows coupling of up to 4 units in a single rack width

**Hi-Res  
AUDIO**  
24 bit/192kHz

**RUSSOUND  
CERTIFIED  
INSTALLER  
REQUIRED**
**CE**

Dimensions:  
4"W x 6.375"D x 1.75"H  
(10.2 x 16.2 x 4.4cm) Shipping

Weight:  
2.2lbs (1.0kg)

**4500-536793 XSource**

Mounted with 2 XSource

Mounted with 4 XSource

### Rack Mount Kit for XSource

The Rack Mount Kit for XSource allows for easy installation into any equipment rack. Designed to install with either 2 or 4 XSource units, the Rack Mount Kit for XSource gives custom installation professionals the tool they need to simplify their rack installations and project wiring.

Slide-lock connectors that mate with the XSource's slide-lock connectors mean a secure rack-mount installation that is quick and easy on any jobsite.

Shipping Dimensions:  
12.125"W x 8"D x 2.375"H  
(30 x 20.3 x 6cm)  
Shipping Weight:  
2.5lbs (1.1kg)

**4500-536915 Rack Mount Kit**

# Expand Your Marketplace



As Russound enters its 50th year as a leader in the audio industry, we are proud to announce the newest additions to our lineup that will let you expand your sales marketplace and give you even more opportunities to delight your customers. The light commercial marketplace is one where most of Russound's customers are already competing and installing thousands of audio systems each year. Until now, that has been done by using Russound's residential products in commercial applications and the Russound name is seen in coffee shops, bars, restaurants, yoga studios, gyms, medical offices, retail shops, convenience stores, etc.

With the launch of the new 70V/100V light commercial line, Russound is offering an innovative new mixer amp with a built-in XStream™ streaming audio source for a powerful 300-watt, 1U single-box solution. As part of the Russound Certified Installer program, it is only available to custom installation professionals, enhancing the value that they can provide to their customers. The new 70V/100V speakers that accompany the line were carefully designed not only for impressive audio quality but also for minimizing the time needed for installation, letting our dealers maximize their profit potential on every job.

While designed primarily for the light commercial industry, we are also fully aware that these new additions to our product assortment are also an ideal solution for providing sound to large outdoor areas in residential installations. With their simplified wiring requirements, ease of expansion, and full integration with any other XStream Series product from Russound, they'll soon become your go-to solution for light commercial jobs and for covering all of your outdoor areas for your residential customers.

## 70v/100v Commercial Audio Systems

### XZone70V

#### 70/100V Streaming Mixer Amplifier



The all-in-one solution for all of your light commercial jobs

- 70v/100v/4Ω operation
- Powerful 300W output
- Controllable by the XTS Touchscreen or the MyRussound App
- XStream™ complement of streaming sources including SiriusXM for Business, Spotify, Pandora, AirPlay and more
- Mix and match with other XStream Series components for versatile system designs
- Mic Input with phantom power support
- USB Port for flash-based or hard drive audio
- 3.5mm auxiliary audio input

Dimensions:  
17" W x 9"D x 1.7"H  
(43 x 22.8 x 4.3cm)

Shipping Weight:  
14.55 lbs (6.6 kg)

**4500-536946 XZone70V**  
**4500-536953 XZone70Vi**

### AW70V6

#### 70v Surface Mount Indoor/Outdoor Speakers



Easy to install, easy to adjust, perfect for every job, indoors or out

- 1" Titanium dome tweeter
- Accessible rear-mounted tap setting switch
- 6.5" injection-molded polypropylene woofer with rubber surround
- Tap Settings:  
70V: 7.5W/15W/30W/60W | 100V: 15W/30W/60W | 6Ω
- Ported design for Increased bass
- High quality brass connectors for long-lasting, reliable Installations
- Rustproof aluminum grille
- Dual 1/4" brass posts for 3rd party mounts or security/seismic bolts
- Easy, one-handed mounting
- Available in black or white

Dimensions:  
22.5" W x 11.25"D x 13.5"H  
(57.2 x 28.6 x 34.3cm)

Shipping Weight:  
19 lbs (8.62 kg)

**4700-537004 AW70V6 White**  
**4700-537011 AW70V6 Black**

### ALT-70V-50

#### 50-Watt 70V Volume Control



Ultra-reliable and designed for years of use

- 11 position rotary switch
- 50 Watts RMS
- Screw-down removable connectors accept up to 12ga wire
- Includes white, ivory, and light almond plates and knobs
- Fits standard single-gang boxes

Dimensions:  
4.6" W x 2.8"D x 3.8"H  
(11.7 x 7.1 x 9.7cm)

Shipping Weight:  
0.7 lbs (0.3 kg)

**4700-537028 ALT-70V-50**



# Advanced Multi-zone



## About advanced sound integration electronics

Building on Russound's legendary reliability, simplicity, and sound quality, the new multi-zone controllers now offer increased response time, an array of digital inputs, quicker configuration, and more great content. The evolutionary MCA-88X, an 8-source, 8-zone controller, features built-in XStream™ technology, enabling popular streaming content from the cloud, home network, tablets and phones—all from a single component. The intuitive MyRussound™ App conveniently controls the entire system and displays metadata using tablets and phones. In addition, a wide assortment of keypads, touchscreens and hand-held remotes ensures optimum control for any location.

Engineered for flexible configuration and easy integration, the controllers satisfy any design challenge. The system allows multiple controllers to be combined to create up to 48 independent zones. The new Russound line of multi-zone controllers delivers the perfect balance of popular music content, audio performance, and optimal control.

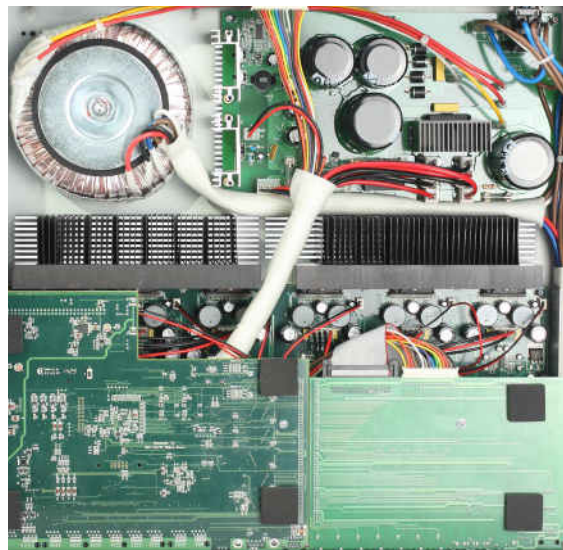



# MCA Advanced Streaming Multi-zone Controllers

## MCA-88X Eight-Source, Eight-Zone Controller Amplifier Streamer

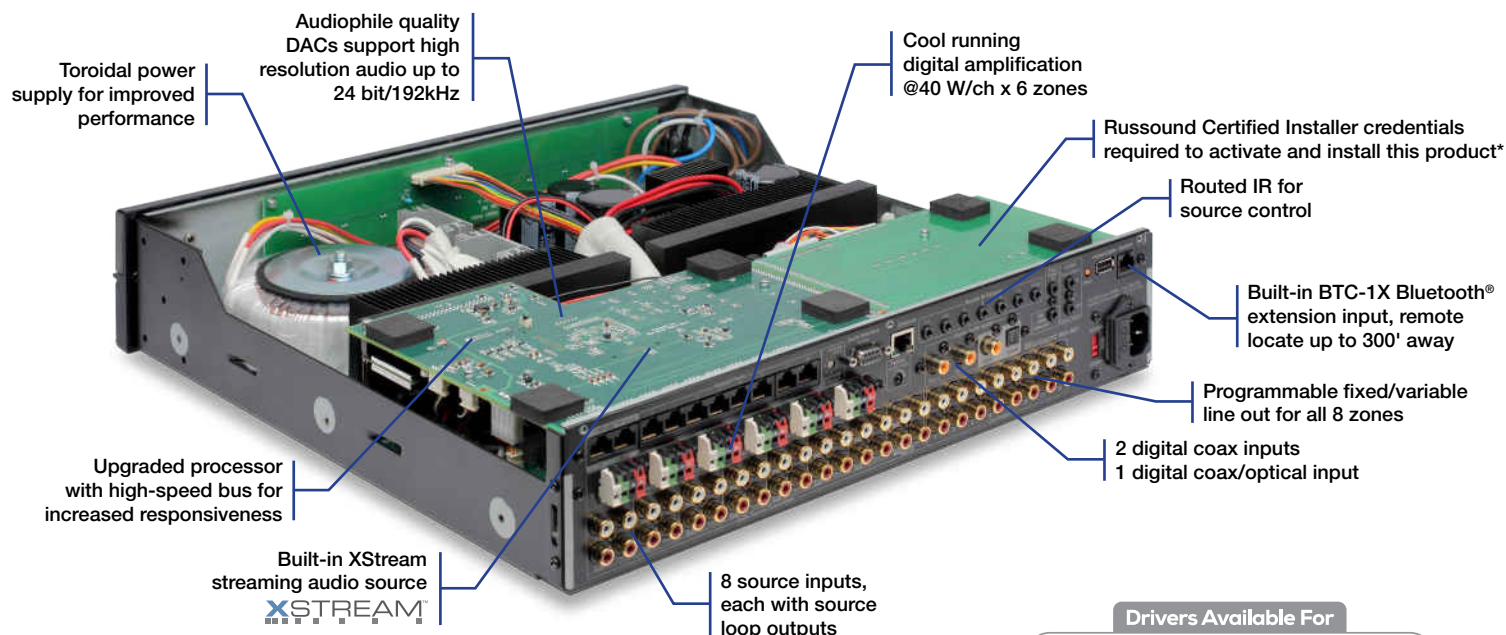

**XSTREAM™**



Built-in Support for Apple AirPlay



24 bit/192kHz

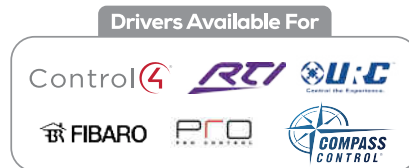

### MCA-88X 8 Source, 8 Zone Controller Amplifier Streamer



The MCA-88X is an 8 source/8 zone controller amplifier. 8 zones of audio with adjustable bass/treble/loudness/balance with digital amplification providing 40W/channel to zones one through six, 8 source inputs with loop outputs and fixed or variable line outputs per zone, routed IR, built-in IR learning, a pre-programmed IR library, paging and system muting. Incorporates a built-in XStream audio streamer to offer the best audio from the internet or a user's personal networked audio collection. Bluetooth ready.



Dimensions:  
17" W x 3.5" H x 17.2" D  
(432 x 90 x 436 mm)

Shipping Weight:  
34.0 lbs (15.4 kg)

1550-536366 MCA-88X  
1550-536427 MCA-88Xi



### KT2-88X Multi-zone Controller Amplifier System Kit with MDK-C6

Includes:

- 6 System Keypads (MDK-C6), White
- Remote Control (USRC)
- Rack ears
- IR emitters
- Wall plates included



Shipping Weight:  
38.4 lbs (17.4 kg)

1550-536458 KT2-88X  
1550-536465 KT2-88Xi

# MCA Advanced Multi-zone Controllers

## MCA-Series Controller Amplifiers



### MCA-88 8 Source, 8 Zone Controller Amplifier

The MCA-88 is an 8 source/8 zone controller amplifier. 8 zones of audio with adjustable bass/treble/loudness/balance with digital amplification providing 40W/channel to zones one through six, 8 source inputs with loop outputs and fixed or variable line outputs per zone, routed IR, built-in IR learning and a pre-programmed IR library, paging and system muting. *Bluetooth* ready.



Dimensions:  
17" W x 3.75" H x 16.2" D  
(432 x 95 x 411 mm)

Shipping Weight:  
34 lbs (15.4 kg)

1550-536359 MCA-88  
1550-536410 MCA-88i



### KT2-88 Multi-zone Controller Amplifier System Kit with MDK-C6

Includes:

- 6 System Keypads (MDK-C6), White
- Remote Control (USRC)
- Rack ears
- IR emitters
- Wall plates included



Shipping Weight:  
38.4 lbs (17.4 kg)

1550-536588 KT2-88



### MCA-66 6 Source, 6 Zone Controller Amplifier

The MCA-66 is a 6 source/6 zone controller amplifier. 6 zones of audio with adjustable bass/treble/loudness/balance with analog amplifiers providing 20W/channel to all 6 zones, 6 source inputs and fixed or variable line outputs for zones 1 and 2, routed IR, built-in IR learning and a preprogrammed IR library, paging (optional source 6) and doorbell muting. *Bluetooth* ready.



Drivers Available For



Dimensions:  
17" W x 3.75" H x 13.5" D  
(432 x 95 x 343 mm)

Shipping Weight:  
25.8 lbs (11.7 kg)

1550-536342 MCA-66  
1550-536403 MCA-66i



### KT2-66 Multi-zone Controller Amplifier System Kit with MDK-C6

Includes:

- 6 System Keypads (MDK-C6), White
- Remote Control (USRC)
- Rack ears
- IR emitters
- Wall plates included



Shipping Weight:  
30 lbs (13.6 kg)

1550-536434 KT2-66  
1550-536441 KT2-66i





# A virtual security team for your business



The Russound Certified Installer (RCI) Program is designed to provide the best possible product and installation experience to our consumers while maximizing the value that the thousands of Russound installers in the US and around the world offer to their customers throughout the sale and installation process. **The RCI program is available to all installers who buy their Russound products through any authorized sales channels,** whether it's through distribution partners or as a direct dealer.

The Russound Certified Installer program has been created so that key Russound products can **only be installed by someone who has been pre-approved by Russound** to do so. With the RCI Program, Russound guarantees that a dedicated Russound Certified Installer is fully involved in the installation process of Russound products. This program will also allow us to better control the supply chain of authorized Russound products properly in the field and minimize the risk of consumers unknowingly purchasing B-stock, obsolete, or gray market goods from unauthorized channels. Visit [www.russound.com/rci](http://www.russound.com/rci) to find out more information.

**Russound®**  
Building Sound Solutions™



# Russound Certified Installer Program



## Program Highlights

- **Supported Products** – The RCI program is integrated into the new line of Russound multi-zone controllers, the MCA-66, MCA-88, MCA-88X, and XStream Series streaming products, the XSource and XZone4.
- **Products ship “locked”** – All products that are part of the RCI program will be shipped from Russound in a locked state. Once they are powered up, they will only be able to display a message saying “Russound Certified Installer Required”. The products will not operate until a Russound Certified Installer connects them to the internet and unlocks them.
- **Easy to unlock** – There is no complex unlocking process. A Russound Certified Installer merely needs to enter their username and password into an RCI product using the web browser on their smartphone, tablet or laptop. All RCI products are internet-enabled and instantly verify the identity of the installer to unlock for use.
- **Distribution Partner customers and Direct Dealers eligible** – The RCI program is available to all installers who buy their Russound products through any authorized sales channels, whether it's through distribution partners or as a direct dealer.
- **Trackable, while assuring customer privacy** – Russound knows how important privacy is to its customers. Because of that, no customer information is ever required, entered, or tracked as part of this program. Russound will track the products used in this program only through a unique electronic product identification number that will be paired with the credential of the specific Russound Certified Installer who performed the installation. Russound will not be able to obtain any private customer information through this program.

## Frequently Asked Questions

### Q: How can I become a Russound Certified Installer (RCI)?

A: It's easy. Use your Russound Portal login to complete this web form to apply to the RCI program. If you currently share a Russound Portal login and need your own, you can get one here.

### Q: How can I verify if I am a Russound Certified Installer?

A: It's easy to tell if you are a Russound Certified Installer. When accessing the Russound Portal, all Russound Certified Installers will see the words “Certified Installer” in the top right corner of all webpages in the Portal.

### Q: Why is Russound “locking” some of its products?

A: This new feature reinforces Russound's commitment to provide the ultimate user experience by guaranteeing that many of our key products are only installed by industry professionals.

### Q: Does Russound collect or track end user information with this program?

A: Russound does not collect any end user personal information.

### Q: How do I stay informed on updates to the RCI program and Russound products?

A: Join our email list by visiting [russound.com](http://russound.com) and clicking on the mail icon at the bottom of the page.

### Q: Do I need to be a direct dealer to be a Russound Certified Installer?

A: The RCI program is available to all installers who purchase their Russound products through an authorized sales channel, whether it's through one of our distribution partners or as a direct dealer.

### Q: All of the installers in my company share a portal login. Can I use that for the RCI program?

A: Since the RCI program certifies installers, not companies, each installer must have their own unique portal login.

### Q: Is there a cost associated with becoming a Russound Certified Installer?

A: There is no charge to installers for becoming Russound Certified Installers.



## Sources for Advanced Controllers



### BTC-1X Bluetooth® Remote Transceiver

Simply plug the BTC-1X into the *Bluetooth* input of any Russound *Bluetooth* ready controller (such as MCA-88X, MCA-88 or MCA-66) to add *Bluetooth* streaming audio. Remote transceiver allows for optimum placement via CAT-5 wire up to 300' (91.4m). High quality audio codec featuring aptX® for superior *Bluetooth* audio quality. Micro-USB programming cable is included.

Dimensions:  
2.2"W x 2.8"D x 1.0"H  
(5.6 x 7.0 x 2.6 cm)

Shipping Weight:  
0.3lbs (0.14kg)

2460-533709 BTC-1X



### BSK-1 Bluetooth Source Kit

The BSK-1 *Bluetooth* Source Kit permits *Bluetooth* enabled devices to stream content to **any audio system** for wireless audio. It offers a remotely located *Bluetooth* receiver, optimized for ideal placement and range by the custom installer. The receiver is connected with CAT-5 wire and may be extended up to 300' (91.4m)

BTC-1 Dimensions:  
4.8"W x 2"D x 1.5"H  
(122 x 51 x 38mm)

BTC-1X Dimensions:  
2.2"W x 2.8"D x 1.0"H  
(5.6 x 7.0 x 2.6 cm)

Shipping Weight:  
0.4lbs (0.2kg)

2460-533778 BSK1  
2460-533792 BSK1e



Applications for BSK-1 Kit:

- *Bluetooth* audio solution for any audio system
- Integrating *Bluetooth* into a Russound C-Series system
- When adding additional *Bluetooth* inputs to a Russound MCA-Series system



### ST1 Smart Tuner

The ST1 is a single AM/FM tuner with RDS. Works with MCA-Series controllers. 6 banks of 6 presets. Half rack width for side by side installation. Built-in 110-240V AC power supply. Rack-mount ears included.

Dimensions:  
8.5"W x 10.5"D x 1.75"H  
(21.6 x 26.7 x 4.5 cm)

Shipping Weight:  
ST1 7.9lbs (3.6kg)  
ST1e 8.9lbs (4.0kg)

2410-533662 ST1  
2410-533730 ST1e



## Advanced Multi-zone System Control



### MyRussound App

Control your Russound XStream Series, MCA-Series or C-Series system and all connected sources from the comfort of your iPad, iPhone, iPod touch or Android device. The MyRussound app offers seamless integration and effortless control for compatible Russound systems. Simply download the MyRussound app from the iTunes store or Google Play store.

MyRussound is only compatible with the MCA-66, MCA-88, MCA-88X, MCA-C3 and MCA-C5 controllers and the XStream™ Series products: XSource and the XZone4.

- Auto-discovery of Russound devices on the network
- Intuitive control of any zone in a system
- Source metadata including Album Art for compatible sources
- Easy Content browsing



### XTS Wall-Mounted Color Touchscreen

The in-wall App from Russound! The XTS Touchscreen is a stylish in-wall touchscreen that runs an embedded version of the popular MyRussound™ App.

By placing the powerful MyRussound app in a permanent location on a wall, the XTS gives you full and easy control of your Russound system, eliminating the need to use your phone or tablet to simply change the volume or change the music.

- Elegant in-wall touchscreen with high resolution 4.7" screen
- Runs the popular MyRussound App
- Works exclusively with Russound MCA-Series Controllers, XStream Series systems and legacy C-Series Controllers

• Mounts in a 1-gang box. POE Powered or 12V (not included)

Dimensions:  
3.2"W x 1.34"D x 5.18"H  
(81.3 x 34.0 x 131.6 mm)

Shipping Weight: 0.6 lbs (.3 kg)

**2620-536601 XTS**



### MDK-C6 Multiline Display Keypad

Wall-mounted, double-gang keypad for the MCA-Series. 2.75" diagonal, high-resolution gray scale LCD screen displays real-time system information. Responsive hard buttons provide easy navigation of sources and content. Adjustable brightness, volume, bass, treble, and balance. Access to source selection and control, party mode, all off/on, and alarm and sleep timer. RJ-45 connection. Includes wall plate.



Dimensions:  
4.5" W x 4.5" H (114 x 114 mm)

Shipping Weight: 1 lb (454 g)

**1550-534294 MDK-C6**



### MDK-C6 CONV Color Conversion Kit

Includes 1 Trim Plate, 1 Keypad Bezel and 13 Buttons.

Shipping Weight: 4 oz (114 g)

**1550-534430 White**

**1550-534447 Lt. Almond**

**1550-534423 Almond**

**1550-534393 Black**



### SWP-S21 MDK-C6 with 1 gang

Cover Plate for MDK-C6 with space for an additional single-gang component.

Shipping Weight: 2 oz (0.071 kg)

**7106-526831 White**

**7106-528439 Almond**

**7106-528477 Bone**

**7106-528484 Brown**

**7106-528491 Black**



## Advanced Multi-zone System Control



### **SLK-1** Single Line Keypad

Wall-mounted, single-gang keypad designed for individual zone control of MCA-Series . Wall plate not included.



Dimensions:  
1.85" W x 2.7" D x 1.47" H  
(47 x 69 x 37 mm)

Shipping Weight:  
4.0 oz (113 g)

**1550-534300 SLK-1**



### **USRC** Universal System Remote Control

The USRC Remote Control is the complete solution for all of your remote control requirements. It is designed to operate source devices as well as all Russound and A-BUS audio system keypads.



Dimensions:  
2"W x 7.75"H x 1.125"D  
(5 x 19.7 x 2.9cm)

Shipping Weight 1 lb (.45 kg)

**1700-535000 USRC**

## Advanced Multi-zone System Accessories



### SA-ZX3 Keypad Splitter

Increases power output for connecting up to 3 system keypads to one keypad input on a Russound RNET Controller Amplifier. Includes: 1 RJ-45 input jack, 3 RJ-45 keypad jacks, 1 1201A 12V power supply.



Dimensions:  
3.25" W x 1.875" H x 1.0" D  
(83 x 47 x 25mm)

Shipping Weight: 4 oz (.11 kg)

**2500-120176 SA-ZX3, with power supply**  
**2500-120497 SA-ZX3, w/o power supply**



### Advanced Programming Cable

For KP4, KP6, KPL keypads, ComPoint components, iBridge Dock, BTC-1X. Female DB-9 connection (PC end) and flat device pin connection (device end).

Length: 72" (182.9 cm)

Shipping Weight 1 lb (0.45 kg)

**2500-521065**



### KNX-RIO-1 Russound KNX to RIO Gateway

Allows KNX keypads and panels to operate Russound controllers via RIO protocol. Connection to the local LAN for IP control. Supports up to 16 zones, 8 sources and 32 System Favorites. Supports Source Metadata: Source Name, Channel, Playlist, Artist and Song Title. Standard KNX bus connection



Dimensions:  
3.6" H x 1.4" W x 2.4" D  
(91.4 x 5.6 x 61 mm)

Shipping Weight: 1.6 oz (45g)

**1550-536564 KNX-RIO-1**





# MCA-88/XSource Wiring Diagram

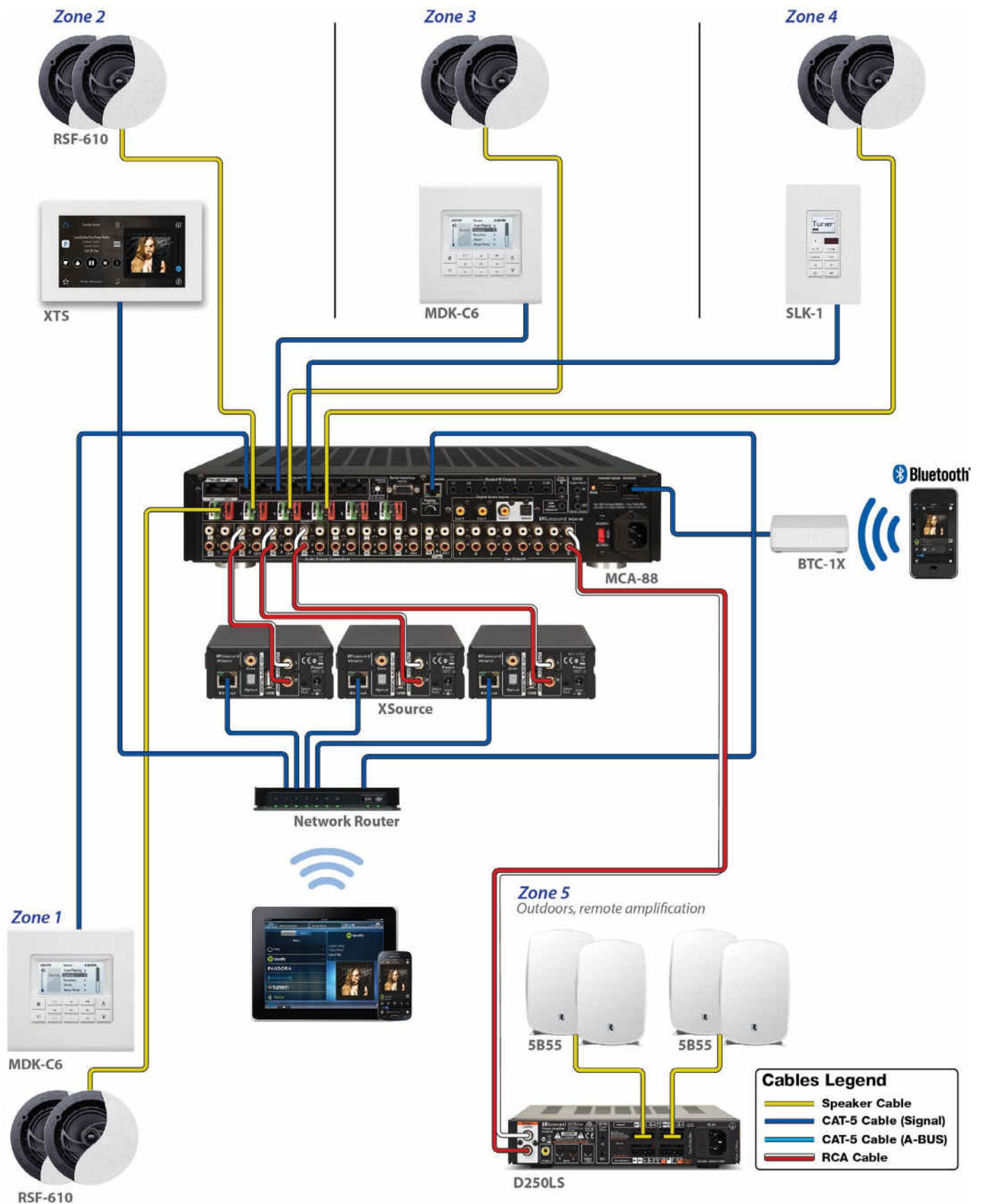

## MCA-66

# Intermediate Multi-zone

## About intermediate sound integration electronics

**Products to match your lifestyle.** Music anywhere you want it, at the touch of a button. Our intermediate multi-zone solutions contain features that allow installers more customization options than our simpler systems.

### Intermediate System Features\*:

- RS-232 ports for custom integration
- Source loop outputs
- Paging
- Routed IR output
- Built-in IR libraries
- Tone controls
- Party modes

## CAA66 System



### CAA66 Controller Amplifier

6 zones (40W/zone), front panel programming center, built-in IR learning, rear RS-232 serial port, extensive built-in IR library, controller link in and out, color-coded detachable 14-gauge snap connectors, rack-mount 2-unit high. 6 IR emitters with controller only, no keypads. Rack ears included.

Dimensions:  
17" W x 12" D x 3.5" H  
(432 x 305 x 89 mm)

Shipping Weight:  
23 lbs (10.4 kg)

1210-524882 CAA66





## CAA66 System



### CAA66K Controller Amplifier Kits

Includes:

- 6 white KP6 single-gang keypads
- System remote control
- Amplifier controller
- Wall plates not included

Dimensions:  
17" W x 12" D x 3.5" H  
(432 x 305 x 89 mm)

Shipping Weight: 29 lbs (13.2 kg)

**1210-528354 CAA66K**



### CAA66L Controller Amplifier Kits

Includes:

- 6 white KPL single-gang keypads with LCD
- System remote control
- Amplifier controller
- Wall plates not included

Dimensions:  
17" W x 12" D x 3.5" H  
(432 x 305 x 89 mm)

Shipping Weight: 29 lbs (13.2 kg)

**1210-528347 CAA66L**



### KPL LCD Keypad

In-wall Decora® style single-gang keypad featuring backlit LCD panel, amber backlit soft-touch buttons, assignable source names, IR pass-through, 110 punch-down connector, system status feedback, user adjustable zone bass, treble, loudness and balance. Wall plate not included.

Dimensions:  
1.85" W x 2.7" D x 1.47" H  
(47 x 69 x 37 mm)

Shipping Weight: 4.0 oz (113 g)

**1210-528385 KPL**



### KP6 System Keypad

In-wall Decora style single-gang keypad featuring amber backlit soft-touch buttons, 20 source name labels, source selection, plus IR pass-through and confirmation. 110 punch-down connector, installer adjustable zone bass, treble, loudness and balance. Wall plate not included.

Dimensions:  
1.85" W x 2.7" D x 1.47" H  
(47 x 69 x 37 mm)

Shipping Weight: 4.0 oz (113 g)

**1210-528392 KP6**



### KPSC Optional Source Control Keypad (for KP6 or KPL)

In-wall Decora style single-gang keypad accessory adds source control and numeric control capability to KPL keypads. The keypad has amber backlit soft-touch buttons. This is not a standalone keypad. Wall plate not included.

Dimensions:  
1.85" W x 2.7" D x 1" H  
(47 x 69 x 25 mm)

Shipping Weight: 3 oz (85 g)

**1210-528415 KPSC**

## CA4 Intermediate System



### CA4 Multi-zone Controller

4 source/4 zone rack mountable, source grouping, party mode, 1-U high, 4 zones at 30W/zone, rear RS-232 port, RJ-45 expander jack, 4 single IR emitters. Fixed and variable line output (Zone 4 only). CA4-WP and Rack ears included.

Dimensions:  
16.9"W x 2"H x 8.75"D  
(43 x 5 x 22.3 cm)

Shipping Weight: 11 lbs (5.0 kg)

**1200-529689 CA4**  
**1200-532429 CA4-EU/UK**



### CA4-KT1 Multi-room Controller System Kit

Includes:

- Controller (CA4)
- 4 System Keypads (CA4-KP)
- Wall Port (CA4-WP)
- 4 IR Emitters
- System Remote Control (USRC)
- Rack Ears
- Wall plates not included

Shipping Weight: 14.60 lbs (6.6 kg)

**1200-530418 CA4-KT1**  
**1200-532412 CA4-KT1-EU/UK**



### CA4-KP System Keypad

Single-gang, in-wall Decora® style keypad for control of a CA4 multi-zone audio system. 1 RJ-45 connection. Wall plate not included.



Dimensions:  
1.75"W x 2.875"H x 1.25"D  
(45 x 73 x 31.8 mm)

Shipping Weight: 0.2 lbs (0.1 kg)

**1200-529696 CA4-KP White**



### CA4-WP Wall Port

Single-gang, in-wall port for connection of a CA4 multi-zone controller to four CA4-KP zone keypads and four pairs of speakers. 4 RJ-45 inputs, 4 RJ-45 keypad outputs, 4 speaker terminal pairs. Wall plate not included.



Dimensions:  
1.75"W x 2.875"H x 1.25"D  
(45 x 73 x 31.8 mm)

Shipping Weight: 0.3 lbs (0.1 kg)

**1200-529719 CA4-WP White**



### USRC Universal System Remote Control

The USRC Remote Control is the complete solution for all of your remote control requirements. It is designed to operate source devices and all Russound and A-BUS audio system keypads.



Dimensions:  
2"W x 7.75"H x 1.125"D  
(5 x 19.7 x 2.9 cm)

Shipping Weight 1 lb (.45 kg)

**1700-535000 USRC**

## CAA66 System Diagram

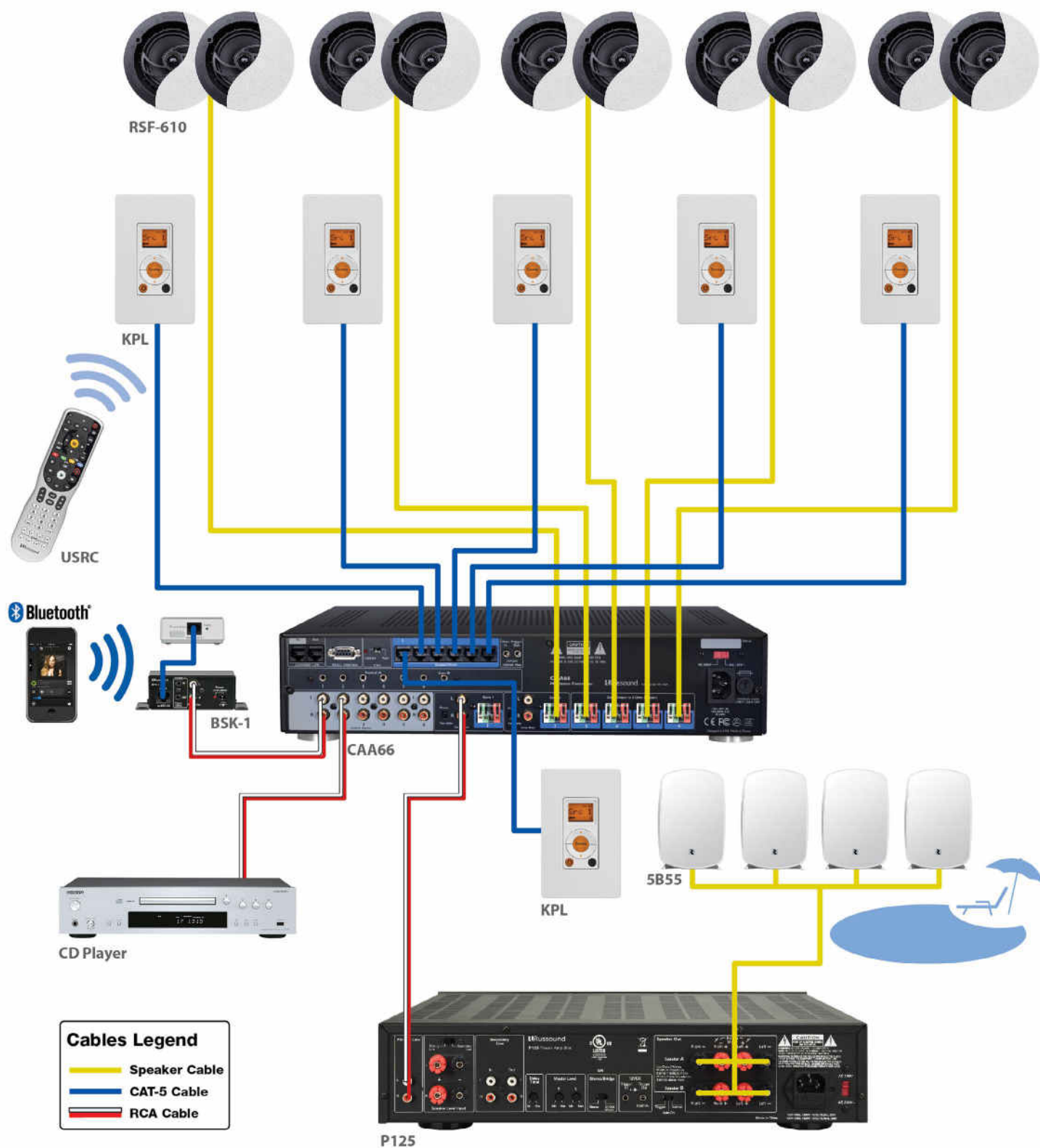



## CA4 System Diagram

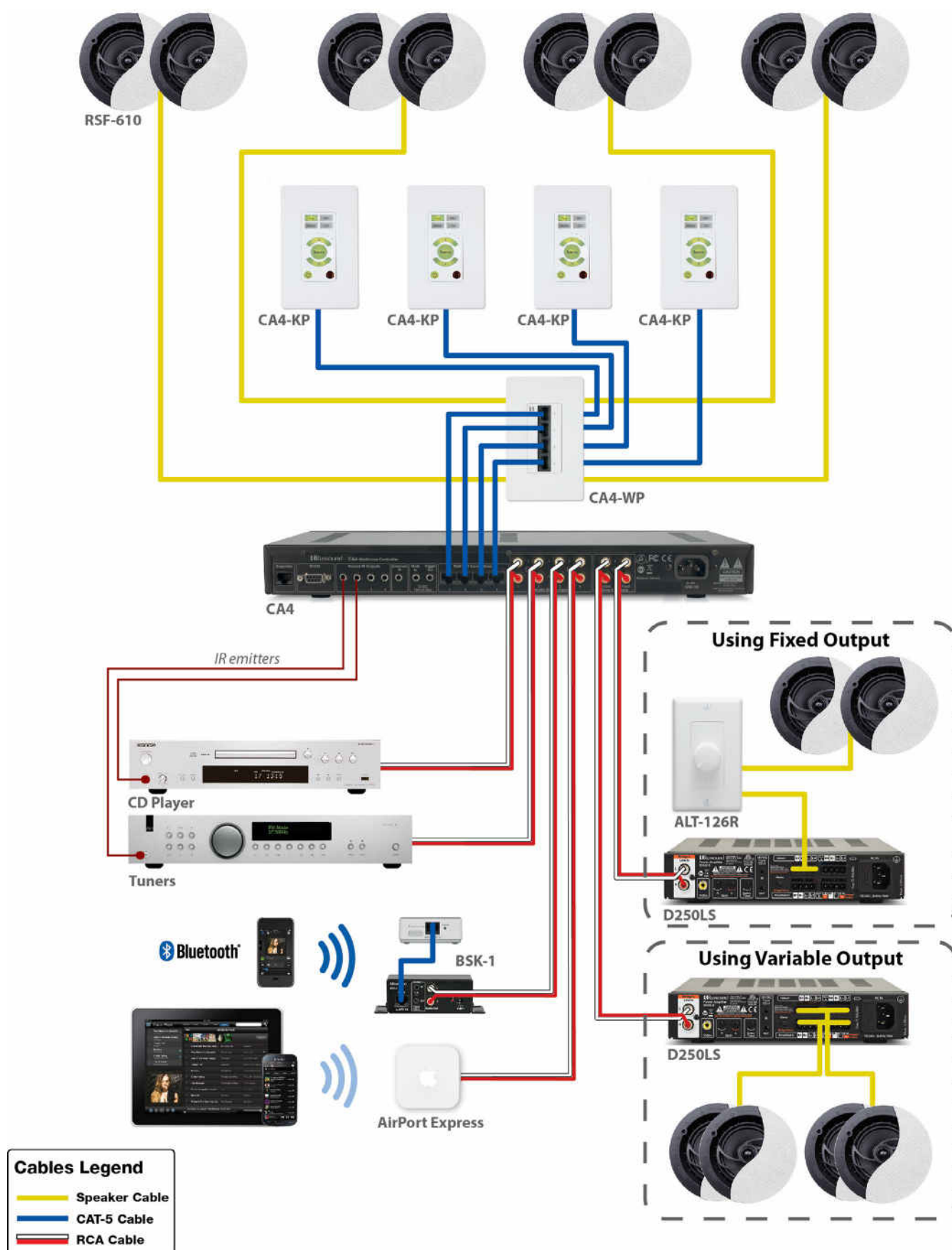

# Simple Multi-zone

## A-BUS®: Simple, Modular, Powerful

Russound's simple multi-zone solutions are based on A-BUS technology—the embodiment of simplicity. Designed for exceptional ease of use, our systems are flexible and modular. From single source systems that allow you to share music throughout your home to basic multi-source systems that provide multiple music sources in different locations, Russound offers solutions for any home.

From source components to amplified keypads, an A-BUS system installs easily using CAT-5 cable. Installation, whether in new construction or an existing home, is a snap. The modular design of A-BUS components makes future system expansion painless. Add additional A-BUS hubs or controllers to increase the number of system zones.

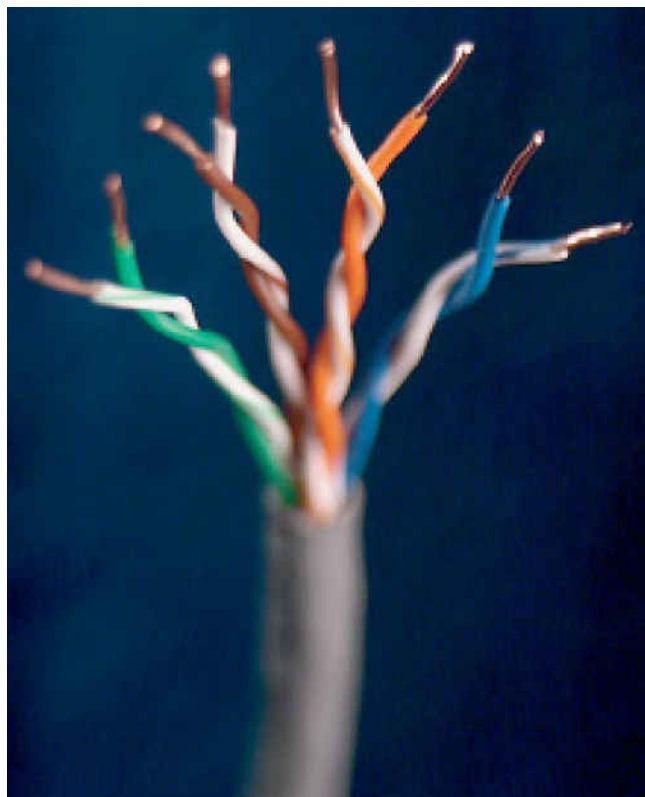

# Simple A-BUS Systems



## A-H484 4 Source/4 Zone Surface Mount Hub

4 pairs of gold plated audio RCA jacks, 4 routed IR emitter jacks, common IR jack, 8 RJ-45 keypad connectors, 12V trigger output, 2 power supply jacks. Requires A-PS power supply (Sold separately).



Dimensions:  
6.5" W x 5" H x 1.5" D  
(165 x 127 x 38 mm)

Shipping Weight: 2.25 lbs (1.0 kg)

2000-115882 A-H484



## A-H4 1 Source/4 Zone Surface Mount Hub

Gold plated audio input/output RCA jacks, 4 IR emitter jacks, 4 RJ-45 keypad connectors, RJ-45 IR link input and output, IR confirmation LED. Requires A-PS power supply (Sold separately).



Dimensions: 6.5" W x 3" H x 1.225" D (165 x 76 x 32 mm)

Shipping Weight: 9 oz (255 g)

2000-115851 A-H4



## A-H4D In-Wall 1 Source/4 Zone Hub

Fits in a standard double gang work box. Gold plated audio input and output RCA jacks, 4 IR emitter jacks, 110 punch-down terminals, 24 VDC power and 12 VDC status jacks. Requires A-PS power supply (Sold separately). Wall plate not included.



Dimensions:  
3.625" W x 4.125" H x 1.125" D  
(9.2 x 10.5 x 4.8 cm)

Shipping Weight: 5 oz (.14kg)

2000-528224 A-H4D White/Almond  
See pg 48 for more colors



## A-H2 1 Source/2 Zone Surface Mount Hub

Gold plated audio input RCA jacks, 4 IR emitter jacks, 2 RJ-45 keypad connectors, 1 Expansion input, IR confirmation LED. Requires A-PS power supply (Sold separately).



Dimensions:  
6.5" W x 2" H x 1.5" D (165 x 51 x 38 mm)

Shipping Weight: 7 oz (198 g)

2000-115837 A-H2



## A-K4

### Amplified Keypad

Analog amp, IR receiver, pre-amp outputs, left and right gain controls with RJ-45 connector. Wall plate not included.



Dimensions:  
1.75"W x 2.875"H x 1.75"D  
(45 x 73 x 45mm)

Shipping Weight 0.4 lb (0.18 kg)

2000-534591 A-K4 White



## A-LC3

### Local Source Input

IR emitter for local source control, auto sensing to override audio, wires in line with CAT-5 between hub or controller and keypad. Wall plate not included.



Dimensions:  
1.75"W x 2.875"H x 1.75"D  
(45 x 73 x 45mm)

Shipping Weight 0.4 lb (0.18 kg)

2000-527456 A-LC3 White  
See pg 48 for more colors



## BTA-2 A-BUS

### Bluetooth® Module

Wires in line with CAT-5 between hub or controller and keypad. The A-BUS Bluetooth receiver streams content to the local A-BUS keypad. High quality aptX audio codec. Works with A-K4 and A-K6L. Wall plate not included.



Dimensions:  
1.75"W x 2.875"H x 1.75"D  
(45 x 73 x 45mm)

Shipping Weight: 0.4 lbs (0.18 kg)

2460-536595 BTA-2



## USRC Universal System Remote Control

The USRC Remote Control is the complete solution for all of your remote control requirements. It is designed to operate source devices and all Russound and A-BUS audio system keypads.



Dimensions:  
2"W x 7.75"H x 1.125"D  
(5 x 19.7 x 2.9 cm)

Shipping Weight: 1 lb (.45 kg)



## A-PS Power Supply

24 Volt DC. Features auto-sensing 110/220 voltage, detachable power cord, and compact size.



Dimensions:  
6.5" W x 2.75" H x 3.75" D  
(165.5 x 70 x 95.5 mm)

Shipping Weight: 1.25 lbs (0.57 kg)

2000-113833 A-PS  
2000-114557 A-PS-EU



## A-BUS Multi-Source Diagram

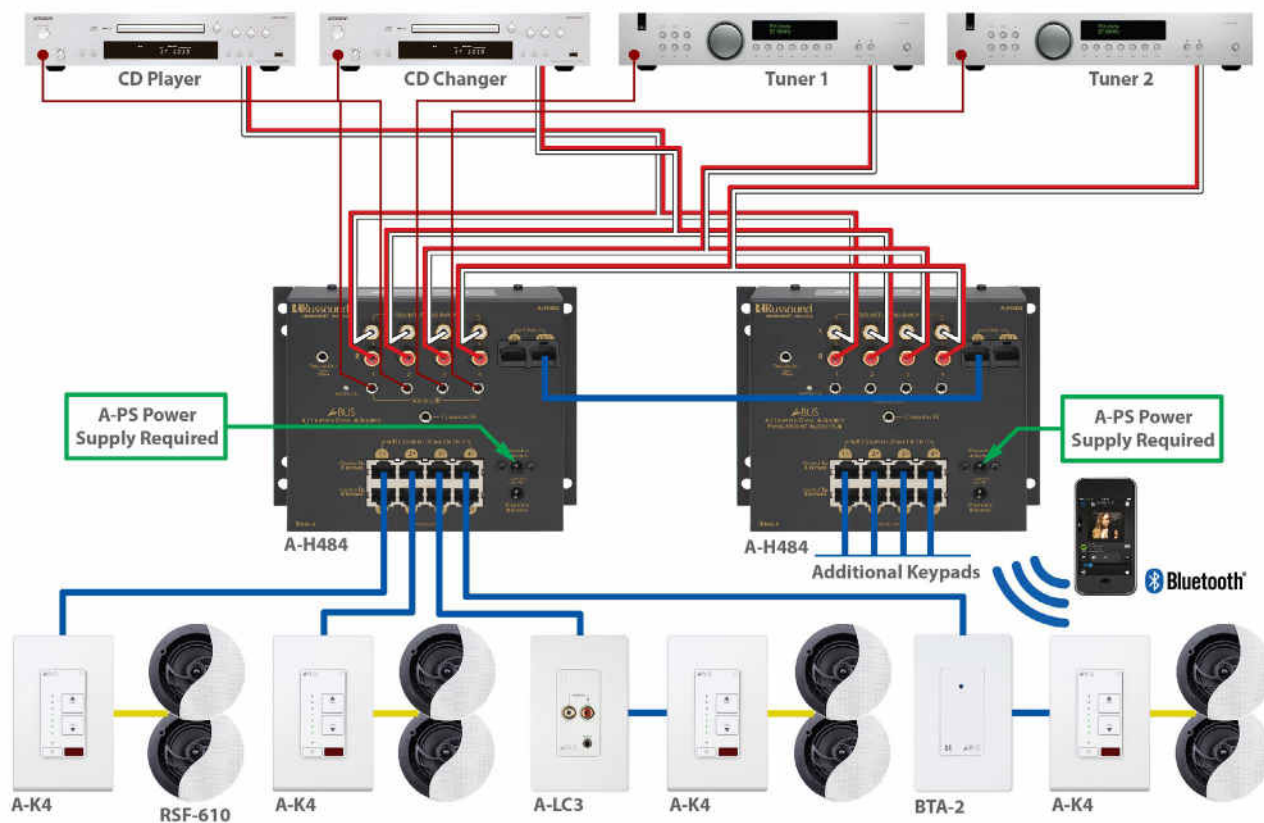

## A-BUS Single Source Diagram

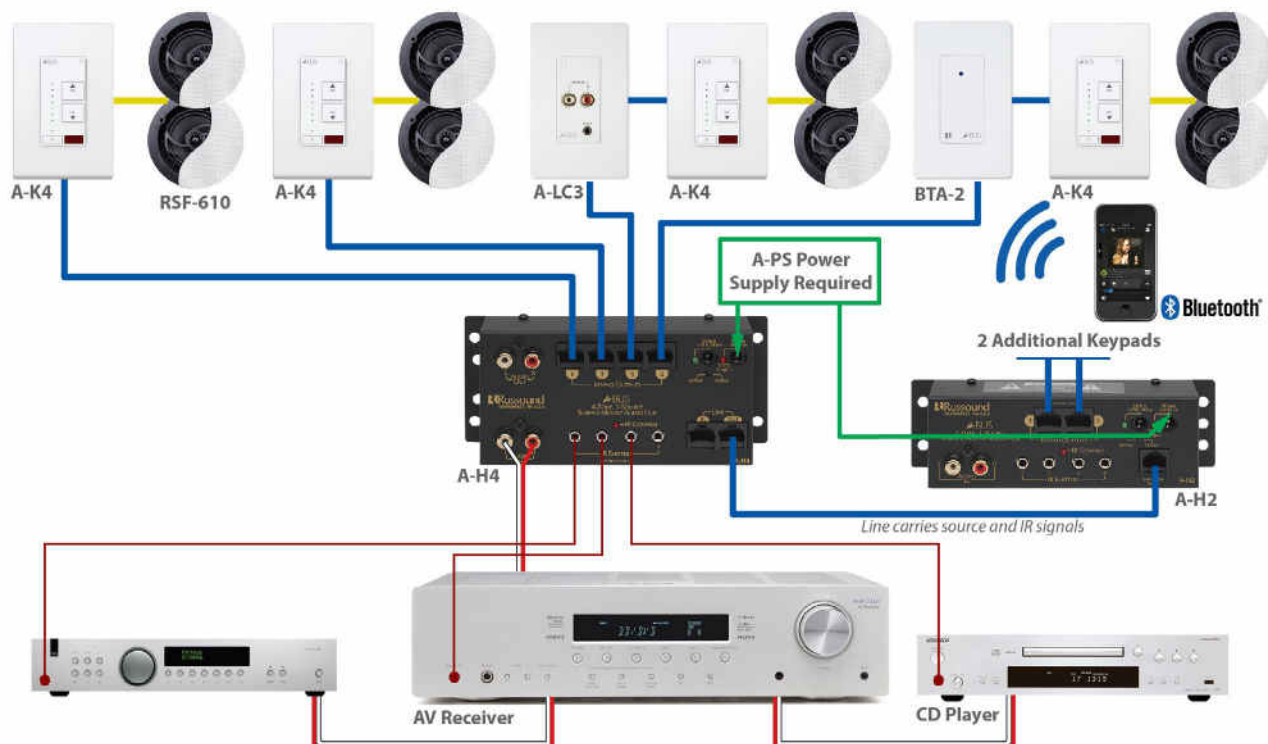

# Amplifiers



## Amplifiers With Features for the Custom Installer

Audio amplifiers are the muscle behind every home music system. Russound puts great pride and effort into building stereo and multi-room amplifiers that supply years of problem-free service.

Russound engineers embarked on designing our amplifiers to meet the demands of multi-room audio systems: seamless integration, bulletproof reliability and astonishing fidelity. Built to complement an extensive array of audio systems, these versatile products deliver outstanding performance under the most demanding conditions.



## Professional Multi-Channel Amplifiers



### D1650 Sixteen-Channel Digital Amplifier

- High efficiency, cool running digital amplification
- 50W/ch @8ohm, 80W/ch @4ohm
- Bridgeable: 160W mono @8ohm
- Global bus input, independent inputs per zone
- Trim level adjustment per channel
- Global trigger input/output
- Independent trigger input/output per zone
- Audio sensing per zone
- Auto-switching delay settings per zone
- Rackmountable

Dimensions:  
19.125" W (with rack ears)  
x 16.81" D x 3.875" H  
(45.6 x 42.7 x 9.9 cm)

Shipping Weight:  
28.8 lbs (13.1 kg)

**2800-536229 D1650**  
**2800-536380 D1650i**



### D850 Eight-Channel Digital Amplifier

- High efficiency, cool running digital amplification
- 50W/ch @8ohm, 80W/ch @4ohm
- Bridgeable: 160W mono @8ohm
- Global bus input, independent inputs per zone
- Trim level adjustment per channel
- Global trigger input/output
- Independent trigger input/output per zone
- Audio sensing per zone
- Auto-switching delay settings per zone
- Rackmountable

Dimensions:  
19.125" W (with rack ears)  
x 16.81" D x 3.875" H  
(45.6 x 42.7 x 9.9 cm)

Shipping Weight:  
24.6 lbs (11.2 kg)

**2800-536236 D850**  
**2800-536397 D850i**



## Professional Two-Channel Amplifiers



### D250LS 2-Channel Digital Amplifier

Auto-sensing enables localized speaker override for a connected peripheral, such as a TV or PC. Rated 50W/channel RMS at 8 ohms or 75W/channel RMS at 4 ohms. The bridgeable power setting combines channel power for 125W into a single 8-ohm load. 1U 1/2 rack chassis has three mounting options (included).

Dimensions:  
8.5" W x 10.5" D x 1.75" H  
(215.9 x 266.7 x 44.5 mm)

Shipping Weight:  
10 lbs (4.5 kg)

**2800-533280 D250LS**  
**2800-533297 D250LS-EU/UK**



### A2100 Digital Amplifier

The powerful 100-watt class D amplifier in the A2100 is combined with features such as 12v trigger control, audio sensing, volume gain adjustment, and a buffered line output that enables even more amplification of the same audio signal when needed. 1U 1/2 rack chassis has three mounting options (included).

Dimensions:  
8.5" W x 10.5" D x 1.75" H  
(215.9 x 266.7 x 44.5 mm)

Shipping Weight:  
4.10 lbs (1.9 kg)

**2800-536847 A2100**  
**2800-536960 A2100i**





### P125 Two-Channel, 125W, Dual Source Amplifier

- High-current, high-power output
- Auto-switching dual source inputs
- A/B speaker pair selection from front panel
- 80W/ch @8ohm, 125W/ch @4ohm
- Bridgeable: 250W mono @8ohm
- Advanced thermal and short circuit protection
- Front panel volume and balance controls
- Auto turn-on via signal sensing or 12V trigger
- 12V trigger output



Dimensions:  
16.5" W x 13.75" D x 3.5" H  
(41.9 x 20.3 x 6.4 cm)

Shipping Weight:  
31.4 lbs (14.24 kg)

**2800-536274 P125**

**Not available to countries requiring CE certification.**



### P75 Two-Channel, 75W, Dual Source Amplifier

- High-current, high-power output
- Auto-switching dual source inputs
- A/B speaker pair selection from front panel
- Rear panel unswitched AC outlet
- 60W/ch @8ohm, 75W/ch @4ohm
- Bridgeable: 160W mono @8ohm
- Advanced thermal and short circuit protection
- Front panel volume and balance controls



Dimensions:  
16.5" W x 8" D x 2.5" H  
(41.9 x 20.3 x 6.4 cm)

Shipping Weight:  
11 lbs (5.22 kg)

**2800-536267 P75**

**Not available to countries requiring CE certification. 110V Only.**

## TV Amplifiers



### TVA2.1 Digital Two-Channel TV Amplifier with IR learning and Sub Out

Designed expressly for integrating with flat panel televisions, the TVA2.1 delivers smooth, robust sound for an enhanced viewing experience. On-board IR learning allows its volume to be seamlessly controlled by the TV or cable box's remote control.

- 35W/ch for enhanced TV audio
- Easily mounts behind TVs or in structured wiring cans
- 24-bit/96kHz S/PDIF; optical and analog line-level inputs
- Includes SLM-1 Slim Surface Mount IR Receiver
- IR learning for use with virtually any remote control
- Integrated Subwoofer output



Dimensions:  
9.875" W x 1.2" D x 5.75" H  
(25 x 3 x 14.6 cm)

Shipping Weight:  
1.8 lbs (0.8 kg)

**2800-536304 TVA2.1**  
**2800-536861 TVA2.1i**

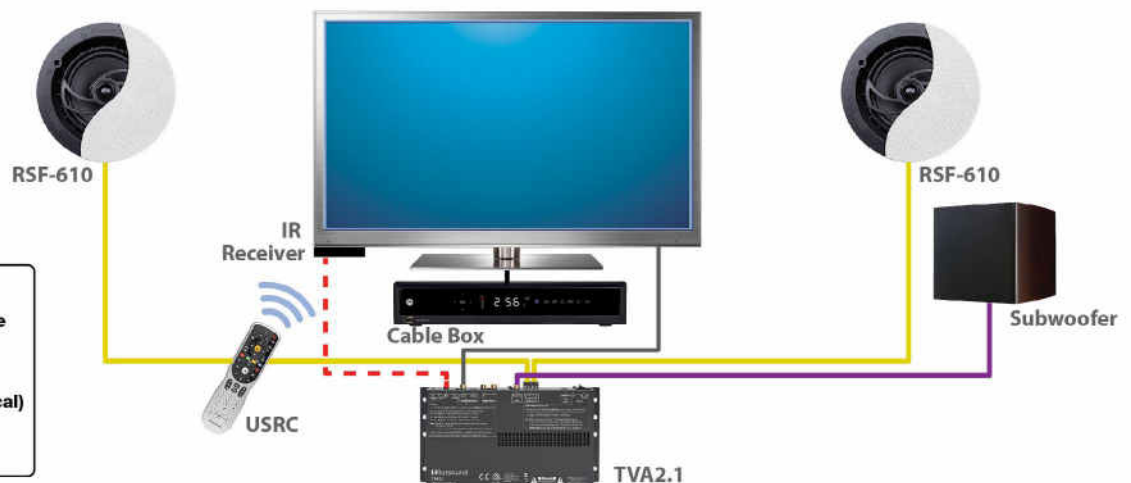
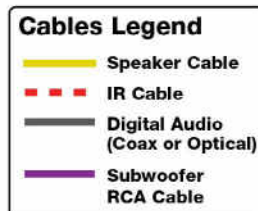

## Amplifier Wiring Diagrams

Zone-specific controller expansion

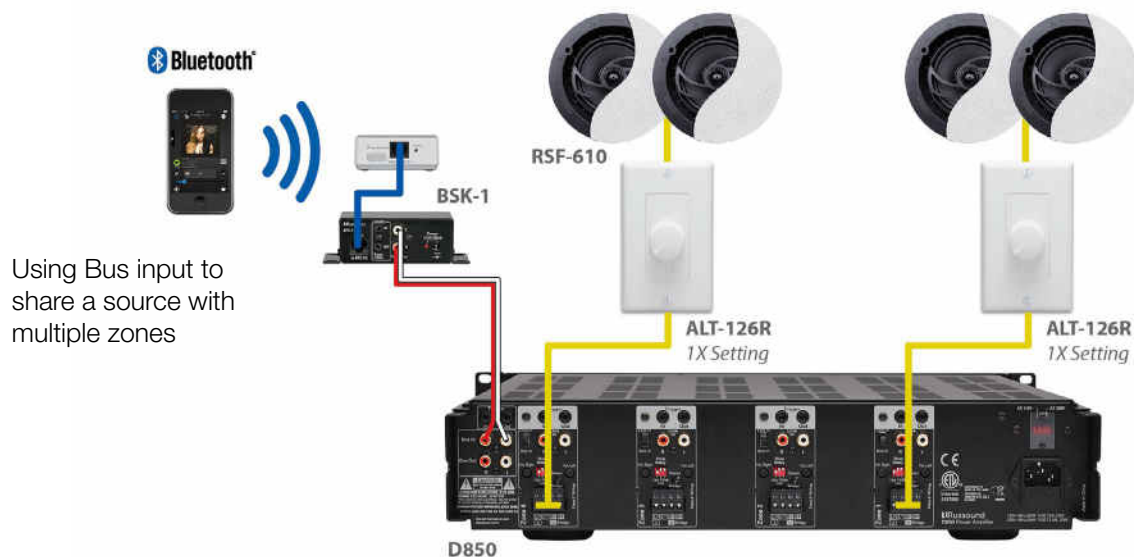

How to wire an auto-sensing amp to share TV speakers with a multi-zone system

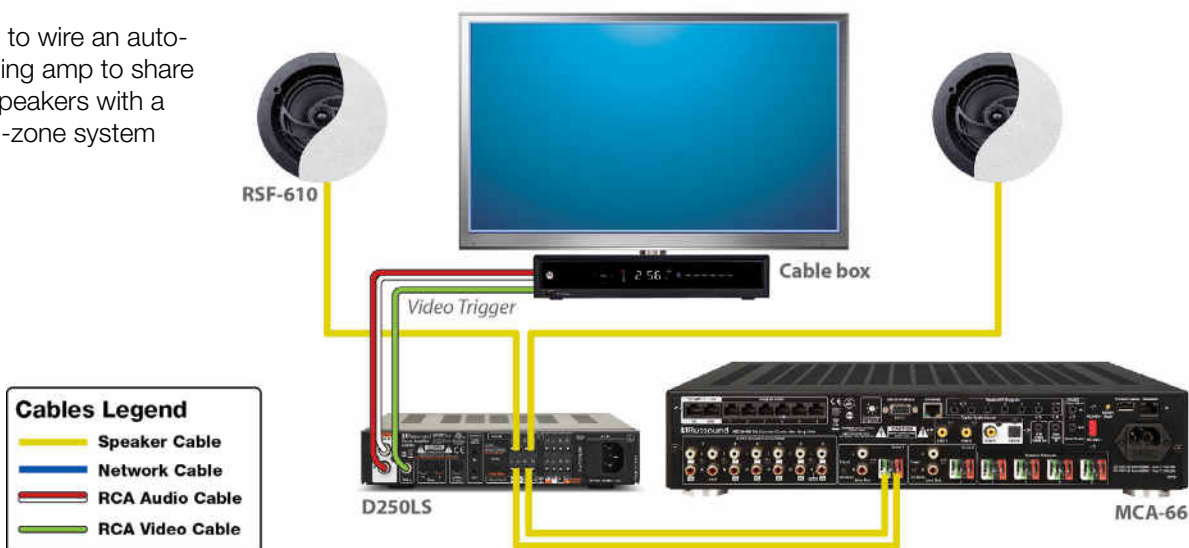

# Speakers

## Purpose-built speakers that offer designer aesthetics.

The new Acclaim™ Speakers feature distinct designer-inspired, edgeless, easy-to-install magnetic grilles and significant acoustic refinements. The line's "purpose-built" philosophy ensures there is an optimum performing speaker for any application and round and square grille options ensure they blend into any décor. All models offer Russound's time-saving three-dog design, allowing for quick and efficient installation, as well as a Limited Lifetime Warranty.

**NeoDrive**  
TECHNOLOGY

### Hey! What happened to the magnet?

Introducing the proprietary NeoDrive™ ultra-light, compact driver design. Ultra-powerful neodymium magnet structure enables CI's to fit speakers in tight spaces without compromising sound quality.





## Acclaim Edgeless In-Ceiling/In-Wall Speakers

### Performance series | Great sound for a variety of applications

#### RSF-610 6.5" Coaxial Speaker

- 6.5" polypropylene woofer with NBR surround
- ¾" Ferrofluid-cooled, PEI dome tweeter
- Frequency range: 50Hz-20kHz
- Sensitivity: 88 dB
- Recommended Power: 5W-80W



Shipping Weight: 7.0 lbs (3.2 kg)

3175-535086 RSF-610

#### RSF-610T Single Point Stereo Speaker

- 6.5" Injection-molded polypropylene/carbon-fiber woofer with NBR surround
- Twin ¾" ferrofluid-cooled, silk dome tweeters
- Frequency range: 40Hz-20kHz
- Sensitivity: 90 dB
- Recommended Power: 10W-120W Total



Shipping Weight: 5.0 lbs (2.3 kg)

3175-535116 RSF-610T

### High resolution series | superior sound for critical listening applications

#### RSF-620 6.5" Coaxial Speaker

- 6.5" polypropylene woofer with NBR surround
- 1" Ferrofluid-cooled, silk dome tweeter
- Frequency range: 50Hz-20kHz
- Sensitivity: 90 dB
- Higher power handling: 10W-100W



Shipping Weight: 7.0 lbs (3.2 kg)

3175-535093 RSF-620

#### RSA-635 6.5" Directional Speaker

- Drivers angled 15°
- 6.5" Injection-molded polypropylene/mica woofer with NBR surround
- ¾" Ferrofluid-cooled, silk dome tweeter
- Frequency range: 45Hz-20kHz
- Sensitivity: 88 dB
- Higher power handling: 10W-100W



Shipping Weight: 2.6 lbs (1.2 kg)

3175-535130 RSA-635

#### RSF-820 8" Coaxial Speaker

- 8" poly woofer with NBR surround
- ¾" Ferrofluid-cooled, silk dome tweeter
- Frequency range: 35Hz-20kHz
- Sensitivity: 90 dB
- Higher power handling: 10W-100W



Shipping Weight: 8.6 lbs (3.9 kg)

3175-535918 RSF-820

#### RSG-R Round Grille

For replacements or for pre-order for custom painting

Shipping Weight:  
0.5 lbs (0.2 kg)

3175-535925 RSG-6R 6"  
3175-535949 RSG-8R 8"  
Sold individually



#### RSG-S Square Grille





Allows an easy change to the speaker appearance to match any decor

Shipping Weight:  
0.5 lbs (0.2 kg)

3175-535932 RSG-6S 6"  
3175-535956 RSG-8S 8"  
Sold individually



## Acclaim Edgeless Speaker Chart

Model	Type	Woofer	Tweeter	Power	Freq. Resp.	Sensitivity	Cut-out Dims	Mounting Depth
 <b>RSA-635</b> (each)	High Resolution Series Angled	6.5" (16.51 cm) IMPP/mica cone w/ NBR surround	3/4" (1.9 cm) Ferrofluid cooled pivoting silk dome	10-100 W	45Hz - 20kHz	88dB	8.375" (21.27 cm)	3.7" (9.4 cm)
 <b>RSF-610</b> (pair)	Performance Series	6.5" (16.51 cm) Polypropylene cone w/ NBR surround	3/4" (1.9 cm) Ferrofluid cooled pivoting PEI dome	5-80 W	50Hz - 20kHz	88dB	8.375" (21.27 cm)	3.49" (8.9 cm)
 <b>RSF-620</b> (pair)	High Resolution Series	6.5" (16.51 cm) Polypropylene cone w/ NBR surround	1" (2.54 cm) Ferrofluid cooled pivoting silk dome	10-100 W	50Hz - 20kHz	90dB	8.375" (21.27 cm)	3.49" (8.9 cm)
 <b>RSF-820</b> (pair)	High Resolution Series	8" (20.32 cm) Polypropylene cone w/ NBR surround	3/4" (1.9 cm) Ferrofluid cooled pivoting silk dome	10-100 W	35Hz - 20kHz	90dB	9.875" dia. (25 cm)	3.98" (10.1 cm)
 <b>RSF-610T</b> (each)	Single-Point Stereo	6.5" (16.51 cm) IMPP/carbon fiber cone w/ NBR surround	Twin 3/4" (1.9 cm) Ferrofluid cooled pivoting silk dome	10-120 W (total)	40Hz - 20kHz	90dB	8.375" (21.27 cm)	3.69" (9.4 cm)

## OutBack Outdoor Speakers

### 8" OutBack Rock Speakers

#### 5R82 2-Way Rock Speakers

Designed to provide high quality audio in even the harshest of climates while disappearing into the landscape. Includes 3' of burial-rated wire and an integrated security loop for anchoring in place.



Dimensions: 14" x 12" x 11"D  
(35.6 x 30.5 x 27.9 cm)

Shipping Weight 11 lbs (4.95 kg)

3165-533464 5R82-G Gray Granite  
3165-533471 5R82-S Sandstone  
3165-533600 5R82-W Weathered Granite  
Sold individually



Gray Granite

Sandstone

Weathered Granite

### 5 Series OutBack Outdoors

The 5 Series OutBack outdoor speakers are designed to provide high quality audio indoors and out, even in the harshest of climates. Each speaker comes with a versatile bracket that allows for flat mounting, corner mounting, or pole mounting. Also included is a stylish pedestal foot that offers an elegant bookshelf mounting option. Available in black or white. Paintable.

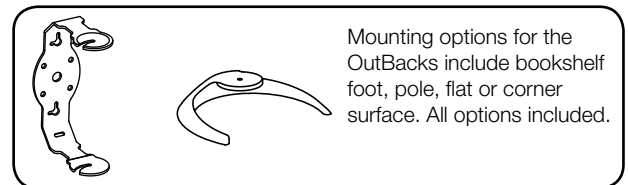

Mounting options for the OutBacks include bookshelf foot, pole, flat or corner surface. All options included.



#### 5B45 4" 2-Way

Dimensions: 9.5" x 6.25" x 6.25" D  
(24.13 x 15.87 x 15.87 cm)

Shipping Weight: 10.5 lbs. (4.8 kg)

3165-532832 White 5B45  
3165-532870 Black 5B45  
Sold in pairs



#### 5B55 5.25" 2-Way

Dimensions: 11.25" x 7.5" x 7.5" D  
(28.57 x 19.05 x 19.05 cm)

Shipping Weight: 14.8 lbs. (6.7 kg)

3165-532849 White 5B55  
3165-532887 Black 5B55  
Sold in pairs



#### 5B65 6.5" 2-Way

Dimensions: 13" x 8.75" x 8.25" D  
(33.02 x 22.22 x 20.95 cm)

Shipping Weight: 19.4 lbs (8.8 kg)

3165-532856 White 5B65  
3165-532894 Black 5B65  
Sold in pairs



#### 5B65S 6.5" Single Point Stereo

Dimensions: 13" x 8.75" x 8.25" D  
(33.02 x 22.22 x 20.95 cm)

Shipping Weight: 10.4 lbs (4.7 kg)

3165-532863 White 5B65S  
3165-532900 Black 5B65S  
Sold individually

### FBC1-FR Fire-Rated In-Ceiling Flexbox Speaker Back Box

Flexbox speaker back boxes reduce background noise, provide a moisture barrier, diffuse distortion and improve sound quality. The flexible construction allows for easy installation in retrofit or new construction settings. Flexboxes are flame retardant and meet ASTM E119 and UL 263/ NFPA 251 (1-hour) and ASTM E84/NFPA 70 standards.

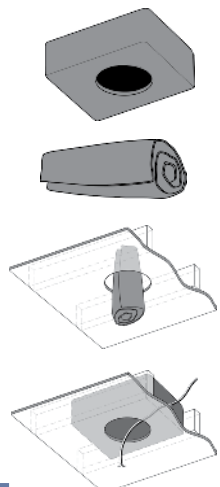

- 1" (25 mm) nominal thickness, proprietary composite
- STC Rating: 32, Flame Spread: 23
- Smoke Density: 30 (ASTM E84/ NFPA 70)



Dimensions: 14" W x 6" D x 17.5" H  
(355 x 152 x 445 mm)

Weight: 6.7 lbs (3 kg)

3801-531286 FBC1-FR

- Thermal Value: R 4.2
- -40° F to 350° F (-40° C to 177° C)
- Fire Rating: CLASS 1 Fire Rated ASTM E119 /NFPA
- 251 and UL 263 for 1 Hour Fire Rating

Sold individually



### In-Ceiling Rough-In Speaker Brackets



For all Russound 6.5" Speakers.



Shipping Weight: 1.2lbs (0.54kg)

3901-530722 SB-C67 6"



For all Russound 8" Speakers.



Shipping Weight: 1.4lbs (0.64kg)

3901-530739 SB-C80 8"





# Connectivity & Control

## About Connectivity & Control

Connectivity and Control is all about getting the signal from one place to another, be it a line level, speaker level or even Infrared. Russound's heritage is in speaker selectors and volume controls and ours are still the best in the business. We now offer infrared and wireless solutions designed specifically for the need of custom installers. **Speaker Selectors:** Speaker selectors are an efficient, cost-effective means of expanding an audio system. Russound has a wide variety of speaker selectors for most applications. Russound uses only the finest components in our speaker selectors to ensure the greatest amount of protection, sound quality and reliability.

**Volume Controls:** All Russound volume controls feature a superior autoformer design with impedance matching to provide excellent frequency response and maximum power transfer. With our volume controls, you get the highest possible performance, reliability and longevity.

**Infrared:** We view all our products as integral parts of the overall system. Therefore, all Russound IR products are installed with simple connections, engineered to integrate with a vast number of products and designed to perform with exceptional reliability.

## Volume Controls

### RUSSOUND'S VOLUME CONTROL WARRANTY

#### Hassle-Free Gold Guarantee

Two Reasons to Purchase Russound Volume Controls

##### BULLETPROOF

The ALTx line of Volume Controls has a high power handling capability of 126W for superior performance, added reliability and durability.

##### HASSLE-FREE GOLD GUARANTEE

Russound is so confident in the performance and reliability of its ALTx Volume Controls that if one should fail for any reason, we'll send you a replacement free of charge (no return necessary).

Simply contact Russound customer support with your shipping address and we will promptly send a free replacement to you. Proof of purchase may be required.



#### ALT-126R 126 Watt Impedance Matching Volume Control

- Easy access impedance switch behind front plate
- 126W peak, 42W RMS continuous
- 12 steps of attenuation including Off
- Accepts up to 12AWG cable
- Includes both white and Lt. Almond Decora® plates, inserts and knobs
- Easily converts to standard style plate with ALT-VC Standard Color Kit
- Lifetime warranty

Dimensions: 1.625"W x 2.675"H x 2.5"D (41 x 73 x 63 mm)

Shipping Weight: 1.2lbs (0.54kg)

6100-536281 ALT-126R White and Lt. Almond



#### WALTx-2

Weatherproof volume control with standard gray plate and knob. 12 position switch. Provides 1x, 2x, 4x, 8x impedance matching. Fits a standard 3/4" PVC outdoor conduit.



Dimensions:

3" W x 5" H x 3.75" D (76.5 x 127 x 95.5 mm)

Shipping Weight: 1.75 lbs (0.79 kg)

6500-114113 WALTx-2



#### EZB-8 E-Z Connect Speaker Terminal Block

Simplifies system wiring with volume control installations. Connects up to 8 pairs of speakers. Removable, screw-down connectors. Easily mounts to a wall, cabinet or structured wiring can with push-lock plugs included. Easily add additional speakers. Works with up to 12AWG wire.

Dimensions:

6.85 W x 3.0 H x 1.0" D (17.4 x 7.6 x 2.5cm)

Shipping Weight: 0.7 lbs (0.3 kg)

8100-536106 EZB-8



#### TBL-75 Table Top Volume Control

126 watt volume control with headphone jack speaker override. Installer configurable from 1x, 2x, 4x or 8x impedance matching.

Dimensions:

6.1" W x 2.5" H x 2" D (154 x 63.5 x 49.3 mm)

Shipping Weight: 2.5 lbs (1.1 kg)

6400-113161 TBL-75

# Speaker Selectors

## Single Source Selectors



### SS-4.2 4 Pair

100W/channel RMS. Works with 4Ω stable amplifiers & receivers. Resettable circuit protection. Impedance bypass switch for use with impedance matching volume controls. Zone labels included.

Dimensions:  
8.5" W x 1.875" H x 6.25" D  
(220 x 48 x 160 mm)

Shipping Weight: 2.75 lbs (1.2 kg)

3630-520679 SS-4.2



### SS-6.2 6 Pair

70W/channel RMS. Works with 4Ω stable amplifiers & receivers. Resettable circuit protection. Impedance bypass switch for use with impedance matching volume controls. Zone labels included.

Dimensions:  
11.5" W x 1.875" H x 6.25" D  
(295 x 48 x 160 mm)

Shipping Weight: 3.5 lbs (1.6 kg)

3630-520686 SS-6.2

## Autoformer-Based Selectors with Volume Control



### SDB-2.1 2 Pair

100W/channel RMS. Color-coded detachable 14-gauge snap connectors. Standard configuration is 2x, and installer may change configuration to 4x or 8x. Zone labels included.

Dimensions:  
8.5" W x 3" H x 6.25" D  
(220 x 80 x 160 mm)

Shipping Weight: 4.8 lbs (2.2 kg)

3615-604010 SDB-2.1



### SDB-4.1 4 Pair

200W/channel RMS. Color-coded detachable 14-gauge snap connectors. Standard configuration is 4x, and installer may change configuration to 2x or 8x. Zone labels included.

Dimensions:  
17" W x 3" H x 6.25" D  
(435 x 80 x 160 mm)

Shipping Weight: 8.6 lbs (3.9 kg)

3615-604027 SDB-4.1



### SDB-6.1 6 Pair

150W/channel RMS. Color-coded detachable 14-gauge snap connectors. Standard configuration is 8x, and installer may change configuration to 2x or 4x. Zone labels included.

Dimensions:  
17" W x 3" H x 6.25" D  
(435 x 80 x 160 mm)

Shipping Weight: 10.1 lbs (4.6 kg)

3615-604034 SDB-6.1

## Autoformer-Based Selectors/Impedance Matching



### PRO-6 HP 6 Pair

100W/channel RMS with subsonic filter built in. Color-coded detachable 14-gauge snap connectors. Zone labels included.

Dimensions:  
17" W x 2.875" H x 8" D (435 x 75 x 205 mm)

Shipping Weight: 9.5 lbs (4.3 kg)

3610-603075 PRO-6 HP



### PRO-8 HP 8 Pair

100W/channel RMS with subsonic filter, built in. Color-coded detachable 14-gauge snap connectors. Zone labels included.

Dimensions:  
17" W x 2.875" H x 8" D (435 x 75 x 205 mm)

Shipping Weight: 10 lbs (4.5 kg)

3610-603136 PRO-8 HP



### PRO-12 HP 12 Pair

100W/channel RMS with subsonic filter built in. Color-coded detachable 14-gauge snap connectors. Zone labels included.

Dimensions:  
17" W x 2.875" H x 8" D (435 x 75 x 205 mm)

Shipping Weight: 10 lbs (4.5 kg)

3610-603037 PRO-12 HP

## Miscellaneous Speaker Selectors



### AB-2.2 Tabletop Dual-Source

A single pair of speakers to be driven by either of two amplifiers or allow a single amplifier to drive either of two pairs of speakers.

Dimensions:  
5.5" W x 2.875" H x 3" D (140 x 73.5 x 76.5 mm)

Shipping Weight: 1.25 lbs (0.57 kg)

3699-520525 AB-2.2



### AB-3.2 Source Selector

Automatic A/B speaker selector, speaker level switching, selectable delay and sensitivity. Color-coded detachable 14-gauge snap connectors. Detachable 12v DC power supply.



Dimensions:  
6.25" W x 2" H x 1.55" D (159 x 51 x 39 mm)

Shipping Weight: 1.7 lbs (0.8 kg)

3699-520914 AB-3.2

3699-521270 AB-3.2 EU

3699-521287 AB-3.2 UK



### AB-1.2 Dual-Source

Allows a single pair of speakers to be driven by either of two amplifiers or allows a single amplifier to drive either of two pairs of speakers. Decora® wallplate not included.

Dimensions:

1" W x 2.75" H x 1.75" D (25.5 x 70 x 44.5 mm)

Shipping Weight: 3 oz (85 g)

3699-520501 White AB-1.2



# Speaker Selector and Volume Control Diagrams

6-Zone Speaker Selector System



8-Zone Impedance Matching Volume Control System (8X setting)

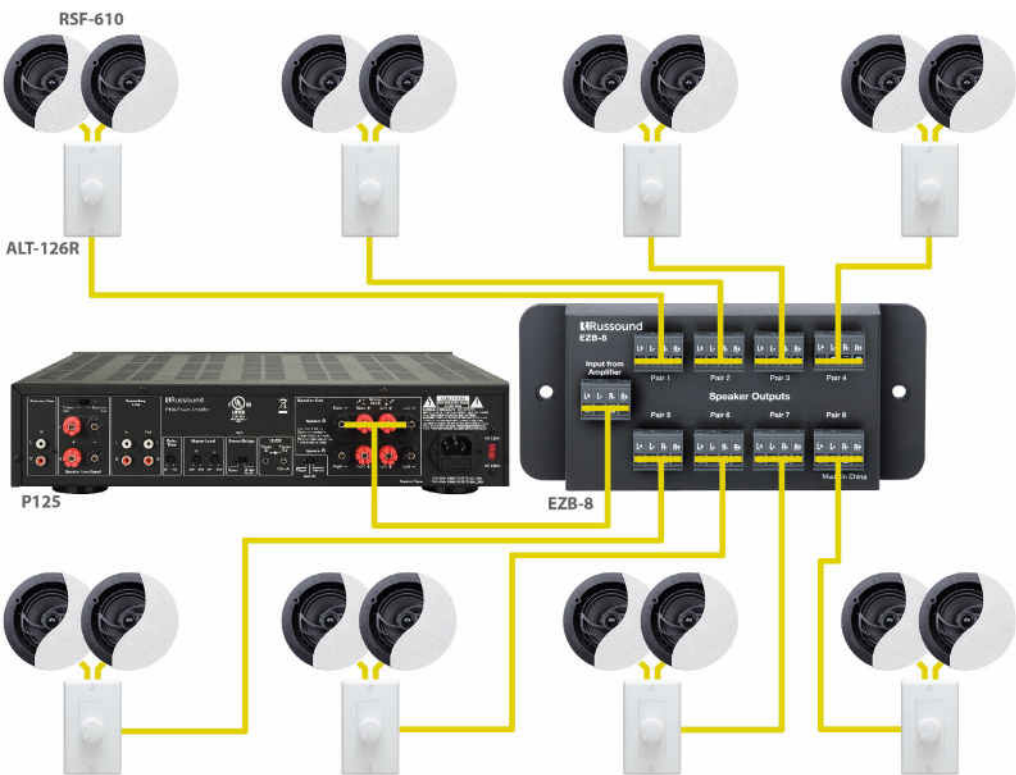

Impedance matching charts for speakers selectors and volume controls

Impedance Matching For 8-ohm Amplifiers									
4-ohm Speaker Pairs	0	1	2	3	4	5	6	7	8
0	-	1X	2X	4X	4X	8X	8X	8X	8X
1	2X	4X	4X	8X	8X	8X	8X		
2	4X	8X	8X	8X	8X				
3	8X	8X	8X						
4	8X								

Impedance Matching For 4-ohm Amplifiers																		
4-ohm Speaker Pairs		0	1	2	3	4	5	6	7	8	9	10	11	12	13	14	15	16
	0	-	2X	1X	2X	2X	4X	4X	4X	4X	8X	8X	8X	8X	8X	8X	8X	8X
	1	1X	4X	2X	4X	4X	4X	4X	8X	8X	8X	8X	8X	8X	8X	8X		
	2	2X	4X	4X	4X	4X	8X	8X	8X	8X	8X	8X	8X	8X				
	3	4X	8X	4X	8X	8X	8X	8X	8X	8X	8X	8X						
	4	4X	8X	8X	8X	8X	8X	8X	8X	8X								
	5	8X	8X	8X	8X	8X	8X	8X										
	6	8X	8X	8X	8X	8X												
	7	8X	8X	8X														
	8	8X																

# Impedance Matching

## Impedance Matching VCs vs. Impedance Matching Speaker Selectors

Examples use the P125 amplifier that delivers 80W/ch at 8Ω and RSF-610 Speakers that are 8Ω.

ALT-126R Volume Controls non-impedance matching (1X setting) with SS-4.2 Impedance Matching Speaker Selector

Allows you to turn off unused zones to provide more power to the remaining zones.

This could be useful for when a party is happening in the outdoor zone.

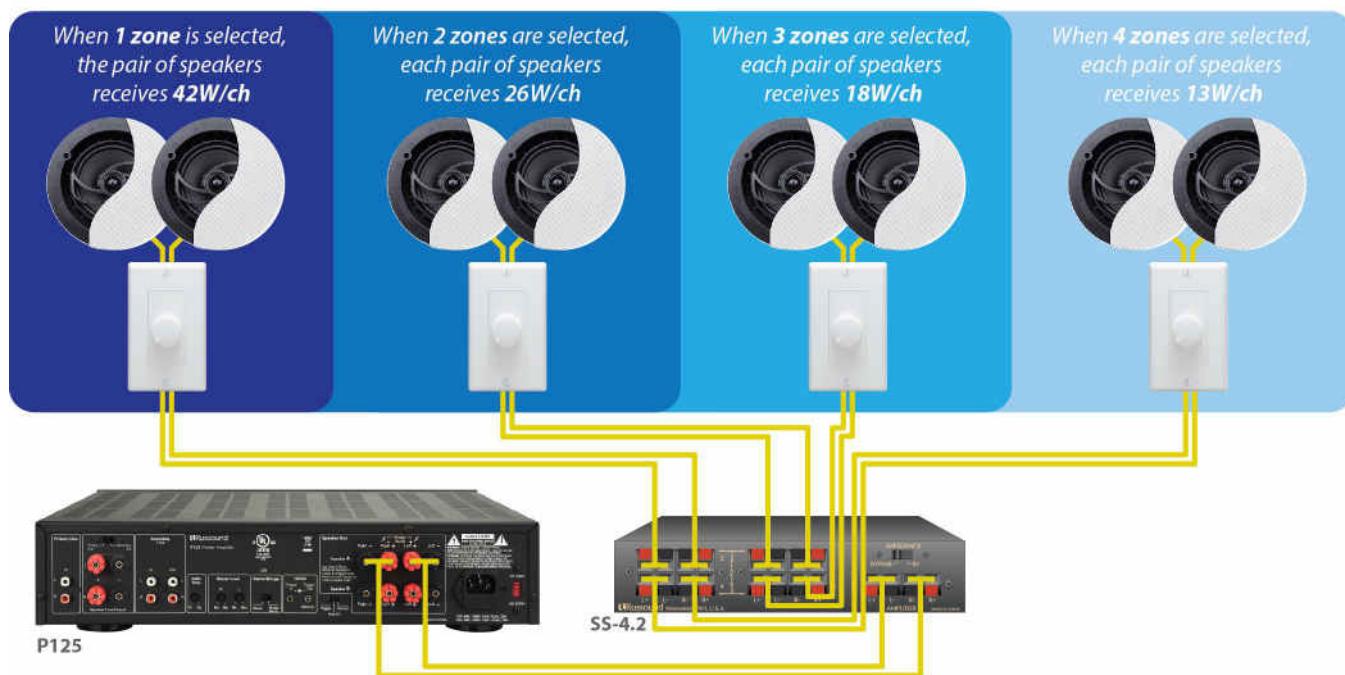

ALT-126R Volume Controls with impedance matching at 4X setting without speaker selector

Provides protection of the power amplifier at all times. Shares power equally among the speakers regardless of demand.



## Infrared Systems

### SLM-1K Universal Surface Mount IR Kit

Includes:

- (1) SLM-1 IR Receiver
- (4) IRE-1 IR Emitters
- (1) CB-140 Connecting Block
- (1) CB-PS power supply

Shipping Weight: 1.5 lbs (0.68 kg)

5300-536496 SLM-1K  
5300-5300-536809 SLM-1K EU



### IRE-1 IR Emitter

- Low-profile design
- Blocking cover included
- Plug and Play connections with 3.5mm plug
- Emits IR from both front and rear for cabinet mounting when desired

Dimensions (emitter without cable):  
0.47"W x 0.35"D x 0.18"H (11.9 x 8.9 x 4.6 mm)

Shipping Weight: 2 oz (57 g)

5300-536519 IRE-1



### IRE-2 Dual Head Emitter

- Control two devices
- Low-profile design
- Blocking cover included
- Plug and Play connections with 3.5mm plug
- Emits IR from both front and rear for cabinet mounting when desired

Dimensions (each emitter without cable):  
0.47"W x 0.35"D x 0.18"H (11.9 x 8.9 x 4.6 mm)

Shipping Weight: 6 oz (0.2 kg)

5300-536533 IRE-2



### SLM-1 Slim-Design Surface Mount IR Receiver

- Low-profile design to blend seamlessly with modern television bezels
- Plug and Play connections with 3.5mm plug
- Universal LCD, LED, Fluorescent and Plasma friendly design

Dimension (without cable):  
1.0"W x 0.52"D x 0.25"H (25.4 x 13.2 x 6.4 mm)

Shipping Weight: 2 oz (57 g)

5300-536502 SLM-1



### CB-140 Connecting Block

- Compact design
- Plug and Play with color-coded 3.5mm jacks
- Expands to up to 8 emitters with dual emitters
- IR confirmation LED for troubleshooting

Dimensions:  
1.75"W x 4.3"D x .375"H (44.5 x 63.5 x 9.5 mm)

Shipping Weight: 2 oz (57 g)

5300-536540 CB-140

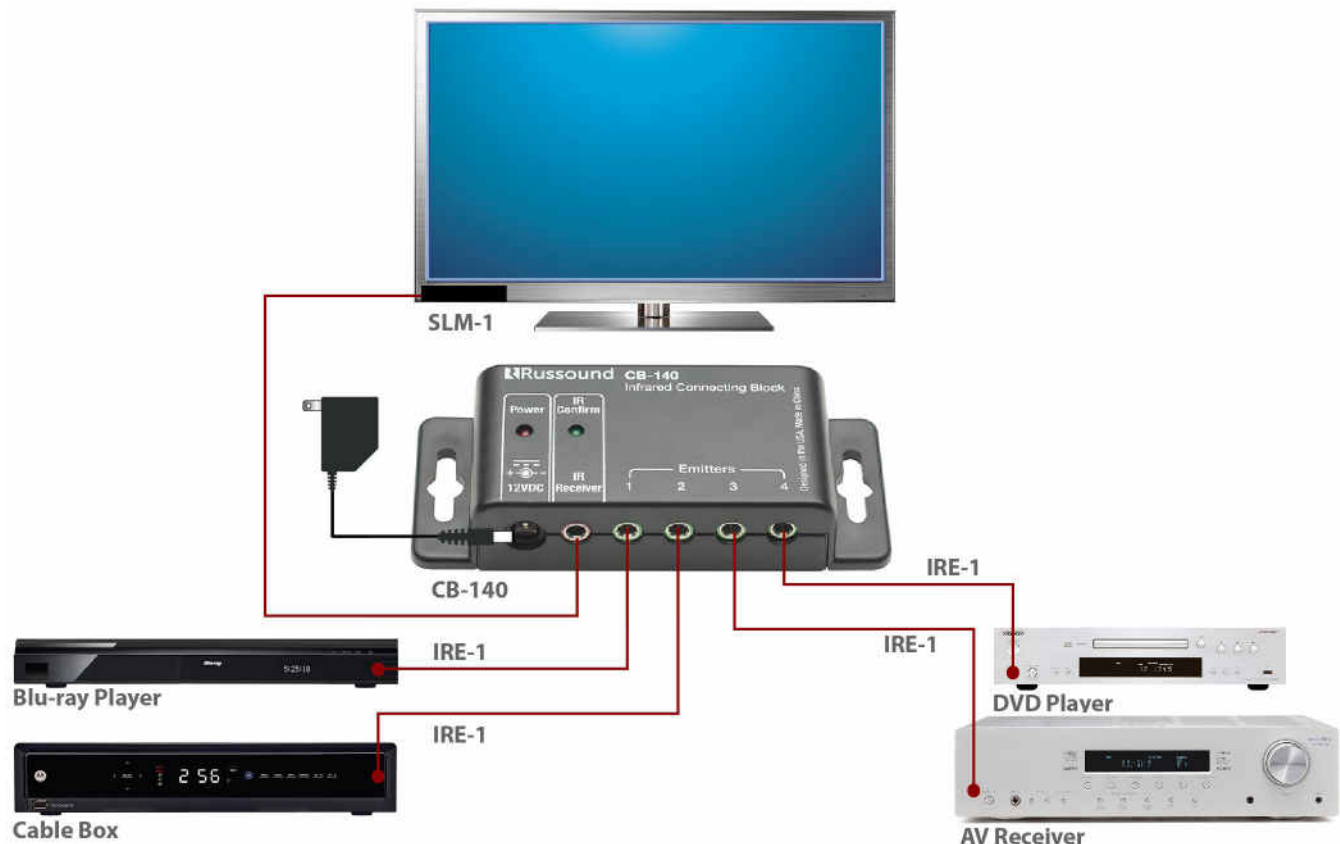

# ComPoint® Intercom Systems



## ISK2 Advanced Keypad

Single-gang Decora style keypad. 5-character LCD display, assignable zone names and volume level. Select zones and door stations, controls receive volume, sets "do not disturb". Internal microphone with automatic gain control. Built-in amplifier powers one or two external speakers. Speaker relay to share speakers with an audio system for communications. 110 punch-down. Installer-selectable amber or green backlighting. Wall plate and speakers not included.



Dimensions:  
1.875" W x 4" H x 2.625" D  
(4.8 x 10.2 x 6.7 cm)

Shipping Weight: 5.6 oz (159 g)

2300-525384 ISK2 White



## ISK3-AB Door Station

Weather-resistant call station fits a single-gang deep wall box. Solid metal cover plate mounts flush to exterior wall. Internal microphone with automatic gain control. Built-in amplifier and speaker. 110 punch-down connector for CAT-5 cable. Internal relay with screw terminals for connecting to an external doorbell. Amber backlit call key. Maximum 2 door stations per system.



Dimensions:  
3" W x 5.125" H x 3" D  
(7.6 x 13.0 x 7.6 cm)

Shipping Weight: 9 oz (0.26 kg)

2300-525407 ISK3 Antique Brass



## ISSP ComPoint Speaker

Single-gang Decora-style in-wall speaker. Installs beside a ComPoint keypad in double-gang wall box. Allows ComPoint to be used as a stand-alone system. High-quality driver in the ISSP is ideally matched to the keypad amplifier. Moisture-resistant design is suitable for bathrooms and kitchens. Wall plate not included.



Dimensions:  
3" W x 5.125" H x 3" D  
(7.6 x 13.0 x 7.6 mm)

Shipping Weight: 8 oz (227 g)

2300-528279 ISSP

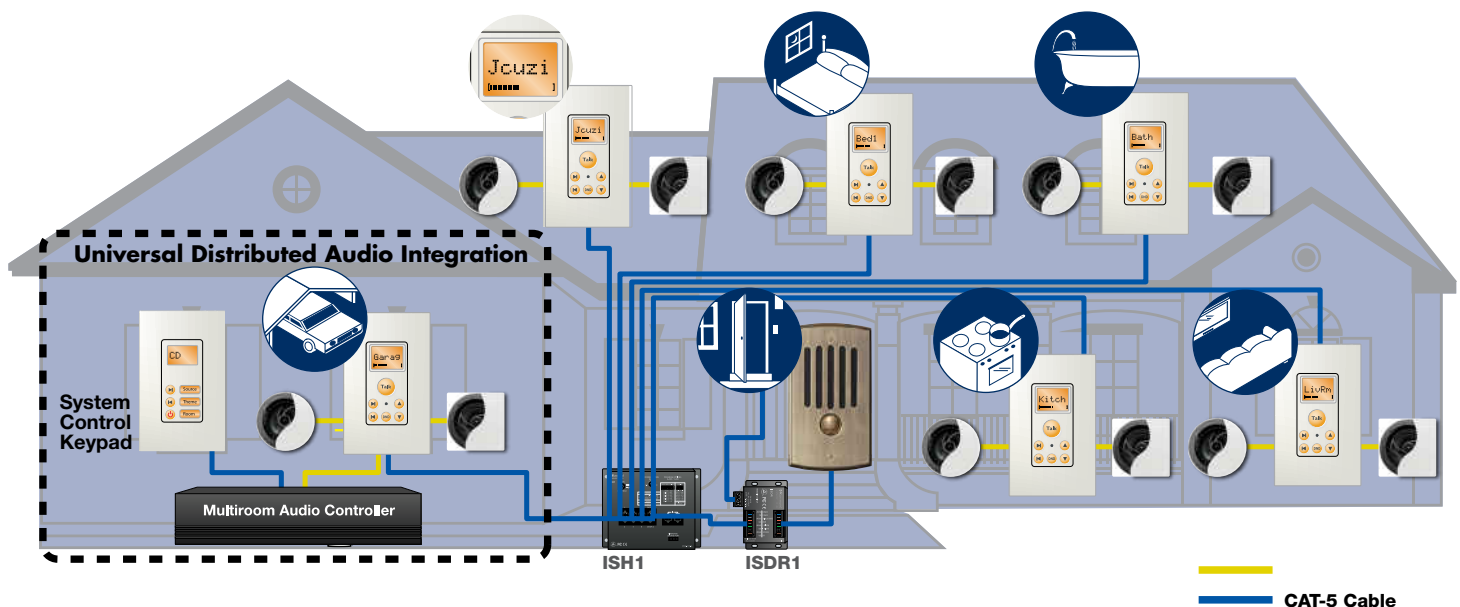



## ComPoint Intercom Systems



### ISH1 ComPoint Hub

6-zone surface- or panel-mount controller. Up to 6 hubs can link together for a total of 36 zones. Supports 2 door and provides 7 doorbell chimes, individually selectable for each door. Gain control for doorbell chime and alert tone volume. RJ-45 connectors for keypads, door stations, and hub linking. Firmware updatable. Power supply not included.



Dimensions:  
6" W x 5" H x 2" D  
(152 x 127 x 51 mm)

Shipping Weight: 2 lbs (0.9 kg)

**2300-526459 ISH1**



### ISDR1 Door Strike Release Module

Surface-mount module connects in a secure location in line with the CAT-5 cable between the hub and a door station to provide relay contacts for a third-party door strike release or other device. 110 punch-down connector for CAT-5 cable. Screw terminals for access to common, NC and NO relay contacts. Relay rated for 1 A @ 12 VDC.



Dimensions: 3" W x 1.875" H x 1" D (7.6 x 4.8 x 2.5 cm)

Shipping Weight: 9 oz (0.12 kg)

**2300-525445 ISDR1**



### ISPS Power Supply

15V DC 3.5A. Autosensing 100V-240VAC, detachable power cord, compact size.



Dimensions:  
4.56" W x 1.93" H x 1.33" D (115.8 x 49 x 33.8 mm)

Shipping Weight: 1lb (0.5 kg)

**2300-526282 ISPS**  
**2300-526763 ISPS-EU**  
**2300-526770 ISPS-UK**



### Advanced Programming Cable

Advanced programming cable for ComPoint components (ISK1, ISK2, ISK3, ISH1). Female DB-9 connection (PC end) and flat device pin connection (device end)



Length: 72" (182.9 cm)

Shipping Weight: 1 lb (0.45 kg)

**2500-521065**

# Plates, Wire and Accessories

## Home Theater



### HTP-7.2

HTP-7.2 is a double-gang in-wall connection plate designed to allow easy hookup of all the speakers in a 5.1, 6.1 or 7.1-channel surround sound system. It includes terminals for up to seven speakers, and two powered/active (low level) subwoofers. The heavy-duty molded plate supports the weight of high-quality wires, and each connection is clearly labeled.

Dimensions: 4.75"W x 4.75"H x 1.2"D  
(12 x 12 x 3cm)

Shipping Weight: 8 oz (0.23 kg)

**7101-537059 HTP-7.2**

## System Accessories

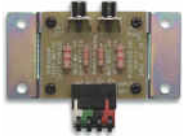

### ADP-1.2 Speaker to Line-Level Adapter

Recommended for use with CAA66 and MCA-66 to obtain line level outputs for zones without pre-amp outputs. Color-coded detachable 14-gauge snap connectors. Not for use with digital amplifiers.

Dimensions: 3.375" W x 1" H x 2.5" D  
(8.6 x 2.6 x 6.4 cm)

Shipping Weight: 14 oz (0.4 kg)

**9500-2000891 ADP-1.2**

## Data Cable and Speaker Cable - call for pricing, special order only.



### AW162CL3 2 Conductor, 16-Gauge

Unshielded, 26/30 strands bare copper, .024 nominal PVC jacket, temp. rating 75° C, UL type CL3, Light Blue Jacket. 1,000' pull-box only.

**9000-119316 AW162CL3**



### AW164CL3 Four Conductor, 16 Gauge Speaker Cable

Unshielded, 26/30 strands bare copper, .024 nominal PVC jacket, temp. rating 75° C, UL Type CL3, Yellow Jacket. 500' pull-box only.

**9000-460067 AW164CL3**



## International Convenience Items

### Outdoor Thermoplastic Covers



#### **WPB 37-23** Vertical, Single Gang

Self-closing cover with 3/8" gasket and 4 mounting screws. Mounts to single-gang box (not included).

Dimensions: 3.0625" W x 4.8125" H x 1.1875" D (77.8 x 122.4 x 30.2 mm)

Shipping Weight: 9 oz (0.3 kg)

**9000-450020 WPB 37-23**

#### **WPB 37-23FS** Vertical, Single Gang

Self-closing cover with 3/8" gasket and 2 mounting screws. Mounts to flat surface with 4 screws.

Dimensions: 3.0625" W x 4.8125" H x 1.1875" D (77.8 x 122.3 x 30.2 mm)

Shipping Weight: 9 oz (0.3 kg)

**9000-450037 WPB 37-23FS**

### Plastic Work Boxes for New Construction

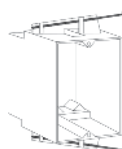

#### **S1-18-R** Single Gang

Captive mounting nails. 2 Quick Click® entries.

Dimensions: 2.0625" W x 2.875" H x 3.125" D (52.4 x 73.1 x 79.4 mm)

Shipping Weight: 4 oz (0.1 kg)

**7200-450075 S1-18-R**

#### **S1-22-R** Single Gang

Captive mounting nails. Four Quick Click entries.

Dimensions: 2.0625" W x 2.9375" H x 3.4375" D (52.4 x 74.7 x 87.4 mm)

Shipping Weight: 5 oz (0.1 kg)

**7200-114694 S1-22-R**

#### **S2-35-RAC** Double Gang

Captive mounting nails. 4 Quick Click entries.

Dimensions: 3.8125" W x 2.9375" H x 3.0625" D (96.9 x 74.7 x 77.8 mm)

Shipping Weight: 5 oz (0.1 kg)

**7200-450082 S2-35-RAC**

#### **S3-54-RAC** Triple Gang

Captive mounting nails. 6 Quick Click entries.

Dimensions: 3.8125" W x 2.9375" H x 3.0625" D (96.9 x 74.7 x 77.8 mm)

Shipping Weight: 5 oz (0.1 kg)

**7200-450099 S3-54-RAC**

### Plastic Work Boxes for Retrofit

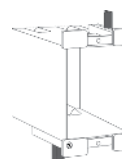

#### **S1-18-W** Single Gang

2 Auto Clamps®. 2 Quick Click entries.

Dimensions: 2.0625" W x 2.875" H x 3.125" D (52.4 x 73.1 x 79.4 cm)

Shipping Weight: 4 oz (0.1 kg)

**7200-450051 S1-18-W**

#### **S2-32-W** Double Gang

4 Auto Clamps. 4 Quick Click entries.

Dimensions: 3.875" W x 2.9375" H x 3.125" D (98.5 x 74.7 x 79.4 cm)

Shipping Weight: 5 oz (0.1 kg)

**7200-450068 S2-32-W**

*UL Classified and ICBO Recognized. Quick Click® and Auto Clamp® are registered trademarks of the Pass and Seymour/ Legrand Corporation. Note: All Work Boxes must be purchased in 10 piece lots.*

### P-Rings for Retrofit

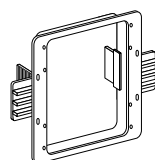

#### **CADMP1P** Single Gang

Dimensions: 2.5" W x 4.25" H x 1.5" D (63.5 x 108 x 38.1 mm)

Shipping Weight: 1 oz (0.05 kg)

**7200-119576 CADMP1P**

### Decora Screwless Cover Plates



#### **SWP-1** 1 gang

Shipping Weight: 2 oz (0.071 kg)

**7106-115615 White**



#### **SWP-1** 1 gang

Shipping Weight: 2 oz (0.071 kg)

**7106-536992 Black**



#### **SWP-2** 2 gang

Shipping Weight: 2 oz (0.071 kg)

**7106-114274 White**  
**7106-114281 Almond**  
**7106-531040 Black**  
**7106-531040 526497 Stainless Steel**

# Our Commitment and Contact Info

## Color Key

If it's in a blue box, like this one, then it's a kit that includes multiple items

If a part number is orange like this **2300-526404** then it's available only while supplies last.

If a part number is magenta like this **2300-526404** then it's an international part.

## Answers and Solutions

We promise to do our utmost to satisfy your needs on the first contact or with a return response that very day. We make it our priority to answer your question and resolve issues in a prompt and courteous manner.

## Inventory

We offer a complete product line and maintain a deep inventory of items.

## Knowledge

Knowledgeable sales personnel that are fast, fun and friendly to work with. The best technical support in the business from 8:30 AM to 7:00 PM ET, Monday through Friday, 1 866-888-7466.

## Education

Dedicated professional regional trainers and comprehensive educational programs.

## Product Integrity

Russound backs all of its products with quality and a no nonsense warranty. We'll do whatever it takes to make a situation right. For extra peace of mind, Russound obtains all applicable safety approvals for our products, even when they're not required.

## Courtesy

We treat everyone with courtesy, dignity and respect. And that means everyone. Our primary goal is to establish a long-lasting, mutually beneficial relationship.

## e-friendly



**Facebook:** [www.facebook.com/RussoundFMPInc](http://www.facebook.com/RussoundFMPInc)



**Twitter:** [twitter.com/RussoundAudio](https://twitter.com/RussoundAudio)



**YouTube**



**LinkedIn:** [linkedin.com/company/russound](https://www.linkedin.com/company/russound)



**Phone:** 866-888-7466 | 603-659-5170



**Place and track orders, access transaction history, and view up-to-date business and technical information 24/7 at [www.russound.com](http://www.russound.com)**



**Technical Help:** [tech@russound.com](mailto:tech@russound.com)  
**Sales:** [sales@russound.com](mailto:sales@russound.com)



## Warranty and Stock Adjustments

### Product Category Warranty

One year limited warranty: P-Series amplifiers.

Two year limited warranty: controllers, keypads, touchscreens, source equipment, A-BUS system, ComPoint intercom system, R-series amplifiers, D-Series amplifiers, infrared products, accessories.

Five year limited warranty: Outback rock speakers

Ten year limited warranty: Speaker selectors and impedance matching devices

Limited lifetime warranty: Volume controls, Acclaim series speakers, Outbacks, Flexbox speaker back boxes

### Returns And Warranty Policy

Russound sells products only through authorized Dealers and Distributors to ensure that customers obtain proper support and service. Any Russound product purchased from an unauthorized dealer or other source, including retailers, mail order sellers and online sellers will not be honored or serviced under existing Russound warranty policy. Any sale of products by an unauthorized source or other manner not authorized by Russound shall void the warranty on the applicable product.

Returns must be authorized and be accompanied with an R.A. number and a copy of the proof of purchase.

A 15% restocking charge may apply. Any returns for repair found to be non-defective may result in a fifty dollar minimum charge. Any product returned without a Return Authorization Number will be returned at dealer expense.

For further warranty information, see Russound product manuals. Prices and specifications subject to change without notice. Russound is not responsible for typographical errors. ©2017-2018 Russound/FMP, Inc. All rights reserved. Russound and the Russound logo are registered trademarks of Russound/FMP, Inc. XStream, Acclaim, MyRussound, OutBack and NeoDrive are trademarks of Russound/FMP, Inc.. Decora® is a registered trademark of Leviton Corporation. A-BUS® is a registered trademark of LeisureTech Pty Ltd Australia. iPod®, iTouch® and iPad® are trademarks of Apple, Inc., registered in the U.S. and other countries.

### Compliance and Certification

Russound products that carry these logos meet standards and are compliant to safety and emissions regulations mandated by these agencies. Declarations of conformity are available upon request.



CONFORMS TO US STD  
60065-6-2003



C US  
C22.2 No. 60065-4-03



## A legacy of Quality, Trust and Innovation

In 1967 in a quiet town in rustic New England, Russound was founded based on a desire to make the finest audio accessories on the market. Founded by Gaylord “Russ” Russell, Russound’s early products included hi-fi solutions such as speaker selectors, tape monitor switches and volume controls. The name Russound became synonymous for high-quality volume controls and the company soon developed a reputation for their reliable products.

Over the years, Russound developed a wider range of products for the custom installation market and increasingly became known for quality, reliability and service. That vision continues on today, as exciting new technologies are being implemented to create modern solutions for their customers’ needs. With its products now sold in over 100 countries, the Russound name has become synonymous with audio quality not only in the USA, but also around the world.

Based in Newmarket, New Hampshire, Russound continues to design and manufacture innovative products that sound great, are easy to install and simple to use, and that offer great value. Russound delivers a complete range of multiroom audio systems, source equipment, volume controls, amplifiers, loudspeakers and intercom systems. They believe their products are the finest of their kind on the market and remain dedicated as ever to providing their customers with the right products for the job.

## Our commitment to you

**Support for Custom Integrators and the Industry** – Russound is dedicated to supporting the role of the custom installation professional as a key player in all installations. Our Russound Certified Installer program reinforces this commitment and keeps an audio professional as a mandatory part of the sales process. Russound will never solicit your customers directly.

**Industry-leading Technical Support** – Our exceptional team of experienced technical support staff are ready to answer any questions.

**Elegant and Intuitive Website** – The new Russound website provides everything needed to select the best products for every job from product manuals to wiring diagrams to downloadable hi-res images to include in bid proposals.

**Dedicated and Responsive Customer Service** – One of the key reasons that Russound has been around for fifty years is our amazing customer service and sales support staff. We’re real people, available when you need us.

**Unstoppable Dedication to Quality** – Extensive quality oversight and thorough testing of each and every Russound product means that you can be proud to put your trust into each of our products that you install for your customers.

**Ongoing support commitment** – Hand in hand with extraordinary quality, Russound offers some of the longest lasting, most comprehensive product warranties available in the industry, from one year minimum up to an entire lifetime, Russound has you covered.

## Our Core Values

Honest	Responsive	Positive
Consistent	Accountable	Loyal



Visit us at: [www.Russound.com](http://www.Russound.com) • 1 Forbes Road, Newmarket, NH 03857 USA • Telephone: +1.603.659.5170 • Email: [sales@russound.com](mailto:sales@russound.com)

©2017 Russound/FMP, Inc. All rights reserved. Russound and the Russound logo are registered trademarks of Russound/FMP, Inc. XStream, Acclaim, MyRussound, and NeoDrive are trademarks of Russound/FMP, Inc. All other trademarks are the property of their respective owners. Products, prices and specifications are subject to change without notice.  
2017-2018 Resource Guide.