



DFW-X1
WATER LOW FOG MACHINE
USER MANUAL

Please read over this manual before operation the machine

CONTENTS

1. INTRODUCTION
2. SAFETY INSTRUCTIONS
3. DESCRIPTION OF PARTS
4. FLUID
 - 4.1 GENERAL NOTES
 - 4.2 STORAGE AND A POINT FOR ATTENTION OF THE FLUID
5. OPERATING THE DATA
 - 5.1 PUTTING INTO OPERATION
 - 5.2 OPERATION DISPLAY
 - 5.3 DMX CONTROL
 - 5.4 FLUID PROTECTION
6. WIRELESS CONTROLLER
7. PACKING LIST
8. CARE AND MAINTENANCE
9. TROUBLE-SHOOTING
10. SPECIFICATIONS
11. WARRANTY CONDITIONS

1. Introduction

Water Low Fog Machine is a newest low smoke effects revolutionary innovation. Only consume water and low fog liquid !!!

Energy efficiency and environmental protection but large smoke output. Machine install in flight case with wheel, convenient transportation and handling!

2. Safety instructions

A fog machine is not a toy!

1. Never touch the nozzle when in operation. Danger of getting burnt.
2. Occasionally very hot droplets of fluid may escape when in operation. Thus never aim at persons directly and keep a minimum distance of 3m to the nozzle.
3. The location for the machine must be non-flammable, non-combustible and not sensitive to heat. It has to be twice as big as the machine.
4. Combustible objects and objects sensitive to heat. Keep a minimum distance of 60cm to all flammable,
5. The visibility has to be more than 2m in rooms where people walk around.
6. Fog may activate smoke detectors.
7. Artificially-made fog can be produced in many different ways. The method used here to produce fog, with a device which works according to the vaporizer principle, is the most harmless one.
8. Please put the machine dry, no dust and contaminant, not shake and keep in dry environment.
9. Please do not work the machine if there is no liquid.

Please note: People with health problems or problems of the respiratory tract or with an inclination for allergies should avoid any contact with the haze.

3. Description of parts

- ①LCD controller
- ②DMX512 3pin female socket (output)
- ③DMX512 3pin male socket (input)
- ④DMX512 5pin female socket (output)
- ⑤DMX512 5pin male socket (input)
- ⑥Remote controller receiver (30meter without obstacle)

- ⑦ Power Switch
- ⑧ Fuse (15A)
- ⑨ Power line input
- ⑩ 2L Water low fog liquid tank
- (11) Water low fog liquid tube
- (12) Fast connector

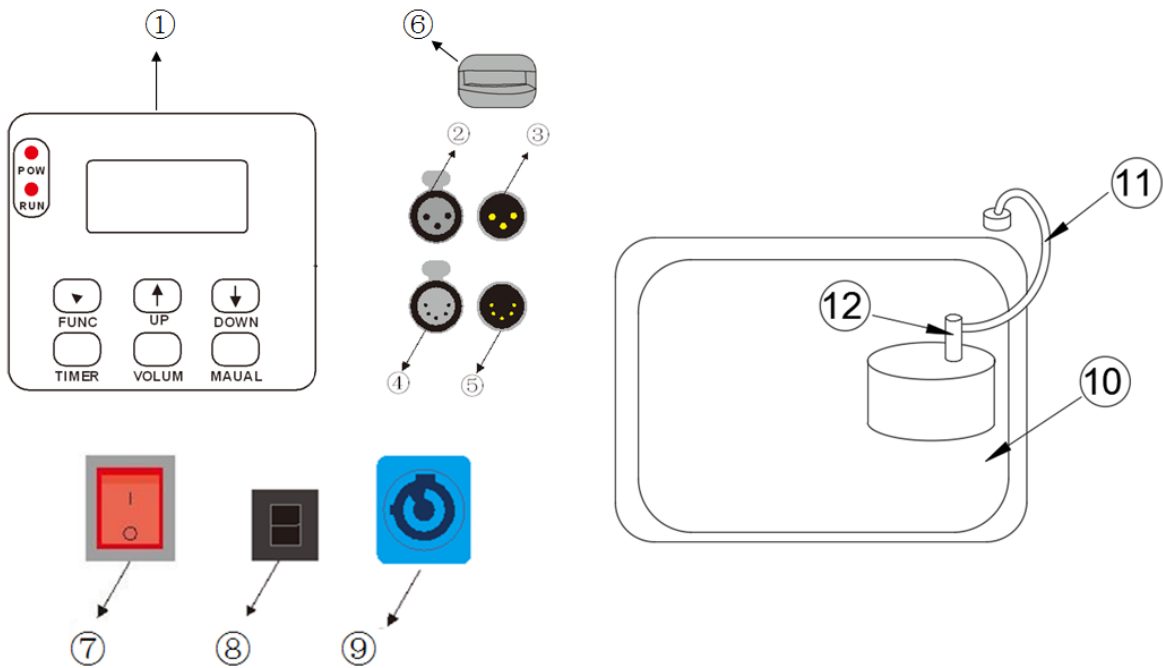

(13) Water input

This is a auto water feeder when water less than normal level! Put the liquid tube into the bottle, it will put the water from bottle into machine automatically.

(14) Water overflow

If there too many water inside the machine, extra water will go out from here by itself.

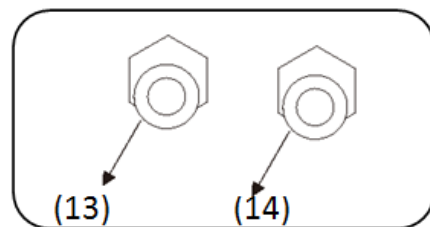

(15) Water output after work is ends. There is a screw know in the bottom of machine to let water out directly.

After using the machine, please put out all the water from this water output. In order to keep water tank clear, please clean the water tank after using the machine each time. Use the purified water can prolong the service life of the machine.

4. Fluid

4. 4.1 General notes

(1) To guarantee trouble-free operation the special “Water Low Fog Liquid“ must be used. Use of other liquids will void the manufacturer’s warranty and can be dangerous to your health.

(2) The Water Low Fog Liquid is 4 bottles in a carton, 5 liter per bottle. You can buy from the local dealer.

(3) Use the Water low fog liquid, smoke is white and heavy, fast and even spread on the ground! Similar as dry ice to create a strong cloud effect.. Even there have wind, it will not affect the results, because smoke below 60cm will sink automatically, smoke higher than 60cm will disappear automatically.

If using other fog liquid, smoke would float in the air and not disappear easily, influence taken effect.

4.2 Storage and a point for attention of the fluid

(1) The “Water Low Fog Liquid” is a highly concentrated fluid. You can store it for six months.

(2) Please put the items into the cool and dry place ,avoid to the sunshine directly.

(3) If contact with the eyes, please rinse with plenty of water.

(4) The fluid can’t eat and must be keep away from the children. If do not carefully eat the fluid, please see a doctor in time.

5. Operating the data

5.1 Putting into operation

Connect to the machine supply. Make sure the correct voltage is selected. (220V /60Hz, 110V /50Hz)

Turn on power switch, Picture 1 appear on the display (refer Picture 1) , then Picture 2 appear, (refer Picture 2) , after one minute, show Picture 3 (refer Picture 3) , it means warming up finished.

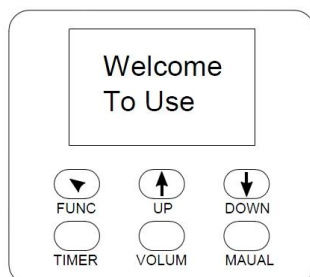

Picture1. Welcome To Use



Picture 2. Warming Up



Picture 3. Ready To Fazer

5.2 Operation display

5.21 FUNC Menu

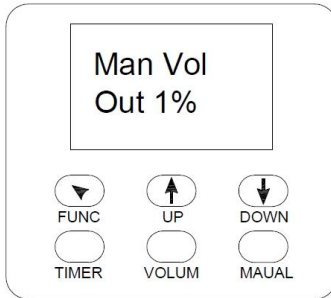

Picture 4 Adjust the output

(Picture 4). Press FUNC one time, appear Picture 4, it means adjust the output, press UP and DOWN, it can adjust 1%~100% output, press VOLUM, it can jet immediately.

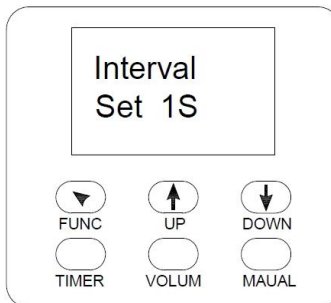

Picture 5 Interval time

(Picture 5). Press FUNC two times continuously , appear Picture 5, it means adjust the interval time, press UP and DOWN, it can set 1~200s interval time.

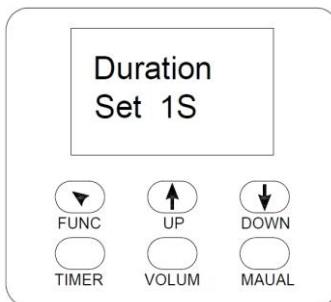

Picture 6. Smoke discharge time

(Picture 6). Press FUNC three times continuously, appear Picture 6, it means adjust the smoke discharge time, press UP and DOWN, it can set 1~200s smoke discharge time.

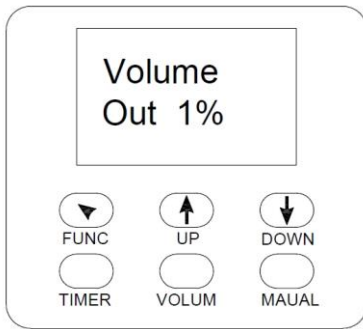

Picture 7. Smoke Output

(Picture 7) . Press FUNC four times continuously, appear Picture 7, it means adjust the smoke output, press UP and DOWN, it can set 1%~100% smoke output.

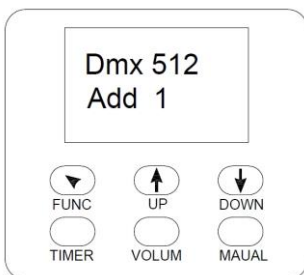

Picture 8. DMX adjust

(Picture 8). Press FUNC six times continuously, appear Picture 8, press UP and DOWN, it can adjust 1~511 DMX start address.

5.22. TIME Key-press

Press "TIMER", timer and ration. Show circularly the picture 5 and picture 6, it mean the machine will be worked as the setup of picture 5、 6 and 7. Press the "TIMER" again, return to the main menu.

5.23 VOLUM Key-press

Press "VOLUM", the machine start to working, show the picture 4 spray time. Also it can adjust the spray time thought "UP" and "DOWN". Press the "VOLUM" again, return to the main menu picture 3.

5.24 DMX control

DMX have priority when the machine put in the XLR socket. (it means the machine is controlled by DMX, the data will be connected the DMX, all the key-press on the machine will be stop using. When the machine receives the correct DMX signal, the machine will have a one channel, the first channel = pump.

Through the XLR socket, it can connect to multiple machines and use all at the same time.

5.4 FLUID PROTECTION

When the water low fog liquid is completely depleted, the LCD panel interface is shown in picture 9. In this case, machine stop working, need to add fill in water low fog liquid and then press MAUAL button to reset, the pump will work 40 seconds until the LCD panel display interface for Picture 3, haze machine work normally.

If the tank still have liquid inside but the machine show “ Out Order”, please check the liquid tube and fast connector of bottle cap firstly and then check the pump.

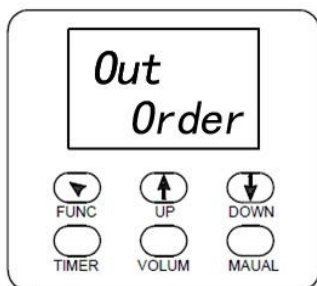

Picture 9. Fluid protection

5.5 FLUID PROTECTION SYSTEM ON AND OFF SETTING METHOD

If you press many times “ MANUAL” button but can not get back from “ Out Order” when all the spare parts in normal, you can press six times “ FUNC” button and then LCD show picture 10 “ Oil-Way”, press “DOWN” button one time, LCD show “ OFF”, and then press “ FUNC” button to turn off the fluid protection system.

Press “ VOLUME” button and adjust the smoke output into 100%, waiting for 1-2minutes, machine will work normally.

Press “ FUNC” button six time LCD show picture 10 “ Oil-way”, press “ UP” button LCD show “ ON” and then press “FUNC” again to turn on the fluid protection system.

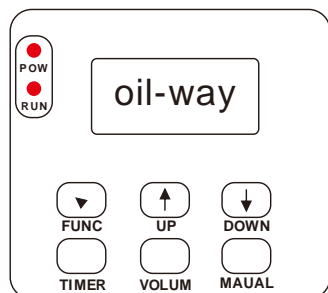

Picture 10. Fluid protection System ON and OFF

6. Wireless Controller

Distance: 30meter without obstacle

Function: Press “A” one time on emitter, machine is on!

Press “A” again, machine is off!

7. Packing list

1PCS Water low fog machine, 1PCS Emitter, 1PCS bottle, 1PCS Power cable, 1PCS Water tube, 1PCS User manual.

8.Care and Maintenance

It can reduce spare parts change and repair charge if you clean the machine termly.

- ※ Remove the filter, which protects the fan against dust and dirt, from time to time and clean it.
- ※ Check the state of the fluid filter from time to time and clean or replace it when necessary.
- ※ After several hours of operation, some droplets of condensation will have formed at the nozzle. That is normal and not a malfunction.
- ※ Remove fluid droplets at the nozzle only when the machine has completely cooled off.
- ※ Please keep the liquid clean, do not put in other material. Do not use the contaminated liquid. Please lid the bottle after putting in the liquid.
- ※ Please note: The vaporizer of our machines does not have to be cleaned! If open and clean by yourself not professional and damage the vaporizer, we can not grant warranty in this case.

9. Trouble-shooting

Trouble: The pump runs, but little or no smoke is produced.

Cause: The pump sucks no or too little fluid.

- Check whether the canister is empty
- Check whether the brass collar is properly connected with the brass coupling
- Check whether the fluid filter in the canister is clogged
- Check whether the fluid tube is twisted or defective

Trouble: The console can't be controlled normally.

Cause: Connection from the machine to the console is faulty.

- Check whether the plug is plugged in correctly
- Check whether the cable is defective
- Check whether the DMX start address is adjusted correctly
- If just some console can't be controlled normally, please exchange the XLR house line and signal line.

Trouble: During operation the machine fail to work for a long time

Cause: The over-temperature protection device is activated.

- Check whether the fan is clogged
- Turn off the power for a moment, then turn on the power again.

Trouble 4: The vaporizer is clogged.

- Please send the machine to the service-station or your local dealer.

10. Specifications

Power: 2000W

Voltage: AC220-250V 50/60Hz

Fuse: 15A

Heat up time: 3.5mins

Fog Liquid tank: 2L

Fog Liquid consumption: 25ml per minute (100% output)

Water consumption: 220ml per minute (100% output)

Smoke output: 100m²/min

Controller:LCD controller & Wireless controller & DMX512(1CH)
Electronic temperature control system
Water level sensor systems
Fluid protection system
Non-leak bottle
N.W.:39.5KG
Size:55*37*47.5cm

11. Warranty conditions

1. Free of charge, we will repair any defect or fault in the unit if it is caused by a proven factory fault and has been advised immediately after appearance and within 12 month of delivery to the end user.

2.. The following are not in the warranty

※ The right of guarantee service is lost if fluids other than the original “ water low fog liquid” have been used or if units are sent to us with full fluid bottles.

※ Also non compliance with the instructions in this manual or mistakes by incorrect handling/treating of the machine will lead to a loss of guarantee and also any faults and damages caused by undue force.

※ The customer loses all rights for guarantee services, if any repairs or adjustments are done to the units by unauthorized persons and/or if spare parts are used which are nor approved by us.

3. Certain parts of the machine are „consumable parts “ and are not covered by the warranty.

4. Guarantee services do not cause an extension of the guarantee time or the start of a new guarantee time. The warranty for replaced parts ends with the guarantee time of the whole unit.

5. Guarantee Service will be done in the following way: Faulty parts will be repaired or replaced (our choice) with correct parts.

Faulty units have to be brought to us or our service centers or to be sent to us or our service centers at customer ‘s expenses. The invoice and/or receipt showing the purchase date and the serial number have to come with the faulty unit, otherwise this will not be guarantee service.

Replaced parts become our property.

6. If you should send the unit for service, do not forget to remove any liquid from the fluid bottle.

