

## HE620 Semi open monitoring headphone

### GENERAL DESCRIPTION

HE620 is a semi open monitoring headphone. 50mm dual-diaphragm drivers ensure that separate the bass tones from the mids and highs for clean, detailed sound. The sound of HE620 is natural and delicate, its outstanding resolution and penetration make the scene feeling and more vivid. Adjust the earcup from headband until they fit comfortable on ear which reduces the sound leakage for pure audio.

### FEATURES

- \* Semi open monitoring headphone;
- \* 50mm dual-diaphragm drivers;
- \* The adjustable headband makes comfortable wearing.

### STORAGE

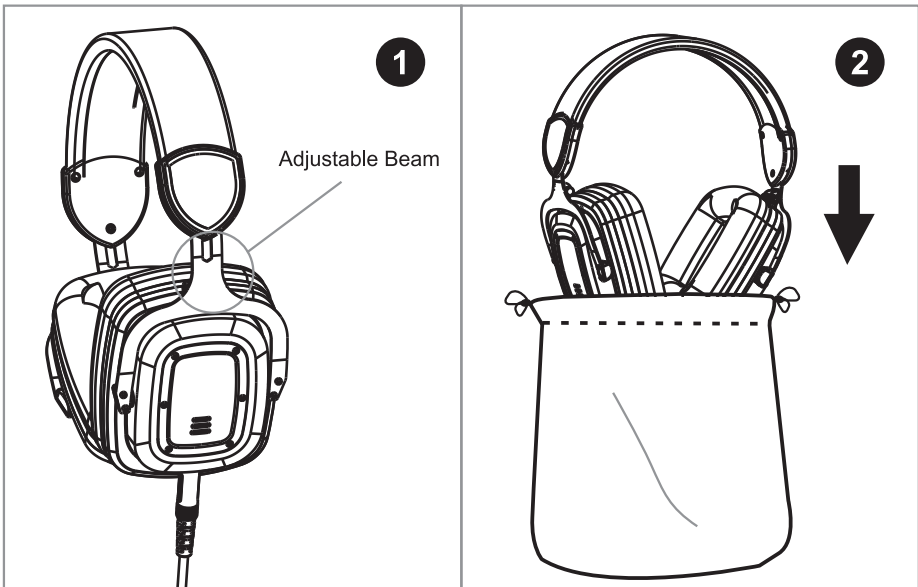

## CAUTION

\*To clean the headphones, use a soft damp cloth. If necessary, the headphones can be cleaned with soapy water (use a mild cleanser such as washing-up liquid). Note: Do not use solvent-containing cleansers;

\*Avoid using headphones at high volume. Hearing experts advise against continuous, loud and extended play.

If you experience a ringing in your ears, reduce the volume or discontinue use;

\*This product effectively shields external sound, so you may not hear sound around you clearly while wearing the headphones. Adjust the volume to a level where you can still hear background sound and constantly check safety around you while listening to music;

\* If you feel sick while using the headphones, stop use immediately;

\* In particularly dry air conditions, noise or sound skipping may occur, or mild tingling may be felt on your ears. This is a result of static electricity accumulated in the body, and not a malfunction of the headphones. The effect can be minimized by wearing clothes made from natural materials.

## TECHNICAL SPECIFICATIONS

- \* Transducer type: Dynamic, Neodymium magnet
- \* Transducer size: 50mm
- \* Rated impedance:  $32 \Omega \pm 15\%$  at 1KHz
- \* SPL:  $115 \pm 3 \text{dB} (0 \text{dB} = 20 \mu \text{Pa})$  at 1KHz , Input: 0.179Vrms
- \* Frequency response: 20-20000HZ
- \* Sensitivity: 95dB SPL/mW (at 1 khz)
- \* Rated power: 30mW
- \* Max Input power: 750mW
- \* Connector : Gold-plated 3.5 mm (1/8") stereo mini jack plug with \* 6.35 mm (1/4") threaded Adapter
- \* Cable : 3m, (9.8 ft) coiled, detachable, non-PVC, Oxygen-free copper (OFC)

Copyright © Ningbo Alctron Electronics Technology CO.,LTD. All rights reserved. Specifications and appearance subject to change without notice.

Ningbo Alctron Electronics Technology CO.,LTD.  
No.76 SanCheng Road, XiuFeng Industrial Area,GaoQiao Town, NingBo, China.  
Tel:+0086 574 87150672  
Fax:+86 574 87157176  
E-mail:info@alctron-audio.com  
www.alctron-audio.com

## HE620半封闭式监听耳机

### 产品介绍

HE620是一款半封闭式的头戴式监听耳机。整体由工程塑料搭配不锈钢材质制作，两个50mm大驱动单元确保低音从高音和中音中分离时依旧清晰动听。HE620声音纯净自然、细腻清澈，其非凡的解析力、穿透力，能够将音乐的现场感、层次感表现得淋漓尽致。抽拉式可调节头梁使得耳机佩戴的更加舒服，同时减少声音的外漏。

### 特征

- \* 半封闭式的头戴式监听耳机；
- \* 两个50mm的驱动单元；
- \* 可调节的头梁确保耳机佩戴舒适。

### 存放方法

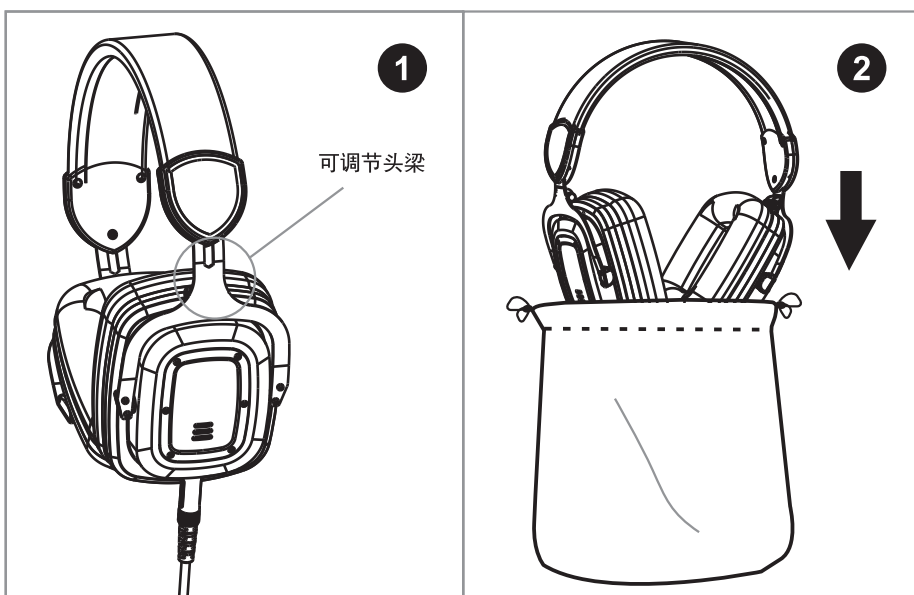

## 安全事项

- \* 请使用柔软的湿布清洗耳机，如有需要，耳机可以用稀释的肥皂水清理（注意：请勿使用含有溶剂的清洁剂！）；
- \* 避免以高音量使用耳机。听力专家建议不要进行连续、高音量和长时间播放。如果耳朵产生耳鸣，请降低音量或停止使用；
- \* 本产品能有效地屏蔽外界声音，因此在戴上耳机时可能无法清晰听到周围的声音。请调节音量为同时能听到周围声音，并在听音乐时注意身边安全；
- \* 如果您在使用耳机时感到不适，请立即停止使用；
- \* 在特别干燥的空气条件下，可能会出现噪音或跳音，或耳朵可能会感到轻微刺痛。这是由于体内积聚的静电所致，并非耳机故障。穿着天然材料制成的衣服可以将此影响减到最小。

## 产品参数

- \* 传感器类型： 钹磁铁动圈
- \* 传感器尺寸： 50毫米
- \* 额定阻抗： 19  $\Omega$   $\pm$  15% (at 1kHz)
- \* 声压级： 111 $\pm$ 2dB(0dB=20 $\Omega$ Pa) at 1kHz
- \* 频率范围： 20-20000hz
- \* 灵敏度： 95dB SPL/mW
- \* 额定功率： 30mw
- \* 最大输入功率： 750mW
- \* 失真率： 200hz-3kHz $\leq$ 2%
- \* 接头插头： 镀金 3.5 毫米（1/8 英寸）立体声迷你插头和6.35 毫米（1/4 英寸）
- \* 缆线： 3 米, (9.8 英尺) 线圈, 可拆卸, 非 PVC, 无氧铜 (OFC)

版权所有©宁波奥创电子科技有限公司,所有权保留。必要的技术数据和外观更改恕不另行通知。

宁波奥创电子科技有限公司

地址：浙江省宁波市海曙区秀丰工业区三成路76号

电话：+86 574 87150673

传真：0574-87157176

邮箱：sales@alctron-audio.com

网址：<http://www.alctron-audio.com>

全国统一服务热线：4000-160-112