

Technical Manual

AWC159

SPECIFICATIONS



ACOUSTIC & ELECTRICAL SPECIFICATIONS:

- Frequency Range (-10 dB): 52 Hz – 20 kHz
- Frequency Range (+/- 3 dB): 80 Hz – 20 kHz
- Maximum SPL Output: Direct 8 Ω: 125 dB (peaks of 131 dB).
300 W Tap: 123 dB (peaks of 129 dB).
- Rated Impedance: 8 ohms.
- Long-Term System Power Rating (IEC, full bandwidth pink noise with 6 dB crest factor): 500 W (2000 W peak, 2 hrs).
300 W (1200 W peak), 100 hrs.
- Transformer Taps: 70V: 300W, 150W, 75W, 38W
100V: 300W, 150W, 75W

SYSTEM COMPONENTS:

- Grille: 5057507 (Black); 5057496 (Gray)
- Low Frequency Driver: Kevlar-reinforced cone with weather treatment, 75 mm (3 in) voice coil.

SYSTEM COMPONENTS: (CONT'D)

- High Frequency Driver: 2408H-2 38 mm (1.5 in) diaphragm and voice coil diameter, patented high-temperature annular polymer diaphragm, copper-clad aluminum coil, fluid cooled.
- System D.C. Resistance: 4.8 ohm +/- 0.2 ohm

AURAL SWEEP TEST SPECIFICATIONS:

- A. System Aural Sweep Test: 7 V Input, 50 Hz to 20 kHz

PHYSICAL SPECIFICATIONS:

- Dimensions: 486 X 486 X 479 mm (19.1 X 19.1 X 18.8 in), cabinet 507 mm (19.9 in) depth with gland nut
546 mm (21.5 in) including bracket extending to back 20.6 kg (45.5 lb), 23.4 kg with u-bracket
- Net Weight:

WARRANTY INFORMATION:

- Refer to Warranty Statement packed with each product.

PACKAGING:

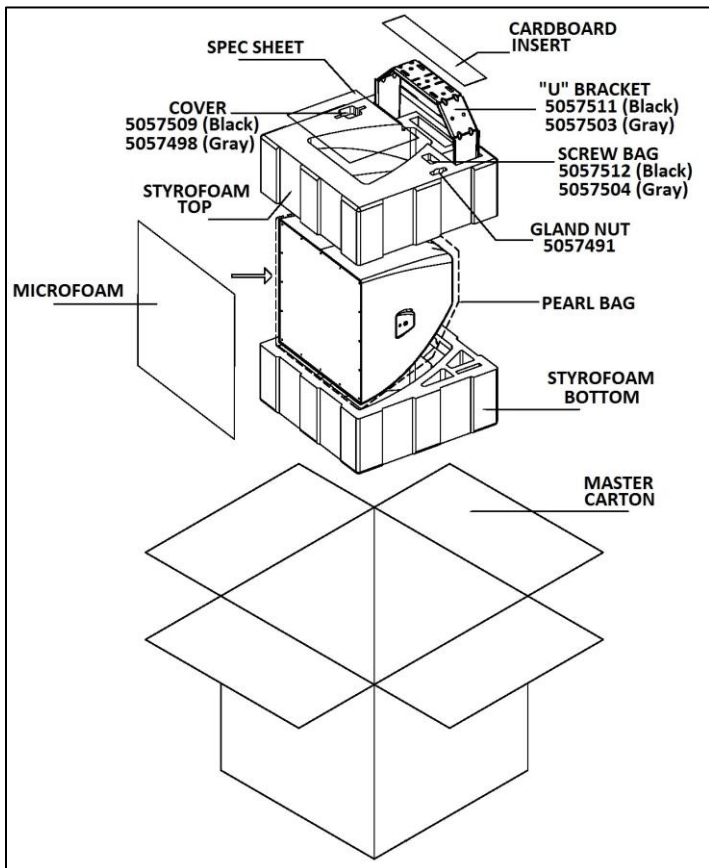

WIRING DIAGRAM:

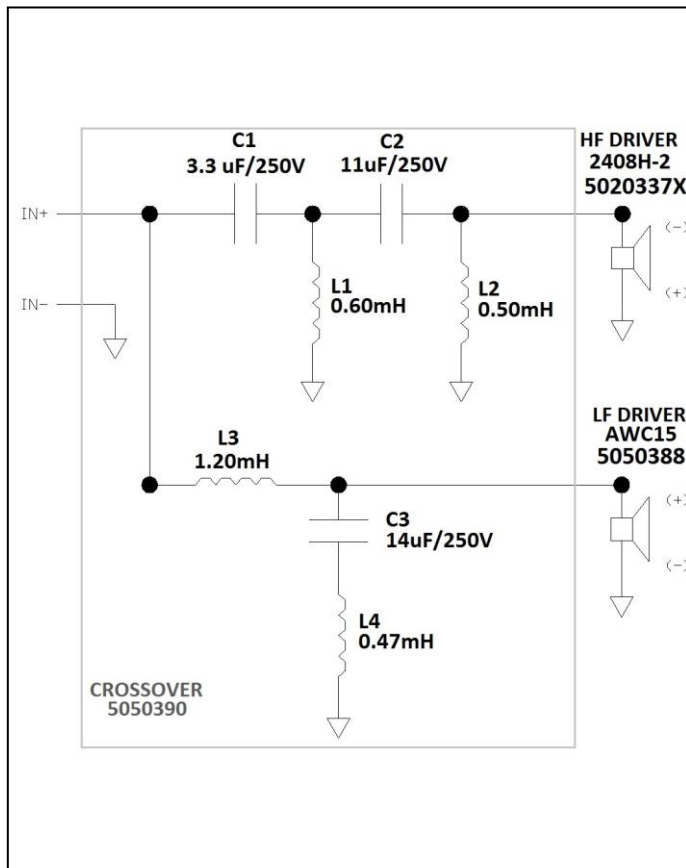

CONTROL AWC159

EXPLODED VIEW:

See next page for part numbers

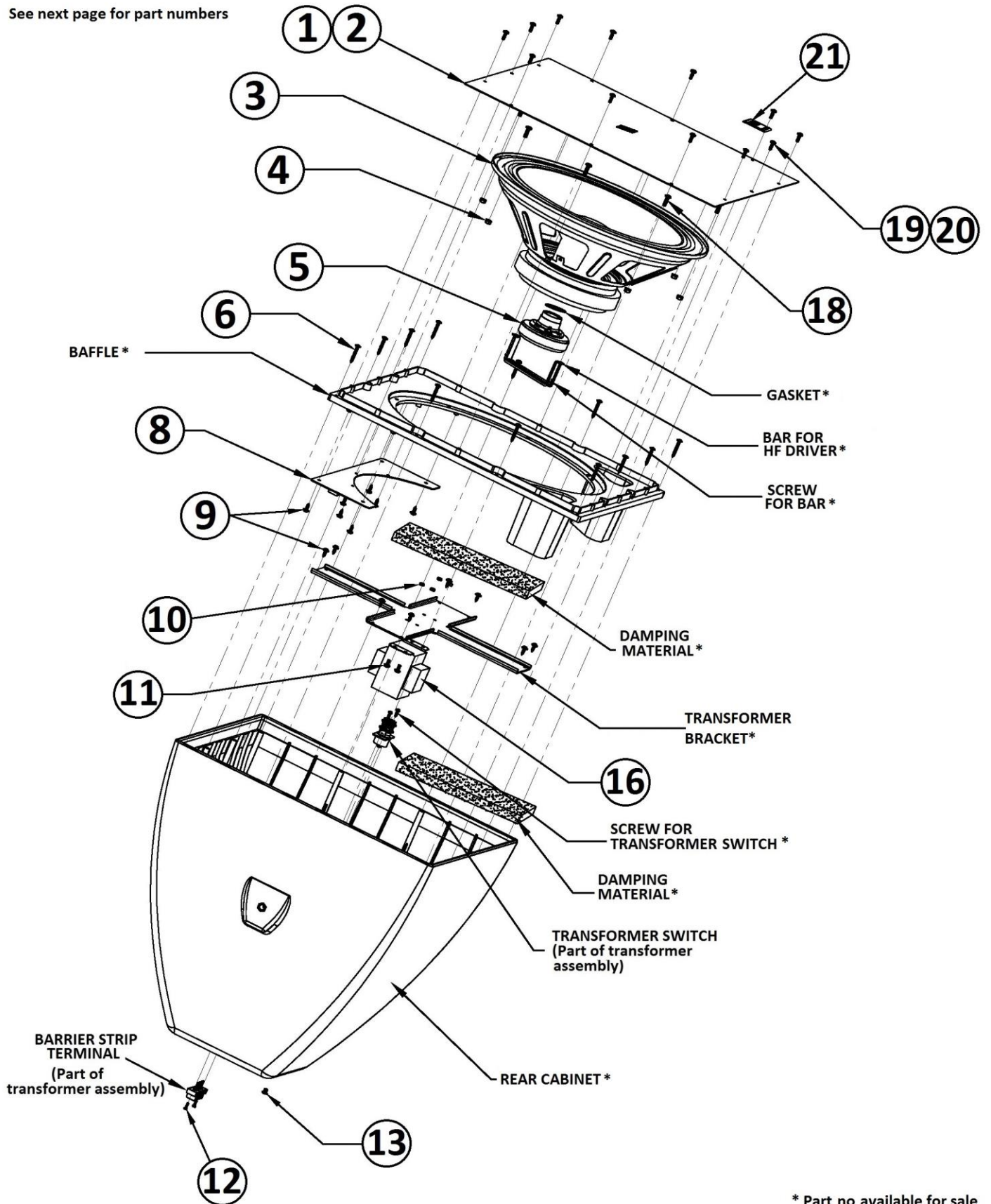

* Part no available for sale

CONTROL AWC159

PARTS LIST:

Item	Part Number	Description	Qty.
1	5057496	GRILLE GRAY	1
2	5057507	GRILLE BLACK	1
3	5050388	WOOFER	1
4	5057485	NUT FOR WOOFER	8
5	5020337X	HF DRIVER	1
6	5057484	SCREW FOR BAFFLE TO CABINET	12
8	5050390	CROSSOVER	1
9	5057481	SCREW FOR BRACKET TO CABINET	51
10	5057479	SCREW FOR BRACKET TO TRANSFORMER	4
11	5057463	SCREW FOR TRANSFORMER	4
12	5057454	SCREW FOR BARRIER STRIP TERMINAL	2
13	5057495	SILICONE PLUG	1
16	5050392	TRANSFORMER	1
18	5057486	SCREW FOR WOOFER TO BAFFLE	8
19	5057508	SCREW FOR GRILLE TO BAFFLE (BLACK)	12
20	5057497	SCREW FOR GRILLE TO BAFFLE (GRAY)	12
21	5057487	LOGO	1

DIMENSIONS:

