

**IMPORTANT!** Read entire instruction sheet before you start installation and assembly.

**MAX Load Capacity:**  
25 lb (11.4KG)

**IMPORTANT!** The product is made to support screens with a Vesa compliant hole pattern.  
For safe mounting, mounting screws must turn at least three times in the screen inserts.

**Parts List**

Description	LCV-100	
	Qty.	Part #
A mount assembly	1	091-1091
B 3mm allen wrench	1	560-0073
C mounting base	1	091-1089
D adapter plate	1	095-4354
E M4 x 8mm countersink screw	4	520-1795
F M4 x 10mm phillips screw	4	520-1796
G wood screw #14 x 1	4	510-9159
H hex bolt	1	-
I hex nut	1	-
J M4 x 0.7mm nut	4	530-1082
K pressure plate	1	-

**LCV-100**

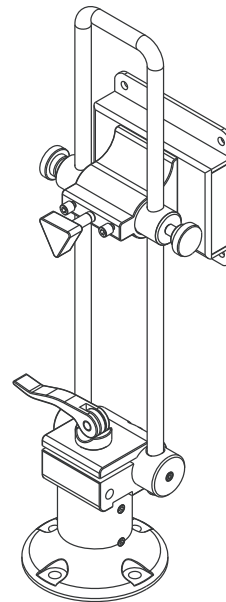

**NOTE:** You may not use all hardware provided.  
**NOTE:** Some parts may not appear exactly as illustrated.

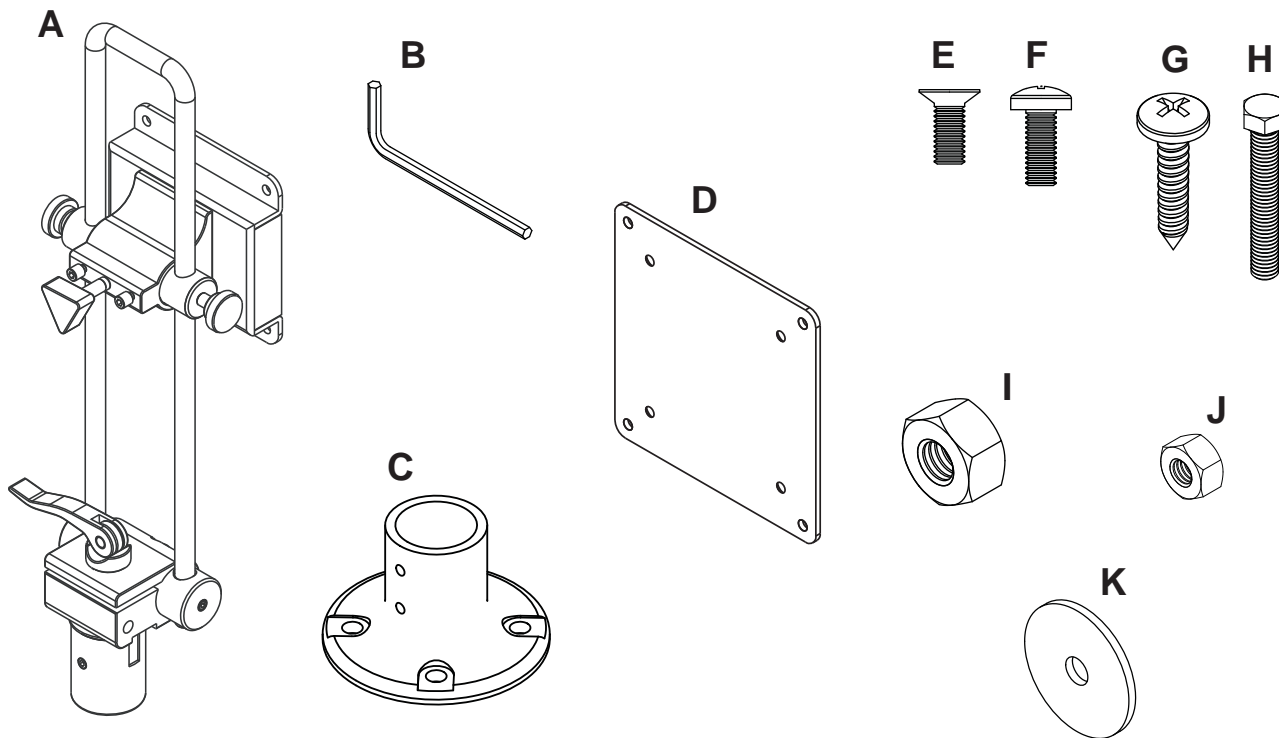

- 1 Remove telescopic pedestal (A) from mounting base (C) by loosening set screws where shown with 3 mm allen wrench (B).

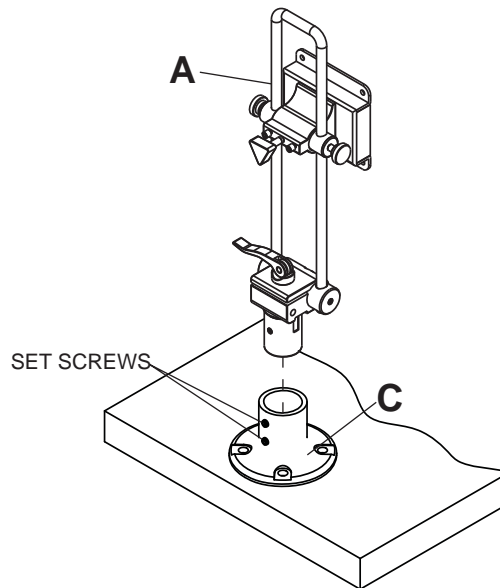

## 2

### ⚠ CAUTION

- Mount must be installed on wood and/or wood composition surfaces of at least 3/4" thick. However, the installer must ensure that the mounting surface will safely hold the combined weight of the mount and the screen. See other mounting requirements below.

**There are two methods of installation.** Follow step 2-1 for installation using hex bolt and pressure plate or step 2-2 using four wood screws.

- 2-1 Mark hole on desktop for positioning mount. Drill one 1/2" dia. hole through desktop. Attach mounting base (C) to desktop using hex bolt (H), pressure plate (K), and hex nut (I). Tighten nut using proper sized wrench.

**Important!** Mount is to be installed onto desktops 3/4" to 1-5/8" thick only! For thicker mounting surfaces, you may have to provide your own hardware.

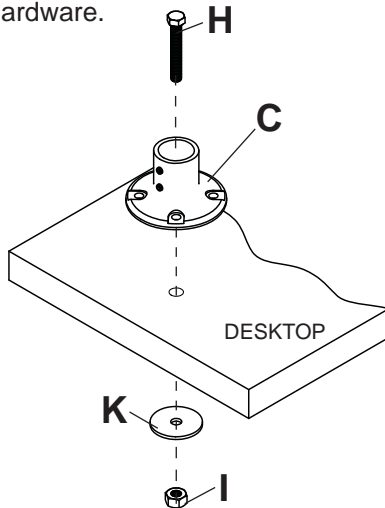

- 2-2 Use four holes on mounting base (C) to mark holes on desktop for positioning mount. Drill four 3/16" dia. holes through desktop. Attach mounting base (C) to desktop using four wood screws (G).

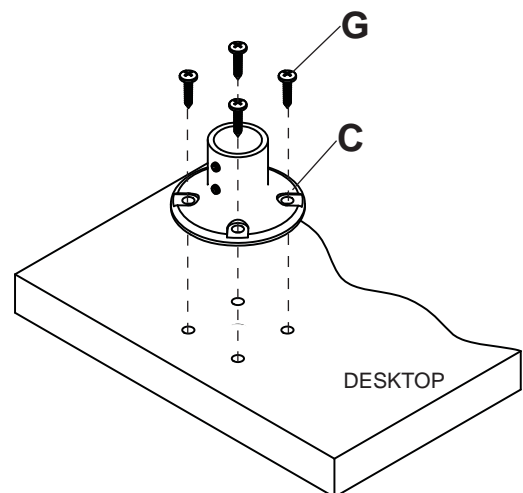

- 3** Insert telescopic pedestal (A) into mounting base (C). Tighten set screws where shown with 3 mm allen wrench (B).

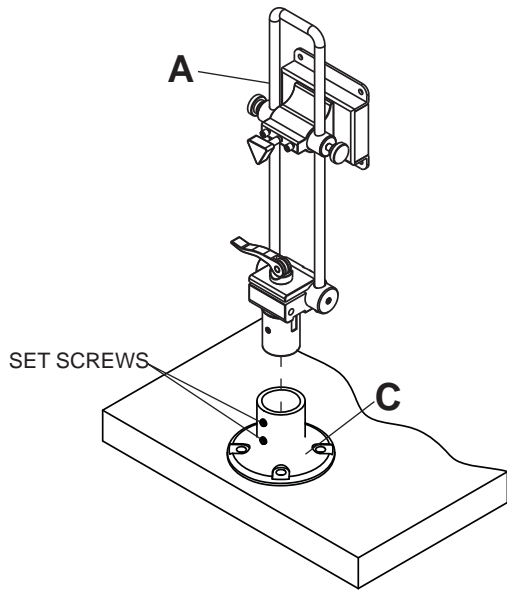

- 4** To install to a VESA 75 mm standard LCD monitor, attach mount assembly (A) to back of LCD monitor using four M4 x 10 mm phillips screws (F) as shown.

Skip to step 6.

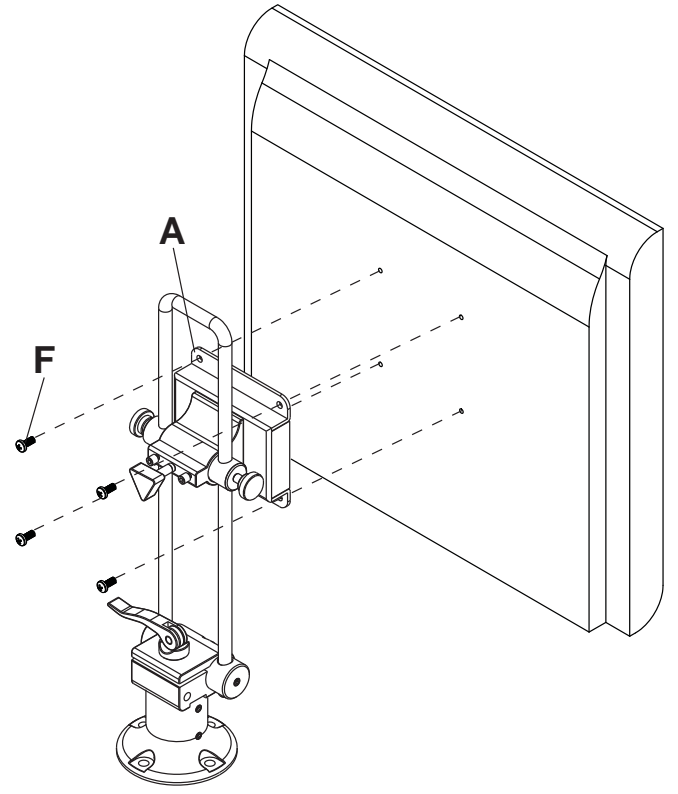

- 5** To install to a VESA 100 mm standard LCD monitor, attach adapter plate (D) to mount assembly (A) using four M4 x 8 mm phillips screws (E) and four M4 x 0.7mm nuts (J) as shown in detail 1. Attach mount assembly (A) to back of LCD monitor using four M4 x 10 mm phillips screws (F) as shown in detail 2.

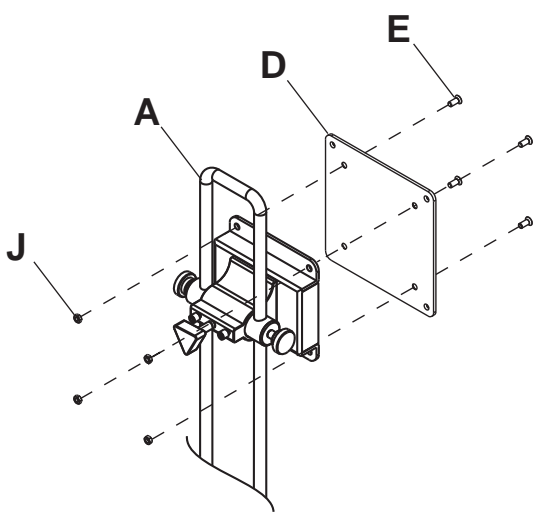

DETAIL 1

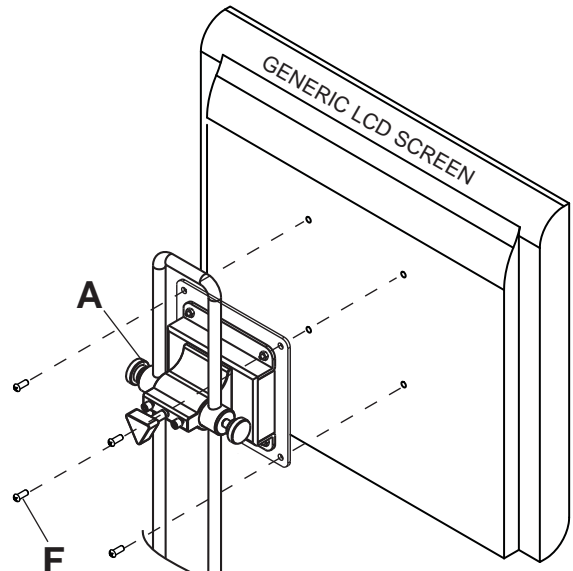

DETAIL 2

**6** To adjust tilt position of stand: Hold the screen with one hand, and loosen the handle. Move to desired position and tighten down handle to lock position, shown in **detail 3**.

To adjust height position: Hold the screen with one hand, and turn the circular knobs counterclockwise. Move to desired position and tighten the knob to lock position, shown in **detail 4**.

To adjust tilt position of display: Turn triangular shaped knob to adjust display to the desired angle, shown in **detail 5**.

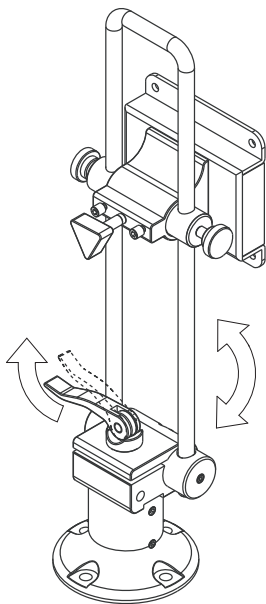

**DETAIL 3**

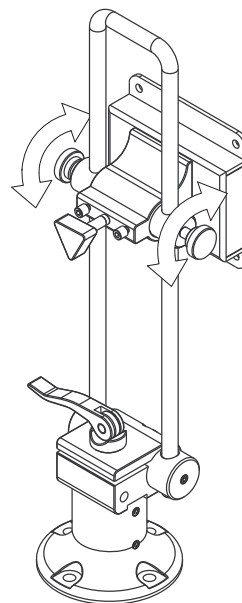

**DETAIL 4**

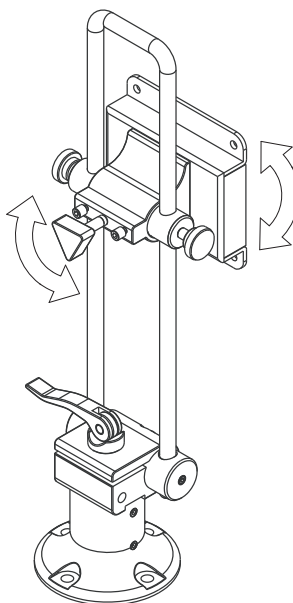

**DETAIL 5**