

# ULTRABASS BXD3000H

**Ultra-Lightweight 300-Watt  
2-Channel Bass Amplifier Head  
with FBQ Spectrum Analyzer,  
Ultrabass Processor and Compressor**

- Ultra-compact 300-Watt 2-channel bass amplifier
- Revolutionary Class-D amplifier technology: enormous power, incredible sonic performance and ultra-lightweight
- Clean channel with dedicated Gain control
- Distortion channel with dedicated Gain, Shape and Level controls
- Ultra-musical, active 7-band graphic EQ with FBQ Spectrum Analyzer
- Revolutionary “see what you play” FBQ frequency indicator for instant sound shaping
- Switchable Ultrabass subharmonics processor for unbelievable low-end power
- Integrated Compressor smooths out volume peaks when playing dynamic slaps
- Dual footswitch for channel select and Ultrabass function included
- Separate Headphone output—perfect for quiet practicing
- Balanced XLR DI and Line outputs for direct connection to your mixing console
- CD input allows you to play along to your favorite music
- Dedicated FX Insert for external effects devices (stomp boxes, rack effects, etc.)



The ULTRABASS BXD3000H is a 300-Watt 2-channel bass amp head designed specifically for the bass player who requires the ultimate in tonal versatility. Armed with our proprietary Ultrabass sub-harmonics processor, the BXD3000H cranks out unbelievable low-end, plus our revolutionary Shape filter provides precision sound sculpting to satisfy even the extreme tone connoisseur. Class-D design puts massive output power into a package that weighs in at less than 7.7 lbs./3.5 kg, giving you all the power of a traditional-technology bass amp, without the backbreaking weight.

The BXD3000H is equally at home onstage or in the studio thanks to its built-in XLR DI and Line outputs. There's even an FX Insert so you can access your favorite stompboxes and other external processors. And since modern bass players need a broad range of sounds, we've given the BXD3000H the flexibility to go head-to-head against even the toughest competition, at a price unheard of for this class.

### Superb Transient Response

We spent years fine-tuning the technology that gives our high-density Class-D amps their oomph. By carefully selecting components with extremely high slew rates and optimizing other proprietary parts of our circuitry, these amps react instantly to even the most demanding electronic bass impulses.

When this amazing amplifier technology is combined with our state-of-the-art switching-mode power supplies, these amplifiers provide tremendous punch. And because they are so much more efficient than conventional designs, they run cooler and don't require the massive heat sinks and heavy toroid transformers typically associated with their conventional counterparts. The BXD3000H provides 300 of the cleanest, punchiest bass Watts you've ever heard, at a fraction of the weight of the competition.

*Continued on next page*



# ULTRABASS BXD3000H

- Rack mount brackets included
- “Planet Earth” switching power supply for maximum flexibility (100 - 240 V~), noise-free audio, superior transient response plus low power consumption for energy saving
- High-quality components and exceptionally rugged construction ensure long life
- Conceived and designed by BEHRINGER Germany

## Secret Weapon #1

Tone. That's what it all comes down to—and the BXD3000H really delivers! Channel 1 provides squeaky-clean operation for the most true-to-life sound of your bass. If you prefer a more aggressive sound, switch to Channel 2 via the front panel button or the supplied dual-function footswitch and

use Gain 2 to dial in the perfect amount of grind. For even more tonal variation, we've provided our proprietary Shape control, which lets you call up a broad range of sounds, anything from mild to wild! And if your gig calls for two basses, say a fretted and a fretless, you can use Channel 2 and the Shape control to fine-tune the sound of a second instrument.

*Continued on next page*

## Front Panel

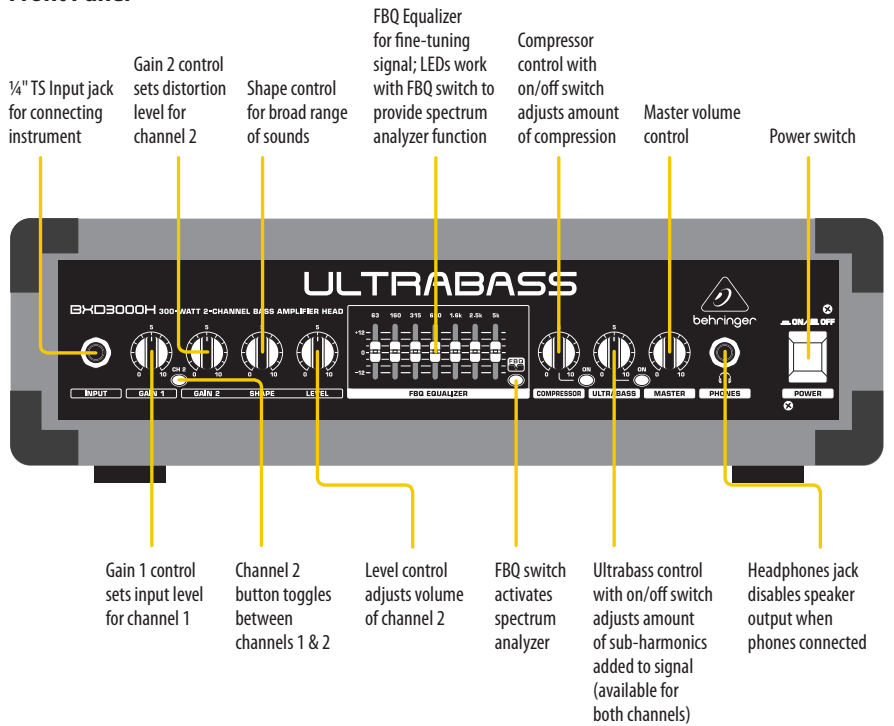

## Rear Panel

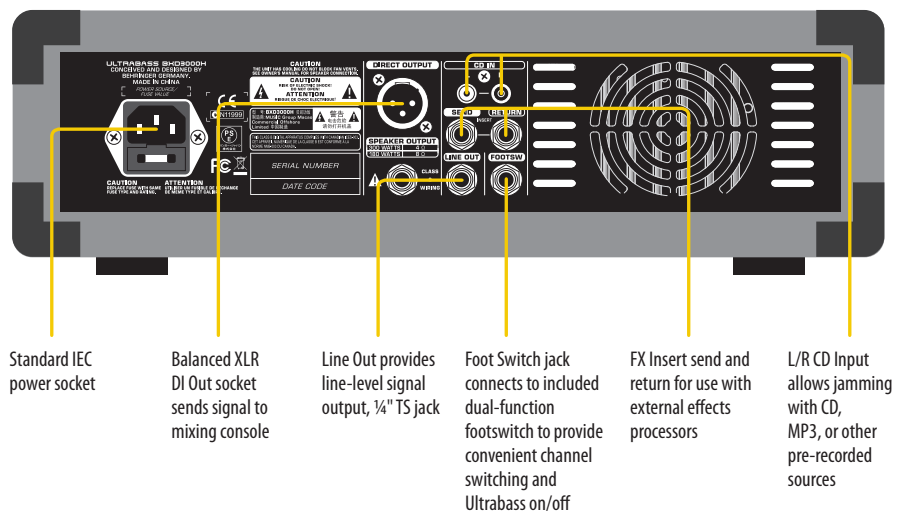

# ULTRABASS BXD3000H

## Onboard 7-Band FBQ Equalizer

Our revolutionary FBQ Equalizer allows you "see-what-you-play". In normal mode the individual frequency bands can be raised or lowered to fine-tune your sound. But by engaging the FBQ button, you get the power of a dedicated spectrum analyzer right at your fingertips. Now the LEDs on the seven frequency sliders illuminate in varying levels of intensity, showing you exactly which bands need to be adjusted for optimal performance. This is especially handy for eliminating the low-frequency feedback typically associated with hollow-body, acoustic and upright basses.

## Make a Good First Compression

Back in the "good old days" bass players used their thumb, fingers or a pick to lay down the bottom end. But modern bass players are called upon to provide a much broader palette of styles and techniques. Two-handed tapping and slapping are just a couple of the performance styles that benefit from compression and limiting. Our highly musical onboard limiter works in the background to keep your amp from going into clipping distortion, which protects your speakers without affecting your tone. The switchable Compressor is fully adjustable and extremely effective at bringing out even the subtlest nuance of your performance.

## Secret Weapon #2

When activated, our proprietary Ultrabass processor adds a signal that is one octave lower than the input signal. This sub-harmonic content adds incredible depth to bass lines, making them powerful and punchy. Just press the Ultrabass button or use the included footswitch, and dial in the desired amount of fat bottom end. Your audience won't know what hit them!

## Value

Sporting 300-Watts of output power, virtually unlimited tonal capability, lightweight Class-D technology and an equally lightweight price tag, the BEHRINGER BXD3000H bass head elevates performance and value to a new level. Try one out today at your authorized dealer and improve your bottom end without hurting your bottom line!

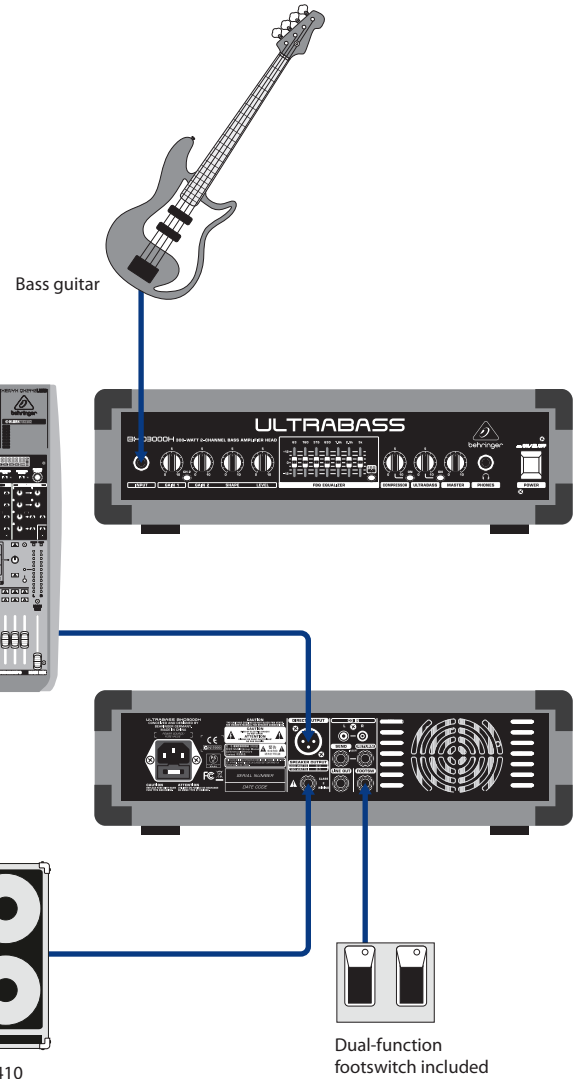

# ULTRABASS BXD3000H

## Specifications

### Audio Inputs

<b>Instrument Input</b>	¼" mono jack, unbalanced
Impedance	appr. 240 Ω,
<b>Power Amp Input</b>	¼" mono jack, unbalanced
Input impedance	appr. 100 kΩ,
<b>CD Input</b>	¼" mono jack, unbalanced
Input impedance	43 kΩ

### Audio Outputs

<b>Phones Output</b>	¼" mono jack, unbalanced
Output impedance	appr. 47 Ω, unbalanced
<b>Direct Output</b>	XLR, balanced
Output impedance	appr. 200 Ω
<b>Line Output</b>	¼" mono jack, unbalanced
Output impedance	appr. 200 Ω
<b>FX Insert Send</b>	¼" mono jack, unbalanced
Output impedance	appr. 2.2 kΩ
<b>Loudspeaker Connectors</b>	1 x ¼" mono jack, unbalanced 1 x professional speaker connector
Load impedance	min. 4 Ω

### System Data

<b>Max Output Power</b>	300 W @ 4 Ω or 180 W @ 8 Ω
-------------------------	----------------------------

### Power Supply / Voltage (Fuses)

USA / Canada	120 V~, 60 Hz (T 5 A H 250 V)
UK / Australia / Europe	220-240 V~, 50/60 Hz (T 2.5 A H 250 V)
Korea / China	220-240 V~, 50/60 Hz (T 2.5 A H 250 V)
Japan	100 V~, 50/60 Hz (T 5 A H 250 V)

<b>Power Consumption</b>	max. 85 W
--------------------------	-----------

<b>Mains Connection</b>	Standard IEC receptacle
-------------------------	-------------------------

### Dimensions/Weight

<b>Dimensions (H x W x D)</b>	appr. 4.6 x 17.7 x 8.9" appr. 117 x 450 x 225 mm
-------------------------------	---

<b>Weight</b>	appr. 7.7 lbs / 3.5 kg
---------------	------------------------

Please note these specifications are preliminary and conceptual in nature, and as such are subject to change as product development progresses. This information is supplied for market research purposes only and is not to be made public in any manner. This document is solely the property of The MUSIC Group, or one of its subsidiaries, and must be surrendered upon request of the owner.

For service, support or more information contact the BEHRINGER location nearest you:

**Europe** MUSIC Group Services EU GmbH  
Tel.: +49 2154 9206 4149

**USA/Canada** MUSIC Group Services US Inc.  
Tel.: +1 425 672 0816

**Singapore** MUSIC Group Services SG (Pte.) Ltd  
Tel.: +65 6845 1800

**Australia** MUSIC Group Services AU Pty Ltd  
Tel.: +61 03 9877 7170

**Japan** MUSIC Group Services JP K.K.  
Tel.: +81 3 5281 1180

This device has not been authorized by the rules of the Federal Communications Commission. This device is not, and may not be, offered for sale or lease, or sold or leased in the 50 U.S. states, the District of Columbia and U.S. possessions, until authorization is obtained. Technical specifications and appearances are subject to change without notice and accuracy is not guaranteed. BEHRINGER is part of the MUSIC Group (music-group.com). All trademarks are the property of their respective owners. MUSIC Group accepts no liability for any loss which may be suffered by any person who relies either wholly or in part upon any description, photograph or statement contained herein. Colors and specifications may vary from actual product. MUSIC Group products are sold through authorized fulfillers and resellers only. Fulfillers and resellers are not agents of MUSIC Group and have absolutely no authority to bind MUSIC Group by any express or implied undertaking or representation. This manual is copyrighted. No part of this manual may be reproduced or transmitted in any form or by any means, electronic or mechanical, including photocopying and recording of any kind, for any purpose, without the express written permission of MUSIC Group IP Ltd. ALL RIGHTS RESERVED. © 2012 MUSIC Group IP Ltd. Trident Chambers, Wickhams Cay, P.O. Box 146, Road Town, Tortola, British Virgin Islands