

Bowers & Wilkins

P15  
Wireless  
Headphones

## Welcome to Bowers & Wilkins and PI5

Thank you for choosing Bowers & Wilkins. When John Bowers first established our company, he did so in the belief that imaginative design, innovative engineering and advanced technology were keys that could unlock the enjoyment of audio in the home.

The Bowers & Wilkins PI5 are high performance in-ear headphones designed to deliver the highest quality mobile personal audio experience combined with the convenience of wireless operation and the serenity of noise-cancellation. This manual will tell you everything you need to know to get the most from your PI5 headphones.

Your PI5 can play music streamed wirelessly from your mobile phone, tablet or computer via Bluetooth. PI5 can also be used for wireless telephony.

PI5 Real World Listening features include our latest innovations in Adaptive Noise Cancellation, Ambient Pass-Through and enhanced Wear Sensing technologies. Our latest generation noise cancellation feature was designed from the ground up with intelligent environment sensing capabilities, automatically selecting the appropriate type of noise cancellation best suited to your surrounding environment, its only goal is to deliver an uncompromised listening experience. Ambient Pass-Through enables external sounds, such as conversation or safety announcements, to be heard clearly without any need to remove the headphones. The Wear Sensing feature enables PI5 to respond naturally, pausing and resuming the music simply by lifting either earpiece on or off your ear. These features can be enabled and further customised via the Bowers & Wilkins Headphone App available for free on iOS and Android devices.

PI5 incorporates a rechargeable battery pack. When fully charged, depending on the degree of Bluetooth, Adaptive Noise Cancellation and Ambient Pass-Through use, the battery pack can provide up to 12 hours of continuous wireless media streaming with noise cancellation enabled at average playback volume levels.

# 1. PI5 Carton Contents

- PI5 Headphones with ear tips (M)
- Charge Case
- USB-C Charging Cable
- Ear Tips (S/L)
- Literature Pack

## 2. Getting to know your PI5

### 2.1 Switching Headphones On and Off

#### Switching On/OFF

The PI5 does not have a power control and the power management is automatic. Your PI5 ear buds will charge when placed into the charging case and will be ready to use when they are removed from the charging case.

When your ear buds are removed from the charging case they will enter a power saving mode after 5 minutes of not use. To exit this low power mode start using the earbuds again, by connecting your paired device, streaming audio, or placing the ear buds into your ears.

### 2.2 Headphone Controls

Each ear bud has a multi-function button located on the flat round section of the ear bud. The multi-functionally button controls for:

Media Playback:

Function	Action
Play or pause	Press the Multi-function button once.
Play to next track	Press the Multi-function button twice in quick succession.
Play previous track	Press the Multi-function button three times in quick succession.

Phone call functionality:

Function	Action
Answer Call	Press the Multi-function button once with incoming call
End Call	When incoming call occurs, press the Multi-function button twice in quick succession.
Decline an incoming call	Press the Multi-function button twice in quick succession with incoming call.

(Please see Diagram 1)

## 3. Intelligent Features

### 3.1 Adaptive Noise Cancellation

Noise cancellation is a series of advanced technologies that aids in removing undesired noise from the surrounding environment.

PI5 features our latest innovations in adaptive noise cancellation, this includes noise cancellation and tuning best suited to your surrounding environment. As your surroundings change, noise cancellation will auto adapt to complement your new environment.

The Noise Cancellation can be toggle between On/Off by long pressing the left earbud for 1 second. (Please see Diagram 2).

Mode	Application
On	Removes undesired noise from the surrounding environment.
Off	Turns off the noise cancellation feature.

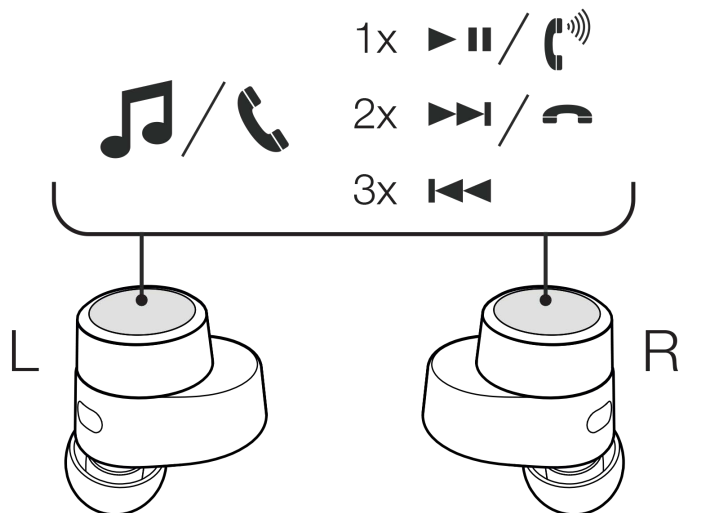

Diagram 1  
Headphone controls

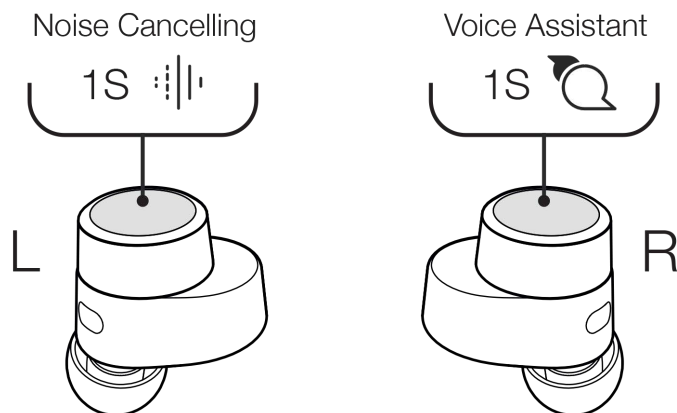

Diagram 2  
Headphone controls

### 3.2 Voice Assistance

Voice Assistance can be activated by long pressing the right earbud for 1 second.

### 3.3 Ambient Pass-Through

PI5 features ambient pass-through which lets some external noise from the surrounding environment, such as safety announcements, conversations or the ability to hear your surroundings without taking the headphones off.

Ambient pass-through can be enabled/disabled through Bowers & Wilkins headphone App. The level of ambient pass-through, High/Low/Off, can be adjusted to suite your needs through the App.

### 3.4 Wear Sensors

PI5 incorporates our latest enhanced wear detection sensors in both earbuds, which will automatically pause the music when you remove one ear bud from your ear and resuming the audio when you replace it.

The wear sensors also help battery conservation by entering standby when removed from the ears. When worn again, PI5 automatically wakes and connects to the last connected Bluetooth device.

Wear sensor can be turned ON/Off in the Bowers & Wilkins Headphone App.

*Note: Take care when wearing your headphones; hair or accessories trapped between your ears and the earpieces, or wearing glasses that distort the profile of your ears, may interfere with the performance of the proximity sensors.*

## 4. Stowing the Ear Buds

When not being worn in the ear, the PI5 ear buds can be stored and charged inside the charge case. The ear buds will be magnetically held in the charge case. The ear buds can only be stowed in one orientation.

*Note: Take special care when wearing your earphones, hair or accessories trapped between your ears and the ear buds may interfere with proximity sensing.*

## 5. Battery Charging

Your Bowers & Wilkins PI5 ships with the battery partially charged & may be used immediately. For best practice we recommend to fully charge the earphones before first use. Please allow up to 3 hours for full charge.

#### To charge the PI5 ear buds:

- Place the PI5 ear buds into the charge case
- Close the charge case lid

#### To charge the PI5 charge case with cable:

1. Please use the supplied USB charging cable and connect the USB plug to a USB wall charger or a powered computer USB socket.
2. Then connect the USB-C end to the charge case USB-C socket

*Note: During charging, the charge case indicator will blink green. When fully charged, the indicator will remain solid green. The charge case can be charge with or without the ear buds being housed inside the charge case*

#### To charge the PI5 charge case with a wireless charging station:

1. Place the charging case onto a wireless charging station
2. Ensure that the rear of the charging case is on the charging station (with the case indicator facing up)

*Note: During charging, the charge case indicator will blink green. When fully charged, the indicator will remain solid green.*

### 5.1 Status Indicator

The status indicator is located on the charge case provide information on the ear buds when they are located in the case and provide information on the charging case when the ear buds are removed.

With the Ear buds in the charging case. (Please see Diagram 3).

#### With the Ear buds in the charging case

Illumination	Operational state
Green (case lid open)	Ear bud battery charge > 40%
Yellow (after power on)	Ear bud battery charge >20%, <40%
Red (after power on)	Ear bud battery charge <20%
Red (blinking)	Ear bud factory Reset
Red (Solid)	Hardware Reset/ System Crash
Blue blinking	Pairing Mode Enabled
Blue (3 sec solid)	Pairing successful

Diagram 3  
Status indicator illuminations

#### With the earbuds removed from the charging case

Illumination	Operational state
Green (case lid open)	Ear bud battery charge > 40%
Yellow (after power on)	Ear bud battery charge >20%, <40%
Red (after power on)	Ear bud battery charge <20%
Red (blinking)	Factory Reset
Red (Solid)	Hardware Reset/ System Crash

Diagram 3  
Status indicator illuminations

## 6. Bluetooth Connectivity

### 6.1 Pairing

Your Bowers & Wilkins PI5 earphones are designed to stream music wirelessly from Bluetooth audio devices, such as smartphones, tablets, or computers. To do so, the earphones & device must first be paired.

When you receive your PI5 earphones they will be ready to pair to any Bluetooth audio device.

#### 6.1.1 iOS System/ Android System without GFP feature Pairing

1. Download the Bowers & Wilkins Headphone App
2. Open the charge case lid
3. The charge case indicator will flash blue
4. Go to the Bluetooth pairing menu of your device
5. Select the "Bowers & Wilkins PI5" from the device list
6. The charge case indicator will change to solid blue to indicate pairing is successful
7. Open the Bowers & Wilkins Home and add the headphones into the devices in the app

*Note: Your earphones will automatically exit Bluetooth pairing mode if no device is paired within 5 minutes. If pairing fails, the indicator will rapid flash blue, please try pairing again.*

To pair to a subsequent device. (Please see Diagram 4)

1. Open the charge case lid with the ear buds placed inside the charge case
2. Press and hold the button inside the charge case for between 1 and 5 seconds
3. The charge case indicator will flash blue
4. Go to the Bluetooth pairing menu of your new device
5. Select the "Bowers & Wilkins PI5" from the device list
6. The charge case indicator will change to solid blue to indicate pairing is successful

Your headphones can remember up to four paired Bluetooth Devices. Repeat the above steps to pair more devices.

*Note: Your earbuds will automatically exit Bluetooth pairing mode if no device is paired within 2 minutes. If pairing fails, the indicator will rapid flash blue, please try pairing again.*

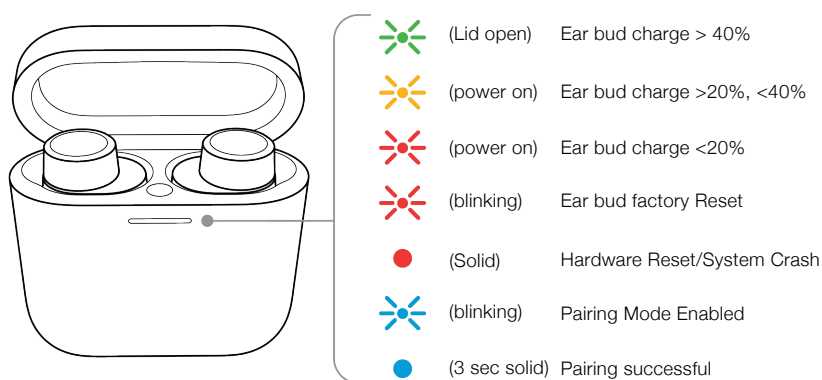

Diagram 3  
Status indicator illuminations

#### 6.1.2 GFP Pairing (For Android System integrated with GFP Feature)

To add your headphones:

1. Place the Case no further than 10 cm (4 inches) away from Android system cellphone (BT enabled) and Open the Case Lid.
2. A GFP (Google Fast Pair) notification window would pop up showing "Bowers & Wilkins PI5" detected" and request to start the pairing process"
3. Press "Notification" button on the window to enable the pairing.
4. Success connection will be shown in GFP window.
5. Once paired
  - o GFP window would lead user to Google Play to download/Install B&W Headphone App.
  - o L/R Earbud & Case Battery Level can be seen on the GFP window

#### 6.2 Disconnect from a device

You can quickly disconnect PI5 from a device by putting the earbuds back to the case. Alternatively, you can manage connection in further detail using the Bowers & Wilkins Headphones app under Connections.

#### 6.3 Setting Up Headphones with the App

The Bowers & Wilkins Headphones app provides extended setup and adjustments to features such as Adaptive Noise Cancellation, Ambient Pass-Through, and Wear Sensors. The app also provides further customisations such as voice prompt, level of ambient pass-through, connection management and headphone software updates. The app is available as a free download on iOS and Android devices.

To add your headphones:

1. From your mobile device, download and install the Bowers & Wilkins Headphones app.
2. Launch the app, then read and follow the instructions pertaining app notification and permissions.
3. After reaching the main screen, simply tap + and following the in-app instructions.

### 6.4 Headphone Software Update

Bowers & Wilkins will occasionally make available software updates that refine and optimise the performance of your headphones or add new features.

The Bowers & Wilkins Headphones app will notify you when a software update is available. Tap on the notification and the follow in-app instructions.

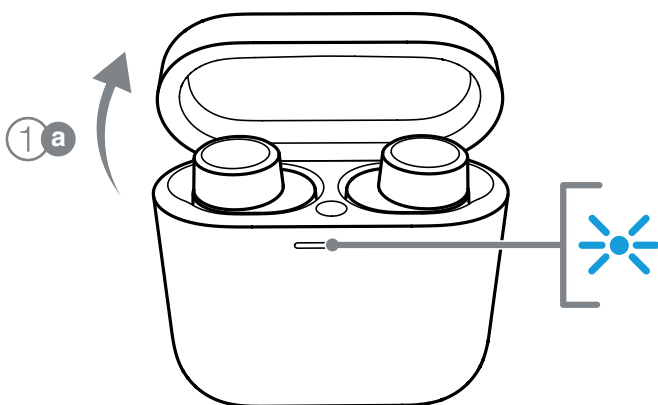
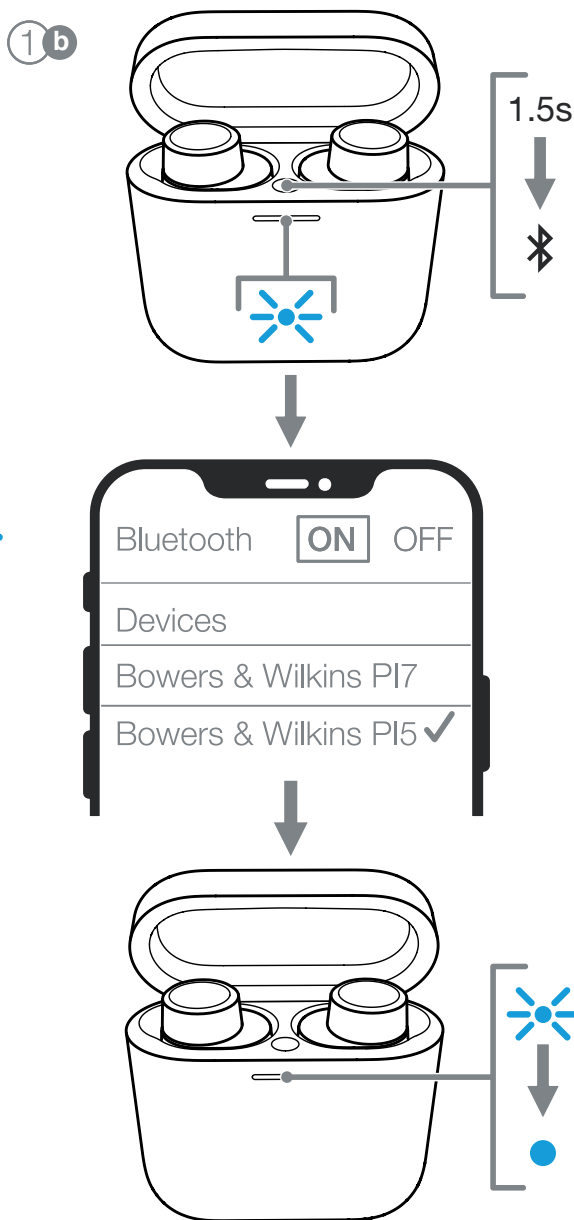

Diagram 4  
Bluetooth pairing



## 7. Wearing Your Headphones

Wearing your headphones correctly will help ensure you get the best possible experience, see Diagram 5.

Like many in-ear earphones, the PI5 earpieces are designed to seal the ear canal in order to perform optimally.

Ear tips come in three sizes (small, medium and large). Finding the proper size for your ear is critical to obtaining a good seal and ensure PI5 and the advanced features such as Adaptive Noise Cancellation performs optimally.

1. Identify the left and right earbud by finding the identification legends located on the inner side on each earbud.
2. Place the earbuds in your ear so that the tips sit comfortably at the opening of the ear canal.
3. Ensure the earbuds are sitting comfortably in the ear. Try another size if they do not fit. Different sized ear tips can be used to ensure the best possible fit.

*Note: To optimize call quality, please ensure the microphone located underneath the earbud is facing outward, see diagram 5*

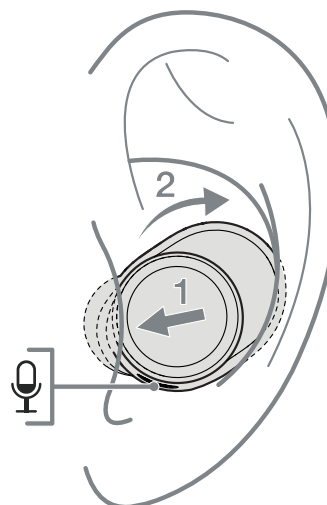
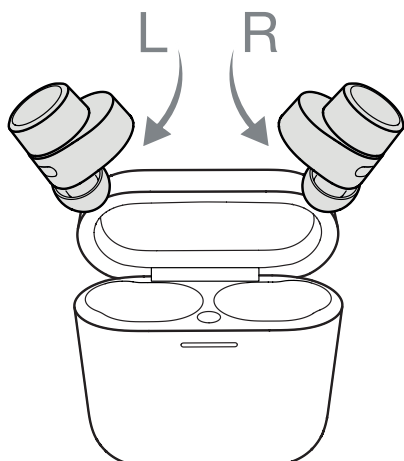

Diagram 5  
Wearing Your Headphones

## 8. Reset/Troubleshooting

### 8.1 Factory Reset

You can clear the paired device history and restore all settings to their defaults.

To factory reset the earbuds, open the charge case with the earbuds placed inside. Press and hold the button on the inside of the charge case for 5 seconds and release. The indicator on the charge case will turn red to indicate the reset.

#### Troubleshooting-

**In the case of earbuds are not functioning properly, please perform a factory reset to resolve the issue.**

### 8.2 Hardware Reset

To hardware reset the earbuds, open the charge case with the earbuds placed inside. Press and hold the button inside the case for 15 seconds until LED indicator goes off and illuminates in green to indicate completion of hardware reset process.

#### Troubleshooting-

**For a serious system crash (Solid LED Red Light), please perform a Hardware Reset to resume the earbuds.**

## 9. Caring For Your Earphones

Your earphones can be cleaned by a damp cloth and gently dabbing until clean. Do not use cleaning detergents, rubbing alcohol, or chemical cleaners/polish, doing so may damage your earphones.

## 10. Service / Support

If you need help troubleshooting a specific problem, or simply have a question you would like answered, please initially consult the Headphone support section of the Bowers & Wilkins website:  
www.bowerswilkins.com.

## 11. Specifications

Technical Features	True Wireless + technology Bluetooth 5.0 with AptX technology ANC Wireless and USB-C charging Fast charging support
Bluetooth Codec	AptX AAC SBC
Bluetooth Profiles	A2DP v1.3.1 AVRCP v1.6.1 HFP v1.7.1 HSP v1.2 BLE GATT (Generic Attribute Profile)
Frequency Band	Tx mode: 2402MHz to 2480MHz, ISM Band, Rx mode: 2402MHz to 2480MHz, ISM Band
RF output power	<10.0 dBm
Bluetooth Codec	AptX AAC SBC
Drive Units	9.2mm Dynamic Drive
Frequency Range	10Hz to 20kHz
Input Impedance	-
Distortion (THD)	<0.3% (1kHz/10mW)
Battery Life	Up to 4 hours Bluetooth
Charging	15 minute charge = 2 hrs Bluetooth
Inputs	Bluetooth
Boxed Accessories	20cm USB-C to USB-C cable
Weight	8g for earbuds, 47g for charge case