



roksan.com/atessa-support



# Let's get started

### Dimensions & Material

Dimensions (Inc. Connections)	H76 x W432 x D349 mm
Dimensions (Exc. Connections)	H76 x W432 x D349 mm
Weight	6.1 Kg
Construction	Formed plated steel and bespoke machined anodised aluminium front panel
<b>CD Support</b>	
CD Standards	CD / CD-R
Gapless Playback	Yes
<b>Outputs</b>	
Digital Output	SPDIF coaxial (16bit/44.1kHz)
<b>Power Supply</b>	
Mains input	Mains transformer will self-select for either 100-130 VAC 50/60Hz 210-240 VAC 50/60Hz (Operational down to 90VAC Update to 85VAC after test)
Power Consumption	<0.5W in standby, Full Power: 25W max
<b>Other</b>	
Service / Update	USB mini B connector (software update & service info ONLY)

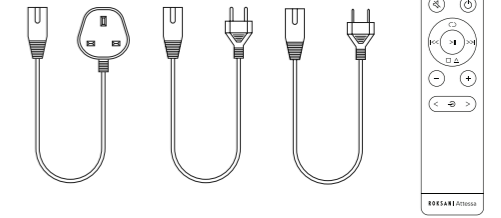
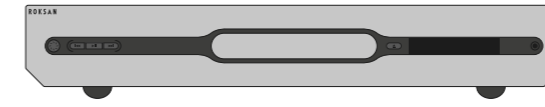
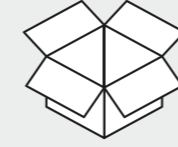

## 1 Place in suitable location

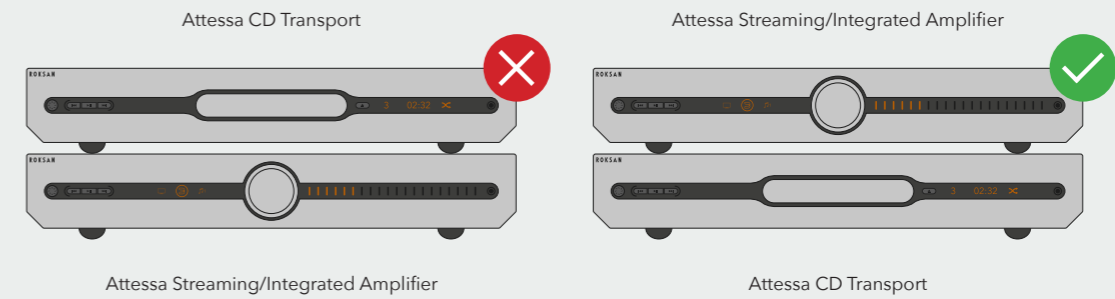

## 2 Connecting to an Amplifier or DAC (Digital Output Only)

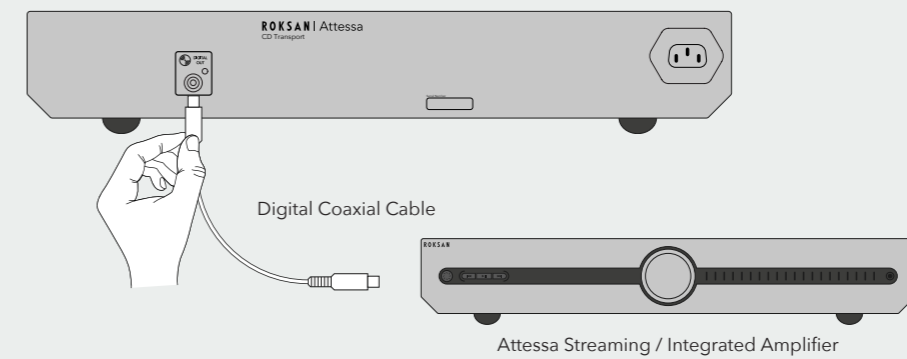

## 3 Power on

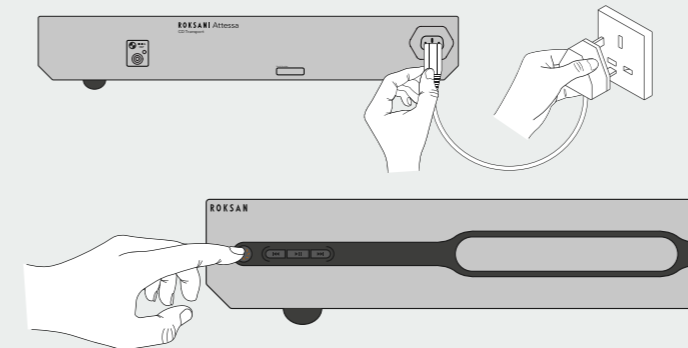

## 4 Download MaestroUnite App

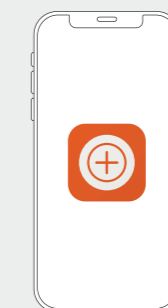

Follow the instructions on the app to finish setting up your product.

Already have MaestroUnite?  
Open the app, select + then follow setup



## Product Overview

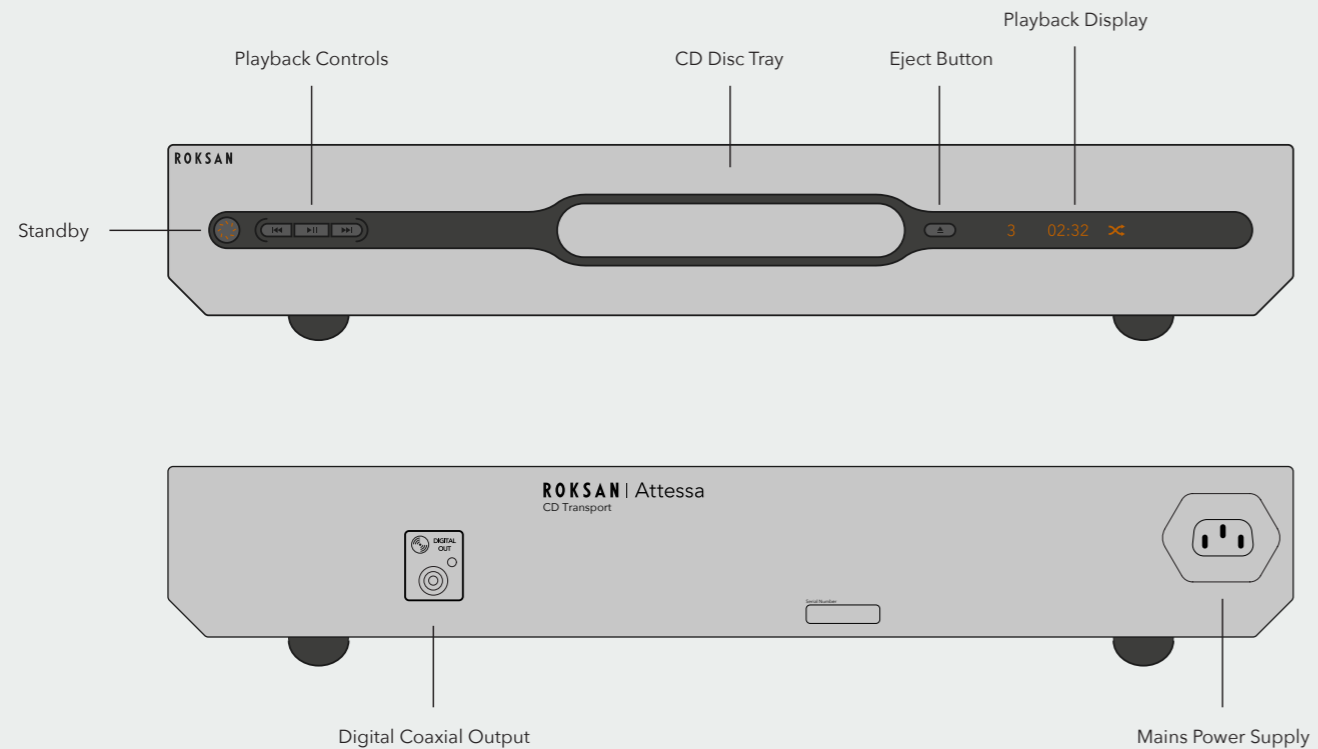

## Display Icons

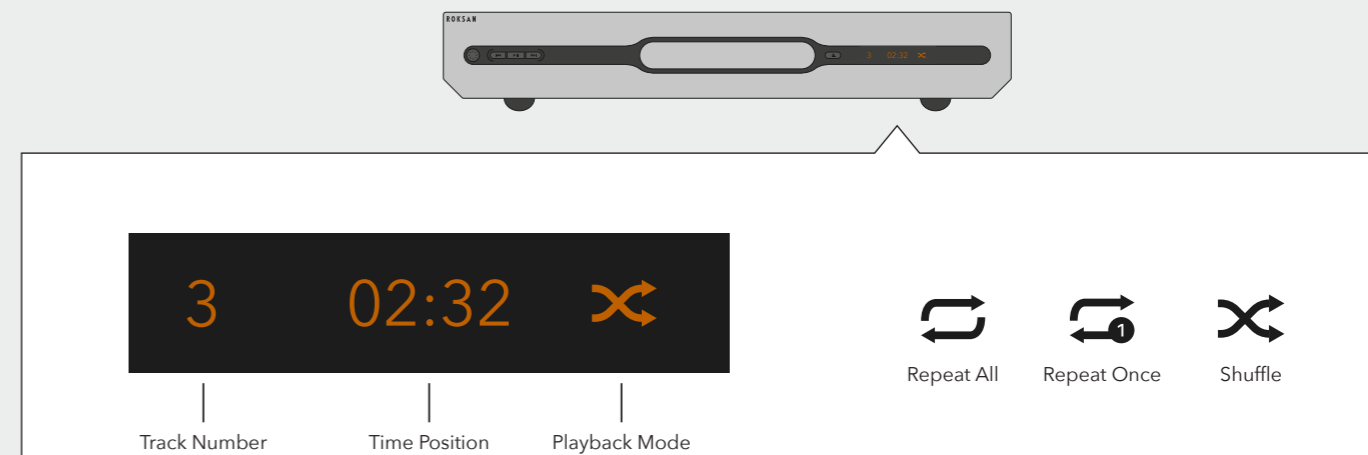

## Using the Remote Control

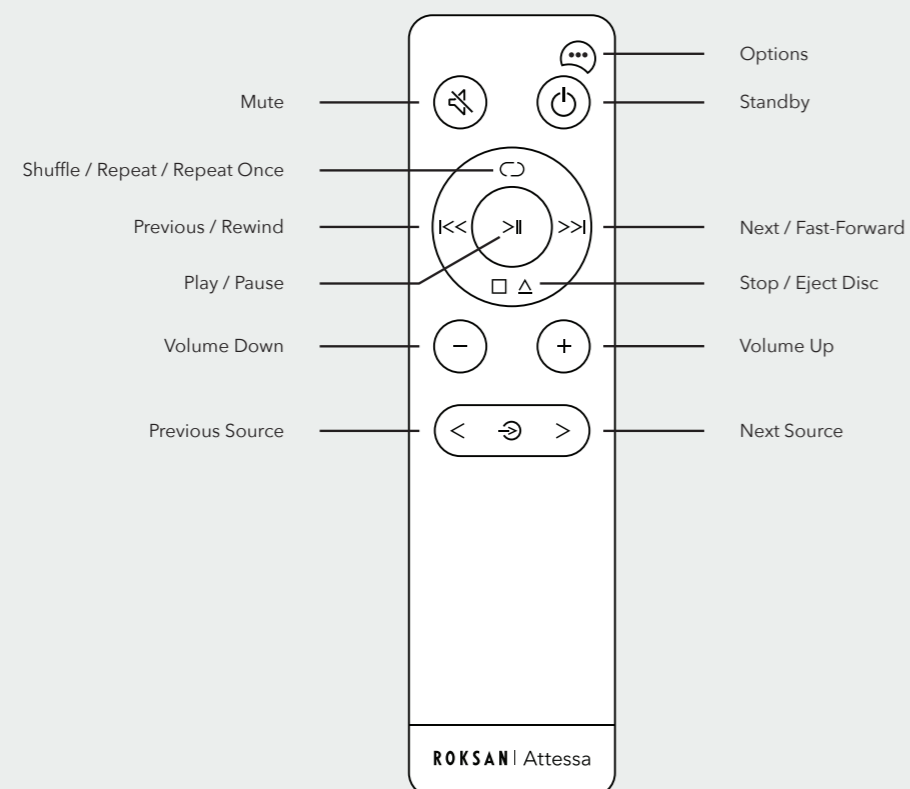

## Opening & Closing Disc Drive

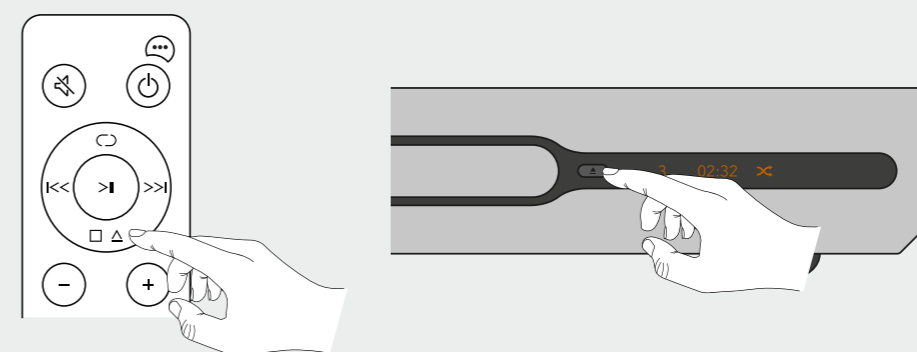

## Inserting CD

