

# BEHRINGER V-TONE GUITAR GDI21

## WELCOME TO BEHRINGER

Thank you for showing your confidence in us by purchasing the V-TONE GUITAR GDI21. This high-quality guitar modeling driver is designed for hands-on musicians and no-frills types. We have rebuilt different circuitries and components from famous amps, and packed them into one housing. You can alternate between several different amp re-creations, gain settings and mic placements with a flick of a switch—intuitively and with minimal effort. In addition, the GDI21 functions as standard ultra-transparent direct injection box when used in bypass mode.

A DI (Direct Injection) box allows you to send a signal directly from an unbalanced, high-impedance output (like an electric guitar) and connect it directly to the balanced mic input of a mixing console.

Whether for stage, recording, rehearsal or warm-up, BEHRINGER's V-TONE GUITAR GDI21 is a natural choice for all players who want an arsenal of different tones.

## CONTROL ELEMENTS

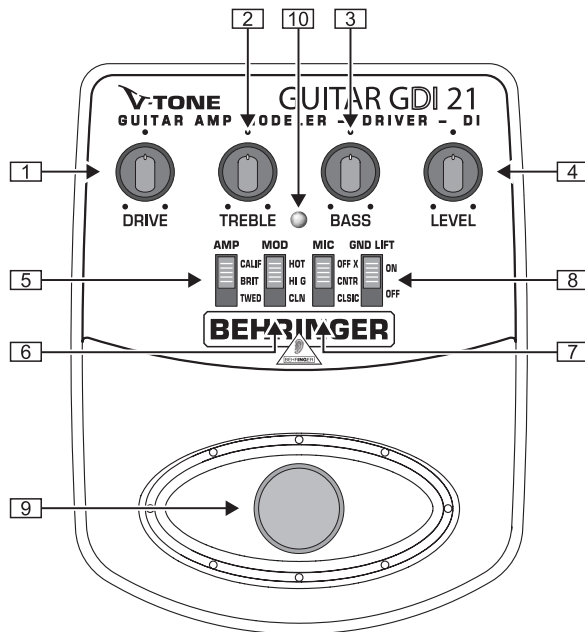

Control elements

- 1 The *DRIVE* control adjusts the overall amount of gain and overdrive, similar to pushing the output section of a tube amp.
- 2 The *TREBLE* control governs the high-frequency range of the signal (+/-12 dB).
- 3 The *BASS* control allows you to boost/cut the low-frequency range (+/-12 dB).
- 4 The *LEVEL* control adjusts the output level of the GDI21.
- 5 Use the *AMP* switch to select one of three great classic tube amps. You will recognize these classic amp tones as soon as you hear them. For crystal-clear, transparent sounds with dynamic bass select TWE(E)D. For aggressive mids and incredible sustain select BRIT(ISH). Rounder and more evened-out (yet still sophisticated) sounds can be dialed up if you select CALIF(ORNIAN); it's perfect for leads.
- 6 Use the *MODE* switch to dial up one of three gain settings (HOT, HI G(AIN), CL(EA)N) that you want to combine with the amp setting.

- 7 The *MIC* switch simulates the microphone placement (orientation and distance) in relation to the cabinet. Select CL(AS)SIC (distant mic placement without ambience) to achieve high mid-range content and a greater definition of notes like with classic early tube amps. In C(E)NT(E)R (close miking at the center of a cone) you get greater high mid-range content and increased low-end for mega crunchy results. OFF (A)X(IS) (close miking at the edge of a cone) is very similar to CENTER, but produces a smoother, softer sound with less upper mid-range content; perfect in combination with MODE position HOT.
- 8 When activated, the *GND LIFT* disconnects the ground connection between input and output. Depending on the grounding of the connected equipment, this can eliminate hum or ground loops.
- 9 Use the footswitch to activate/deactivate all the tone functions (EQ, DRIVE, modeling). When deactivated, the GDI21 functions solely as a standard transparent DI box.
- 10 This LED illuminates when the effect is activated (see 9).

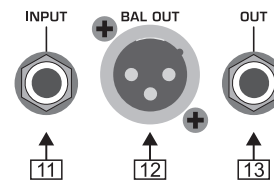

Connectors

- 11 Use this 1/4" TS *INPUT* connector to plug in the instrument cable of your guitar or other instruments.
- 12 *BAL OUT* is the GDI21's balanced mic level output. Use a high-quality, balanced XLR (microphone) cable to connect the driver to a mixing console.
- 13 The unbalanced 1/4" TS *OUT* connector sends the signal to your guitar amp.

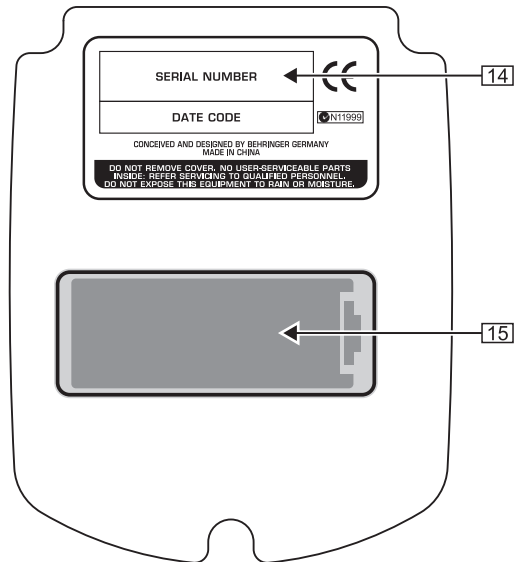

Bottom of the GDI21

- 14 *SERIAL NUMBER*. The serial number of the GDI21 is located on the bottom.
  - 15 *BATTERY COMPARTMENT*. Open the lid to install or replace the 9 V battery (see also chapter "POWER REQUIREMENTS").
- 👉 The GDI21 is powered as soon you insert a plug into the INPUT. The battery is "disconnected" when the plug is removed. For this reason, the GDI21 has no on/off switch. To prolong battery life, always disconnect the input when the driver is not in use.

# BEHRINGER V-TONE GUITAR GDI21

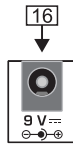

Power supply connector

- 16** Use the DC IN connection to plug in a 9 V power supply (not included). For details please refer to chapter "POWER REQUIREMENTS."

## APPLICATIONS

### Use with other instruments

The GDI21 is not only for electric guitars. You can try it with other instruments (e. g. acoustic/bass guitars, keyboards etc.) to create new sounds and enhance your music. Please make sure that the input level is not too high to avoid overloading the GDI21.

### Direct to a mixing console

For live and studio applications you can connect the balanced XLR BAL OUT directly to a mic input of a mixing console. Be sure not to overload the input by using the gain control of the respective channel. For further information please refer to the user's manual of your mixing console.

### Use without instruments

You can use the GDI21 without an instrument as an outboard processor connected to an insert or an effect path (aux send/return) of your mixing console to affect the signal of a particular channel. This way you can enhance existing tracks during mixdown. For further information please refer to the user's manual of your mixing console.

## POWER REQUIREMENTS

### Battery:

Utilizes standard 9 V alkaline battery (not included).  
Power consumption: approx. 25 mA

### Power supply:

**ATTENTION: PLEASE USE DC POWER SUPPLY ONLY!**  
Failure to do so may damage the unit and void the warranty.

DC Power Supply Specifications:  
- 9 V DC (regulated), 50 mA minimum  
- 2 mm female plug, center negative (-)

## WARRANTY

For our current warranty terms, please refer to our website at <http://www.behringer.com>.

## SPECIFICATIONS

### Input

Connector 1/4" TS  
Impedance 1 M $\Omega$

### Output

Connector 1/4" TS  
Impedance 1 k $\Omega$

### Balanced output

Connector XLR  
Impedance 200  $\Omega$

Power supply 9 V, >50 mA DC regulated  
Power connector 2 mm DC jack, negative center  
Battery 9 V type 6LR61

Power consumption 25 mA  
Dimensions approx. 5" (127 mm) x 3 9/10" (100 mm) x 2" (50 mm)

Weight approx. 460 g

BEHRINGER is constantly striving to maintain the highest professional standards. As a result of these efforts, modifications may be made from time to time to existing products without prior notice. Specifications and appearance may differ from those listed or illustrated.

## SAMPLE SETTINGS

### BOOGIE® ORIGINAL STYLE

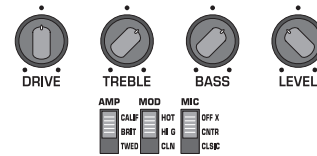

### MARSHALL® PLEXI STYLE

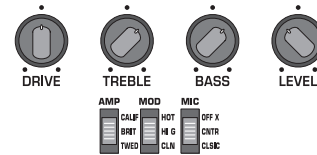

### MARSHALL® BLUESBREAKER STYLE

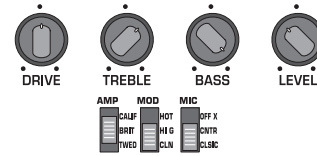

### FUNK STYLE

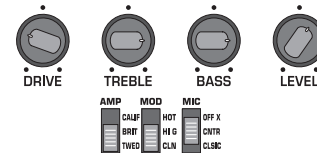

### KILLER METAL STYLE

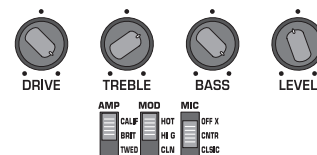

### SLAP BASS

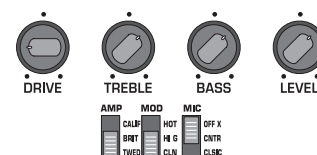

Technical specifications and appearance subject to change without notice. The information contained herein is correct at the time of printing. The names of companies, institutions or publications pictured or mentioned and their respective logos are registered trademarks of their respective owners. Their use neither constitutes a claim of the trademarks by BEHRINGER® nor affiliation of the trademark owners with BEHRINGER®. Any mention of samples settings by commercial organizations or reference to commercial organizations is for information only. It does not imply any affiliation of BEHRINGER with the samples settings mentioned nor does it imply recommendation or endorsement by BEHRINGER nor does it imply that the samples settings mentioned are necessarily the best available for the purpose. BEHRINGER® accepts no liability for any loss which may be suffered by any person who relies either wholly or in part upon any description, photograph or statement contained herein. Colours and specification may vary slightly from product. Products are sold through our authorised dealers only. Distributors and dealers are not agents of BEHRINGER® and have absolutely no authority to bind BEHRINGER® by any express or implied undertaking or representation. No part of this manual may be reproduced or transmitted in any form or by any means, electronic or mechanical, including photocopying and recording of any kind, for any purpose, without the express written permission of BEHRINGER Spezielle Studiotechnik GmbH. BEHRINGER® is a registered trademark.

ALL RIGHTS RESERVED.  
© 2004 BEHRINGER Spezielle Studiotechnik GmbH,  
Hanns-Martin-Schleyer-Str. 36-38,  
47877 Willich-Münchheide II, Germany.  
Tel. +49 2154 9206 0, Fax +49 2154 9206 4903